

102 Tylers Ride

South Woodham Ferrers, Chelmsford, Essex, CM3 5ZT



PRICE: £140,000

Lease: 125 years from 2005

Property Description:

A ONE BEDROOM RETIREMENT APARTMENT SITUATED ON THE SECOND FLOOR Tylers Ride was built by McCarthy and Stone and consists of 42 properties and is set within the heart of South Woodham Ferrers with its shops and Amenities. Please speak to our Property Consultant if you require information regarding Event Fees that may apply to this property.

Two Residents' Lounges & One Guest Suite
Communal Laundry facilities
24 hour emergency call system
Security door entry system
Parking for cars and mobility scooters
(limited availability)

Lift to all floors
Residential Development Manager
Minimum Age 60
Lease: 125 years from 2005

Interior
photos
to follow.



**For more details or to make an appointment to view, please contact
Mandy Abbott**

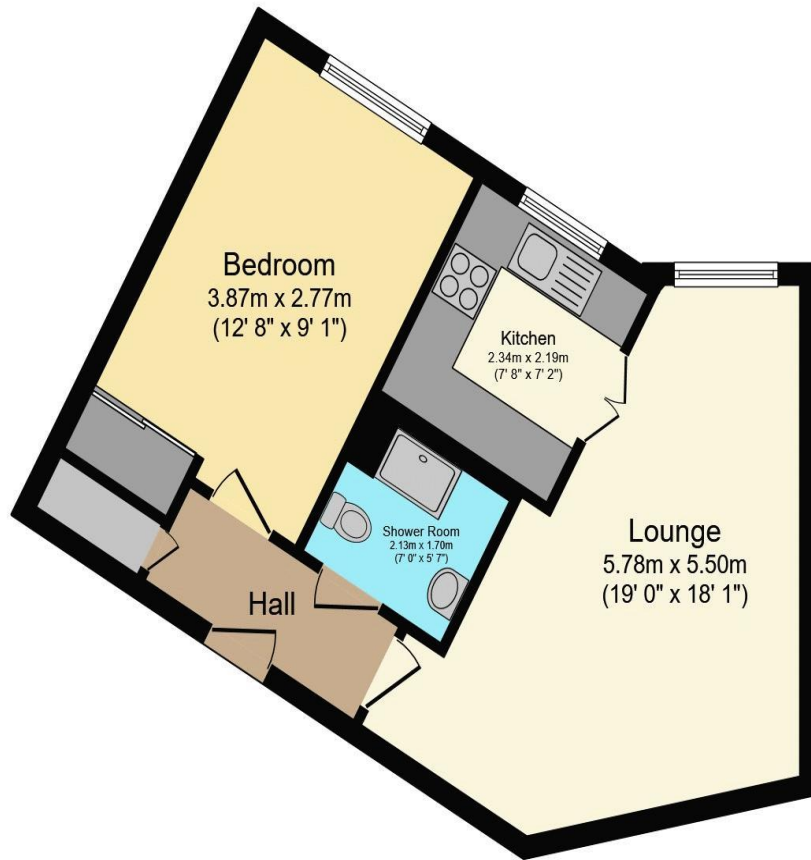

Total floor area 42.7 m² (459 sq.ft.) approx

This floor plan is for illustrative purposes only. It is not drawn to scale. Any measurements, floor areas (including any total floor area), openings and orientation are approximate. No details are guaranteed, they cannot be relied upon for any purpose and they do not form part of any agreement. No liability is taken for any error, omission or misstatement. A party must rely upon its own inspection(s).
Powered by www.focalagent.com

Energy Efficiency Rating		Current	Potential
Very energy efficient - lower running costs			
(92-100) A			
(81-91) B		86	87
(69-80) C			
(55-68) D			
(39-54) E			
(21-38) F			
(1-20) G			
Not energy efficient - higher running costs			
England, Scotland & Wales		EU Directive 2002/91/EC	

For Financial Year Ending:

30//04/25

Annual Ground Rent:

£400.00

Ground Rent Period Review:

TBC

Annual Service Charge:

£3232.42

Council Tax Band:

B

Event Fees:

**2.5% Transfer
0% Contingency**

Retirement Homesearch, Queensway House, 11 Queensway, New Milton, Hampshire, BH25 5NR
T: 0333 321 4060 F: 0333 321 4065 E: enquiries@retirementhomesearch.co.uk

Retirement Homesearch Limited, Registered Office:
Queensway House, 11 Queensway, New Milton, Hampshire, BH25 5NR
Registered in England No. 3829469



These sales particulars have been prepared as a guide only and any intended purchasers must satisfy themselves by inspection or otherwise as to the correctness of the statements contained therein. The management company have not tested any apparatus, equipment, fittings or services and so cannot verify that they are in working order.