

12 Gaskell Court (A)

Thornton End, Alton, Hampshire, GU34 4HF



PRICE: £100,000

Lease: 99 years from 1984

Property Description:

A ONE BEDROOM RETIREMENT APARTMENT LOCATED ON THE FIRST FLOOR

This property was constructed by Anchor in 1986 and is still Managed by the same company. The Development is laid out over 2 floors. It is a short bus ride into Alton Town Centre, which also has a train station. The Estate Manager can be accessed from various points within each property. For periods where the Estate manager is off duty, there is a 24 hour emergency call system. Each property comprises an entrance hall, lounge, kitchen 1 or 2 bedrooms and bathroom. It is a condition of purchase that residents must be over 60 years.

- 24 hour emergency call system
- Live-in Estate Manager
- Minimum Age 60
- Lease: 99 years from 1984
- Service Charge £300.22pcm
- Ground Rent £N/A



**For more details or to make an appointment to view, please contact
Miss Kalise Bucknell MNAEA**

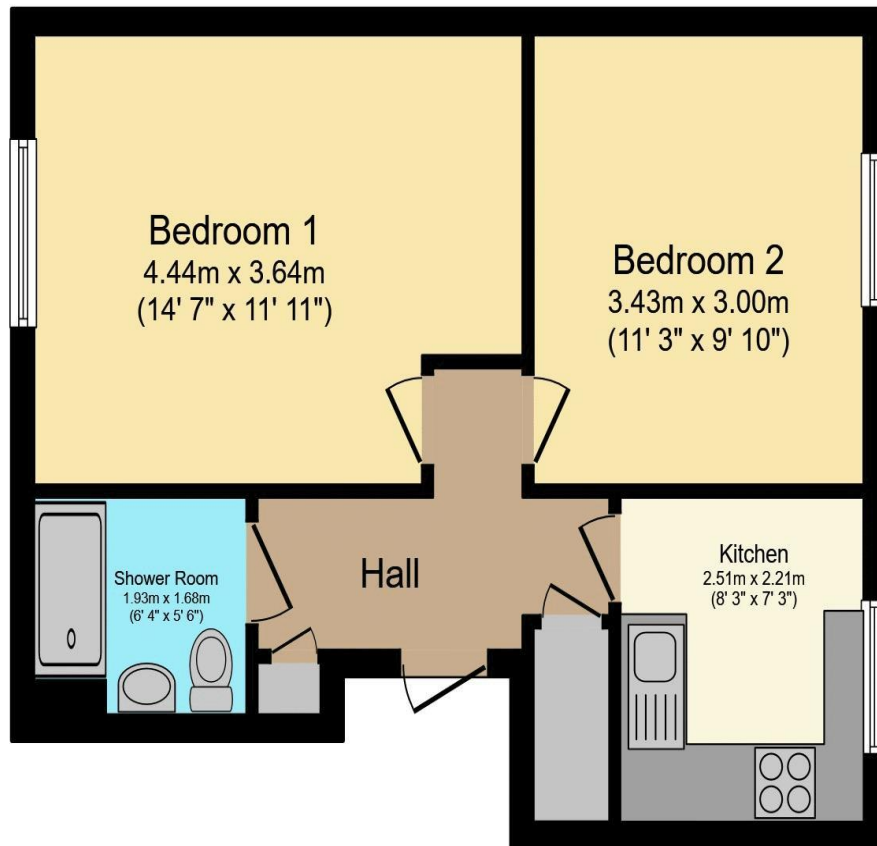

Total floor area 41.2 sq.m. (443 sq.ft.) approx

This floor plan is for illustrative purposes only. It is not drawn to scale. Any measurements, floor areas (including any total floor area), openings and orientation are approximate. No details are guaranteed, they cannot be relied upon for any purpose and they do not form part of any agreement. No liability is taken for any error, omission or misstatement. A party must rely upon its own inspection(s).
Powered by www.focalagent.com

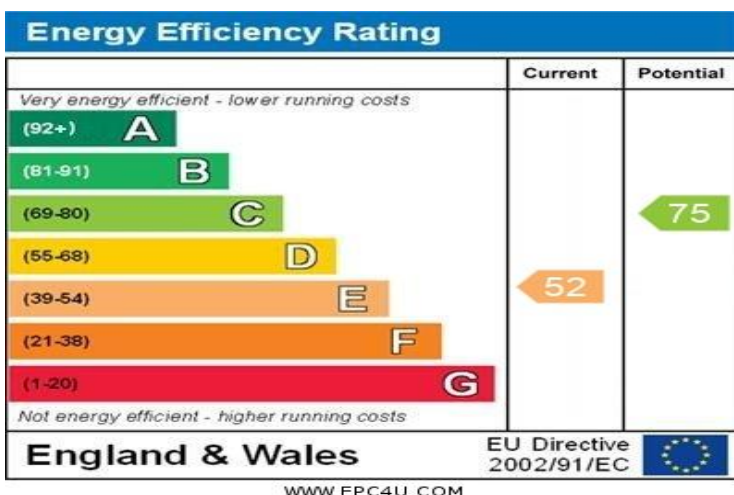

For Financial Year Ending:

31/03/25

Annual Ground Rent:

£N/A

Ground Rent Period Review:

N/A

Annual Service Charge:

£300.22pcm

Council Tax Band:

B

Event Fees:

ASK AGENT Transfer
ASK AGENT Contingency

Retirement Homesearch, Queensway House, 11 Queensway, New Milton, Hampshire, BH25 5NR
T: 0333 321 4060 F: 0333 321 4065 E: enquiries@retirementhomesearch.co.uk

Retirement Homesearch Limited, Registered Office:
Queensway House, 11 Queensway, New Milton, Hampshire, BH25 5NR
Registered in England No. 3829469



These sales particulars have been prepared as a guide only and any intended purchasers must satisfy themselves by inspection or otherwise as to the correctness of the statements contained therein. The management company have not tested any apparatus, equipment, fittings or services and so cannot verify that they are in working order.