

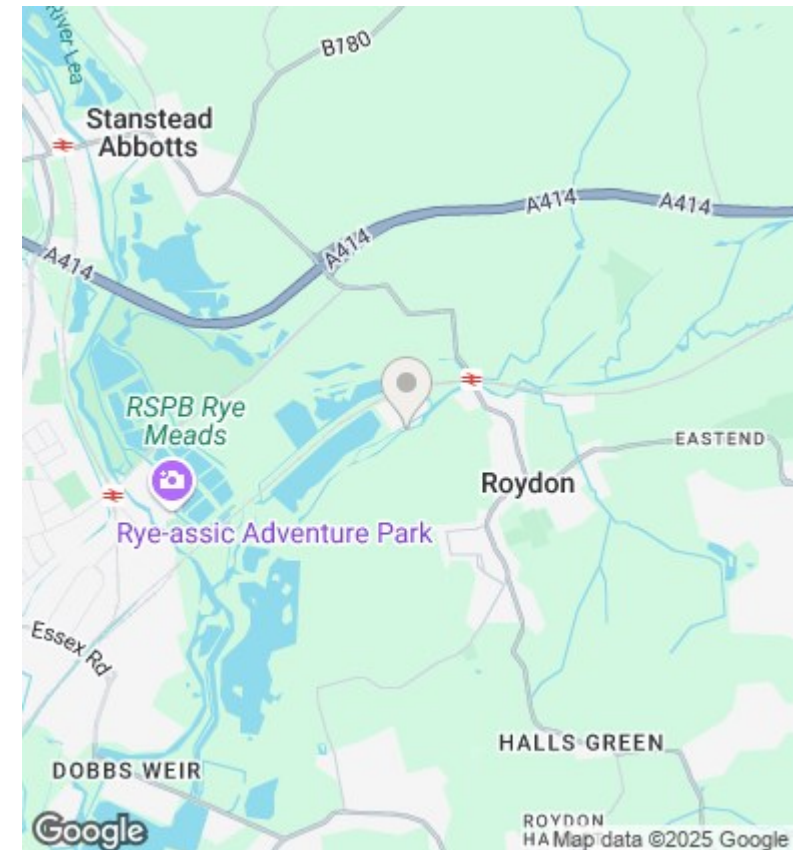

2 Roydon Mill, Roydon, Essex, CM19 5EJ

Asking Price £275,000

- MAISONETTE WITH OWN ENTRANCE
- CLOSE TO STATION
- COOMUNAL GARDEN AREA
- GROUND FLOOR
- PARKING
- DOUBLE BEDROOMS
- GARAGE

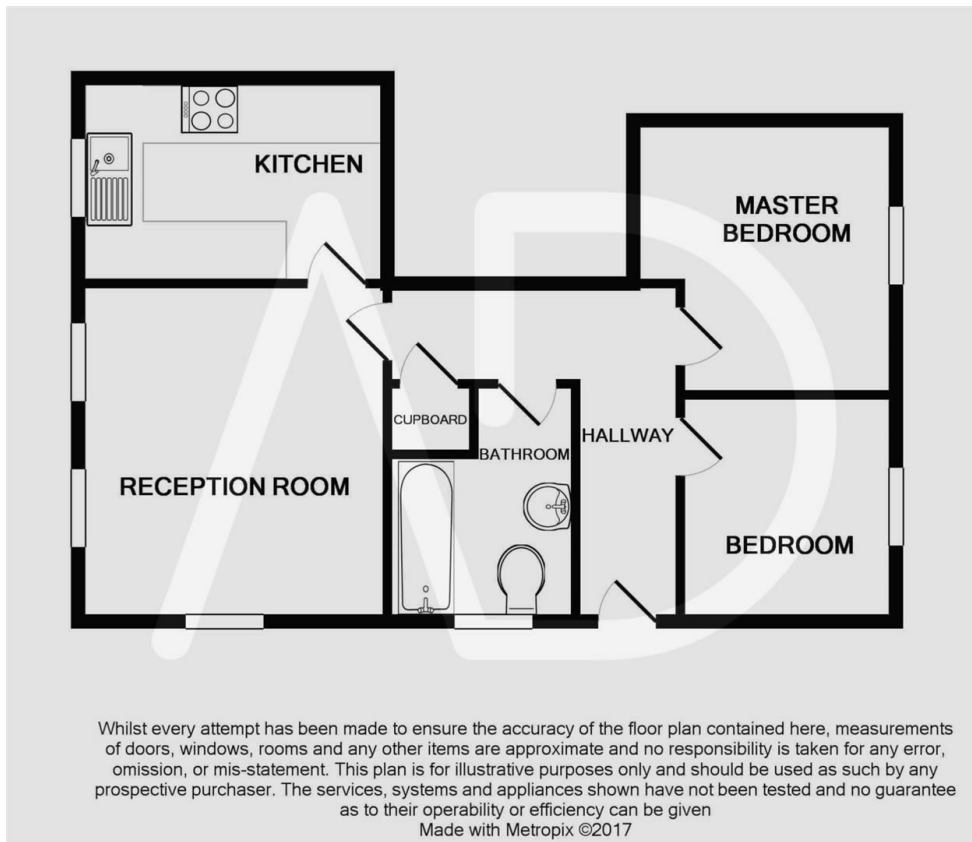

Directions

Viewings

Viewings by arrangement only. Call 01992 470335 to make an appointment.

Council Tax Band

B

EPC Rating:

E

Energy Efficiency Rating		
	Current	Potential
Very energy efficient - lower running costs		
(92 plus) A		
(81-91) B		
(69-80) C		
(55-68) D		
(39-54) E	45	59
(21-38) F		
(1-20) G		
Not energy efficient - higher running costs		
England & Wales		EU Directive 2002/91/EC