

17 Rye Road, Hoddesdon, EN11 0JD

Asking Price £299,995

- Two Bedroom Ground Floor Apartment
- Share of Freehold
- Available For Viewings
- Modern Throughout
- Being Sold Chain Free
- Walk Distance to Rye House Station
- Spacious Bedrooms
- Fully Fitted Kitchen

Approximate Gross Internal Area 890 sq ft - 83 sq m

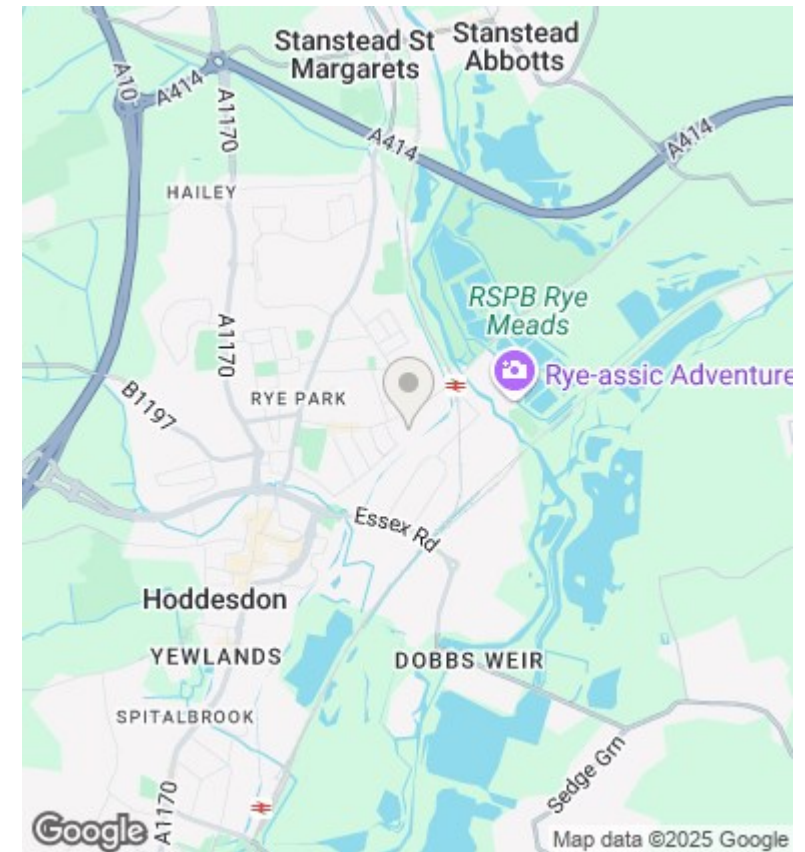
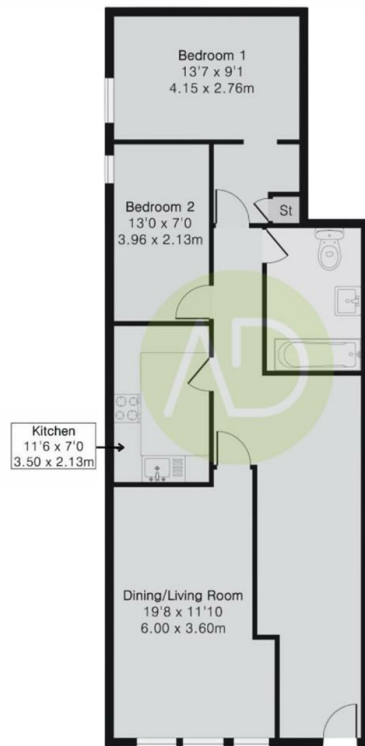

Directions

Viewings

Viewings by arrangement only. Call 01992 470335 to make an appointment.

Council Tax Band

EPC Rating:

Energy Efficiency Rating		
	Current	Potential
Very energy efficient - lower running costs		
(92 plus) A		
(81-91) B		
(69-80) C		
(55-68) D		
(39-54) E		
(21-38) F		
(1-20) G		
Not energy efficient - higher running costs		
England & Wales	EU Directive 2002/91/EC	