

## 17 Rye Road, Hoddesdon, EN11 0JD

Asking Price £299,995

- Two Bedroom Ground Floor Apartment
- Share of Freehold
- Available For Viewings
- Modern Throughout
- Being Sold Chain Free
- Walk Distance to Rye House Station
- Spacious Bedrooms
- Fully Fitted Kitchen

Approximate Gross Internal Area 890 sq ft - 83 sq m

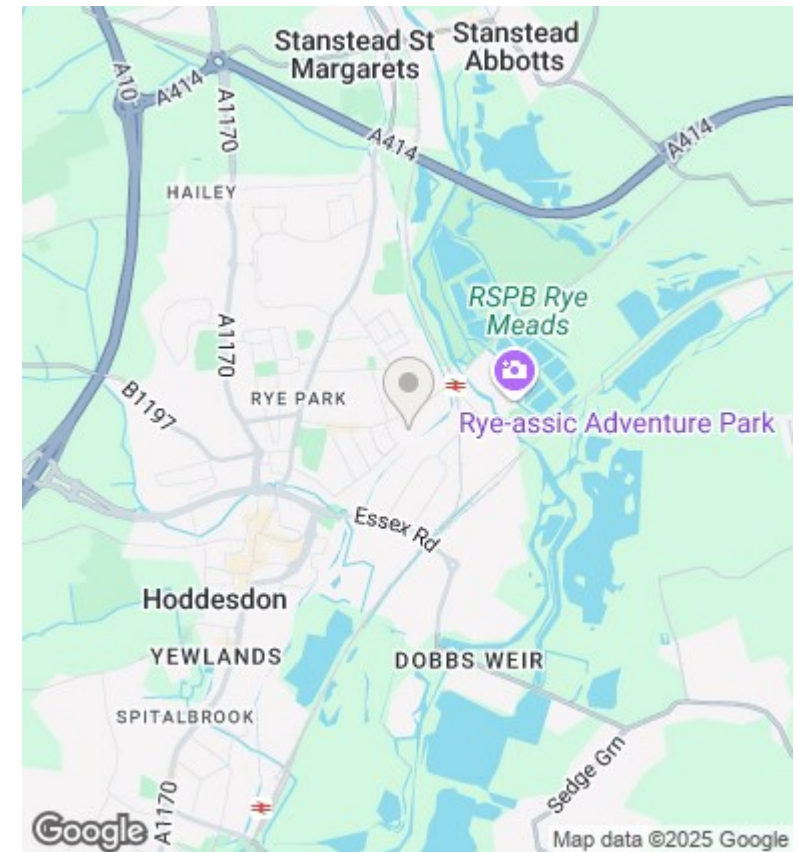
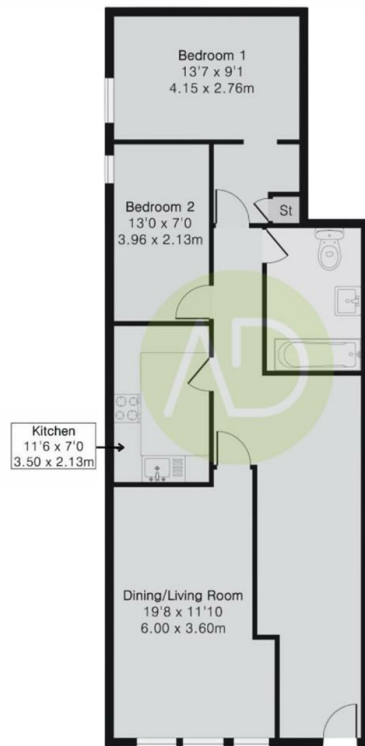

## Directions

## Viewings

Viewings by arrangement only. Call 01992 470335 to make an appointment.

## Council Tax Band

## EPC Rating:

Energy Efficiency Rating		
	Current	Potential
Very energy efficient - lower running costs		
(92 plus) <b>A</b>		
(81-91) <b>B</b>		
(69-80) <b>C</b>		
(55-68) <b>D</b>		
(39-54) <b>E</b>		
(21-38) <b>F</b>		
(1-20) <b>G</b>		
Not energy efficient - higher running costs		
<b>England &amp; Wales</b>	EU Directive 2002/91/EC	