

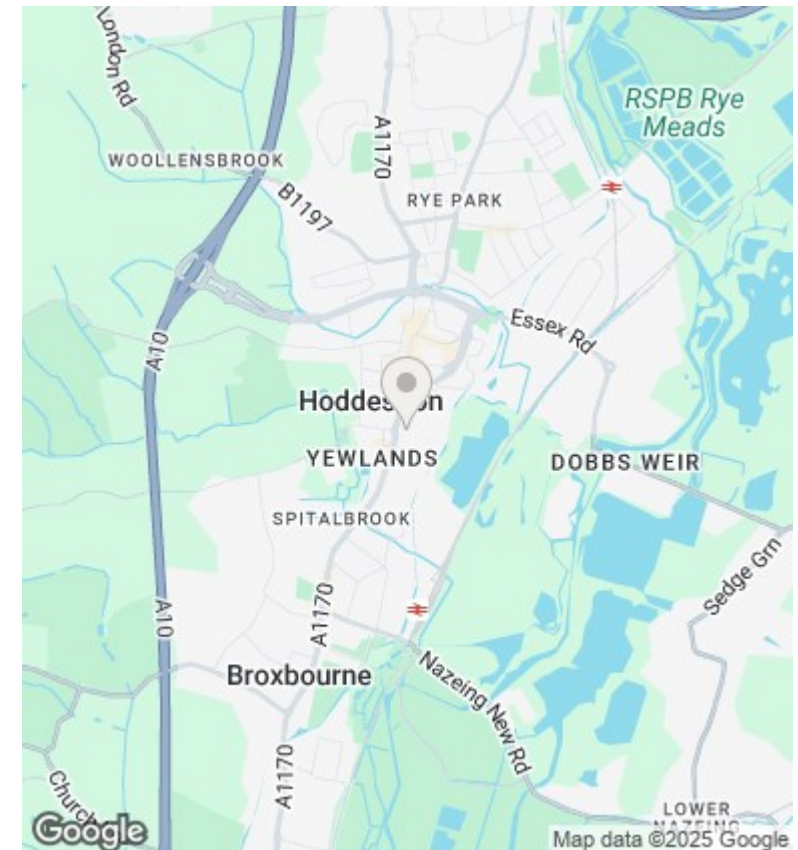

35 Woodgrange Court, Hoddesdon, Herts, EN11 8DQ

Asking Price £195,000

- 1 BEDROOM APARTMENT CLOSE TOWN CENTRE
- PARKING UNDERGROUND
- BRAD NEW KITCHEN
- BRAND NEW BATHROOM
- NEWLY DECORATED THROUGHOUT
- BRAND NEW CARPETS
- BRAND NEW HEATING

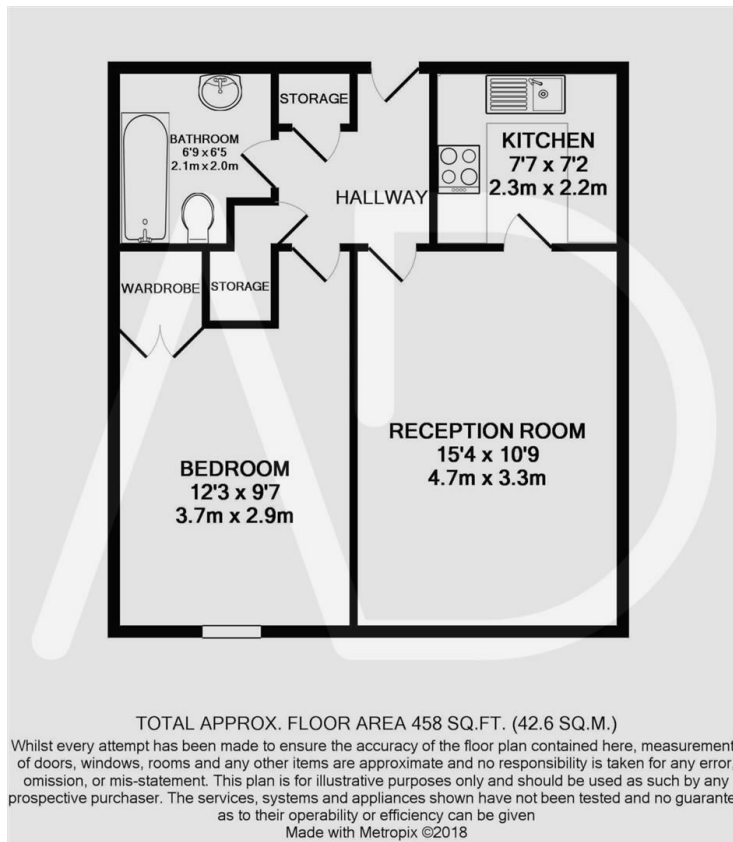

Directions

Viewings

Viewings by arrangement only. Call 01992 470335 to make an appointment.

Council Tax Band

B

EPC Rating:

E

Energy Efficiency Rating		
	Current	Potential
Very energy efficient - lower running costs		
(92 plus) A		
(81-91) B		81
(69-80) C		
(55-68) D	51	
(39-54) E		
(21-38) F		
(1-20) G		
Not energy efficient - higher running costs		
England & Wales	EU Directive 2002/91/EC	