

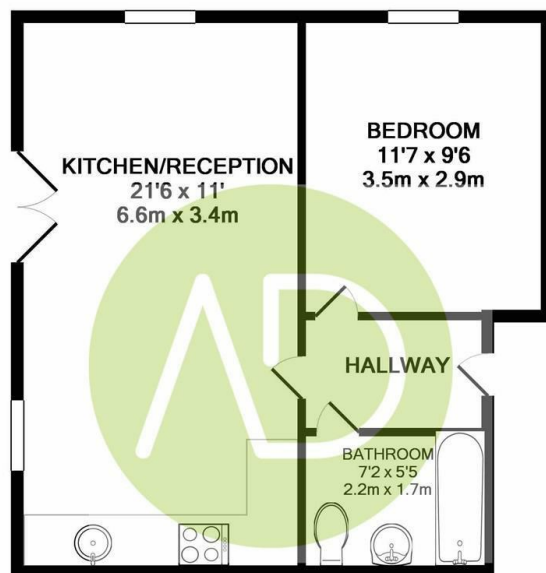

1 Rye Court, Cranborne Road, Hoddesdon, EN11 0FE

Asking Price £220,000

- GROUND FLOOR APARTMENT
- WHITE GOODS INCLUDE
- DOUBLE BEDROOM
- WALKING DISTANCE TO RYE HOUSE STATION
- SPACIOUS LIVING ROOM
- CLOSE TO LOCAL AMMENTIES



TOTAL APPROX. FLOOR AREA 418 SQ.FT. (38.8 SQ.M.)

Whilst every attempt has been made to ensure the accuracy of the floor plan contained here, measurements of doors, windows, rooms and any other items are approximate and no responsibility is taken for any error, omission, or mis-statement. This plan is for illustrative purposes only and should be used as such by any prospective purchaser. The services, systems and appliances shown have not been tested and no guarantee as to their operability or efficiency can be given
Made with Metropix ©2018

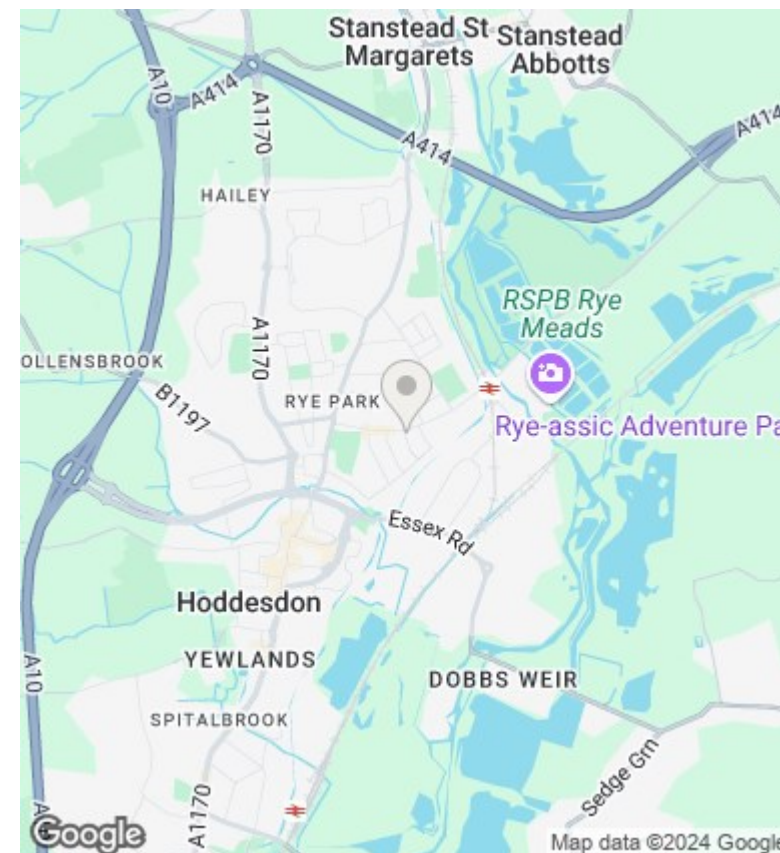

Directions

Viewings

Viewings by arrangement only. Call 01992 470335 to make an appointment.

Council Tax Band

EPC Rating:

C

Energy Efficiency Rating		
	Current	Potential
Very energy efficient - lower running costs		
(92 plus) A		
(81-91) B	79	79
(69-80) C		
(55-68) D		
(39-54) E		
(21-38) F		
(1-20) G		
Not energy efficient - higher running costs		
England & Wales	EU Directive 2002/91/EC	