



Winnipeg Way, Broxbourne

- Superb Two Bedroom Apartment
- Fully Integrated Modern Kitchen
- Allocated & Visitor Parking

- Ground Floor with Small Outside Space
- Master Bedroom with Fitted Wardrobes
- Close to Brookfield Farm Shopping Centre

£TBC

- Popular Development
- Modern En Suite & Bathroom

Winnipeg Way, Broxbourne, EN10 6GF

ANTHONY DAVIES bring to market a beautifully presented two bedroom, two bathroom ground floor apartment situated on the popular Canada Fields Development. The flat underwent full refurbishment 3 years ago with accommodation featuring a full integrated modern kitchen, spacious lounge/diner with French doors opening onto small outside space, master bedroom with fitted wardrobes & ensuite, modern bathroom, allocated parking and within easy access to A10/M25 & Brookfield Farm Shopping Centre.

Book your viewing today.





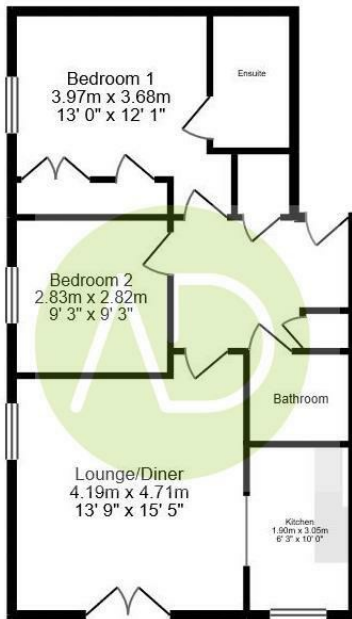

Whilst every attempt has been made to ensure the accuracy of the floor plan contained here, measurements of doors, windows, rooms and any other items are approximate and no responsibility is taken for any error, omission, or misstatement. This plan is for illustrative purposes only and should be used as such for any prospective purchaser. The services, systems and appliances shown have not been tested and no guarantee as to their operability or efficiency can be given.

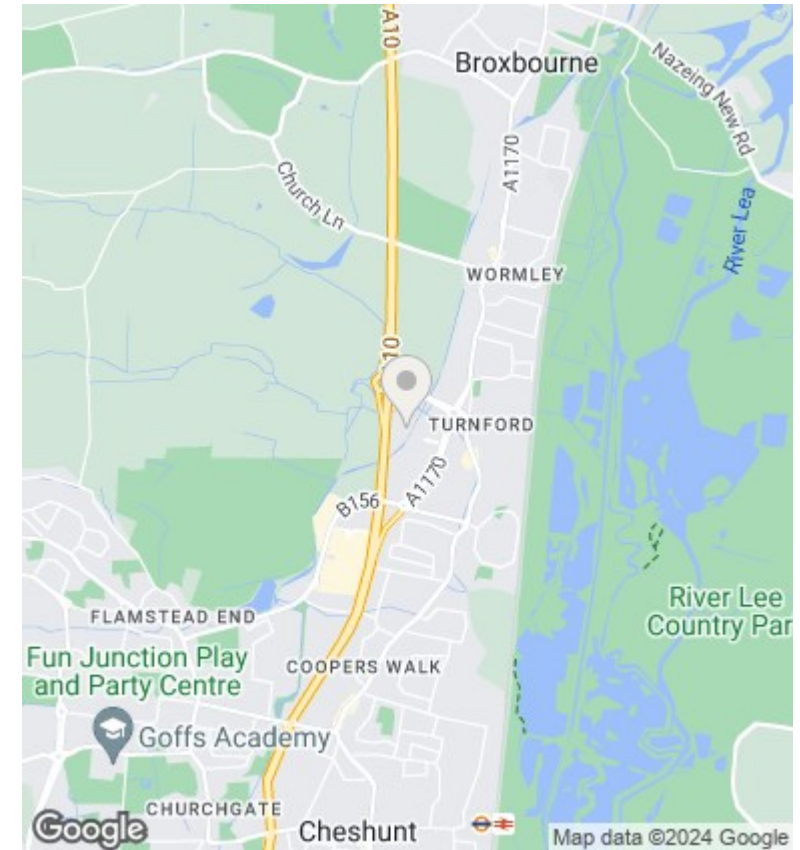

Viewings by arrangement only.
 Call 01992 470335 to make an appointment.

Energy Efficiency Rating		
	Current	Potential
<i>Very energy efficient - lower running costs</i>		
(92 plus) A		
(81-91) B		
(69-80) C	76	
(55-68) D		
(39-54) E		
(21-38) F		
(1-20) G		
<i>Not energy efficient - higher running costs</i>		
England & Wales	EU Directive 2002/91/EC	