

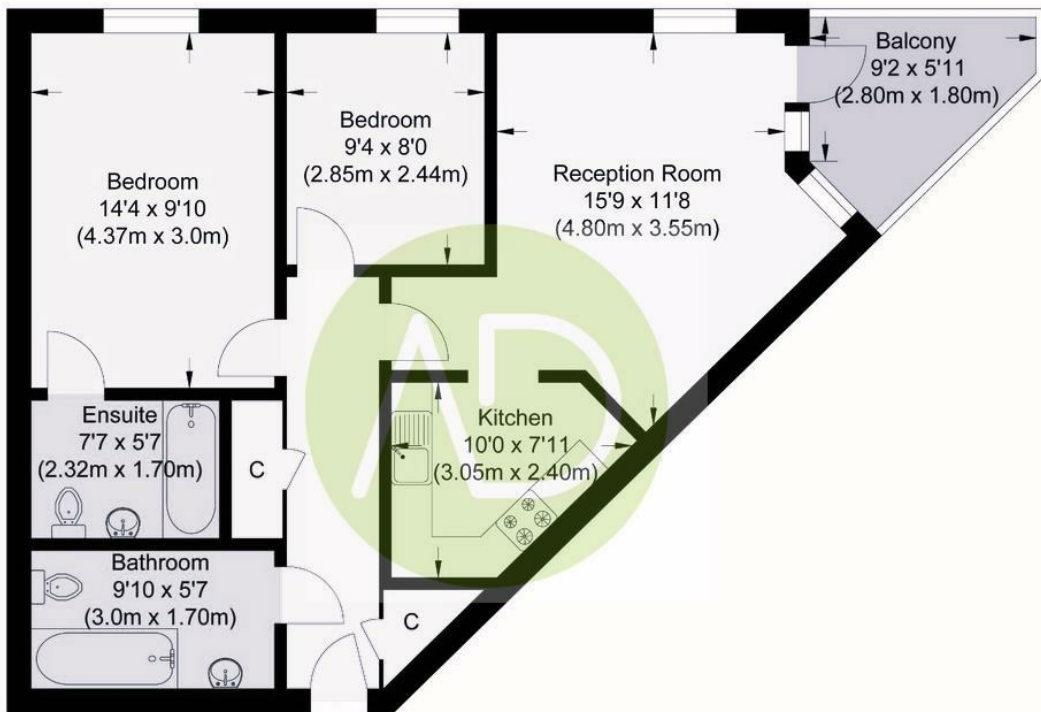

## 147 Plomer Avenue, Hoddesdon, EN11 9FQ

Asking Price £235,000

- Spacious Two Bedroom Apartment
- Top Floor with Loft
- Ample Residents Parking
- Close to Town Centre
- Popular Development
- Chain Free
- Private Balcony
- Two Bathrooms



Approximate Gross Internal Floor Area : 63.60 sq m / 684.58 sq ft  
 Illustration for identification purposes only, measurements are approximate, not to scale.

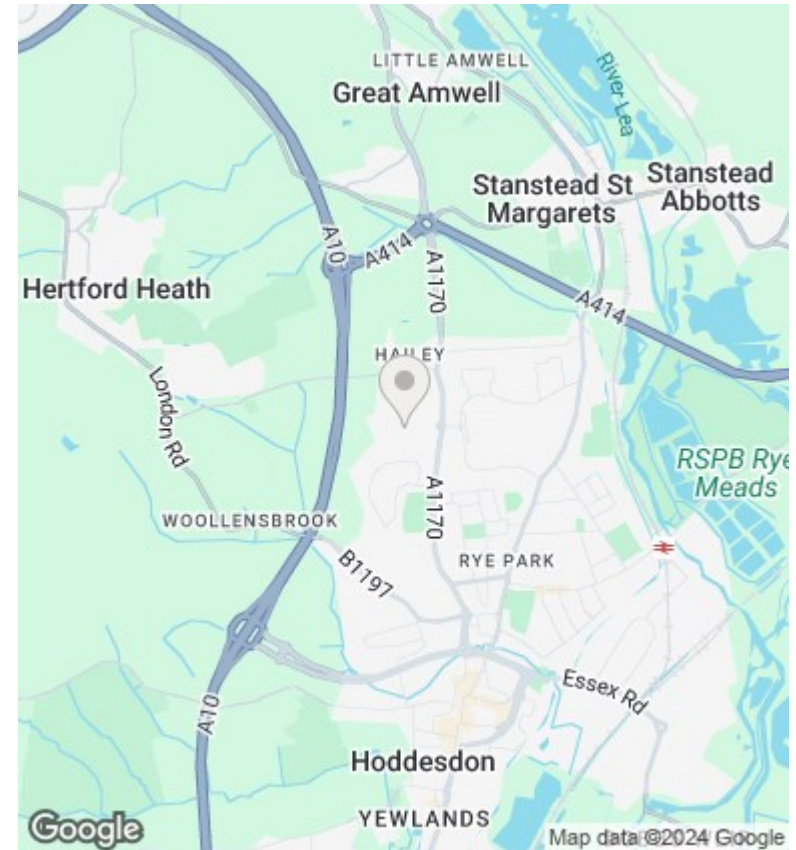

### Directions

### Viewings

Viewings by arrangement only. Call 01992 470335 to make an appointment.

### Council Tax Band

### EPC Rating:

Energy Efficiency Rating		
	Current	Potential
<i>Very energy efficient - lower running costs</i>		
(92 plus) <b>A</b>		
(81-91) <b>B</b>		
(69-80) <b>C</b>		
(55-68) <b>D</b>		
(39-54) <b>E</b>		
(21-38) <b>F</b>		
(1-20) <b>G</b>		
<i>Not energy efficient - higher running costs</i>		
<b>England &amp; Wales</b>	EU Directive 2002/91/EC	