

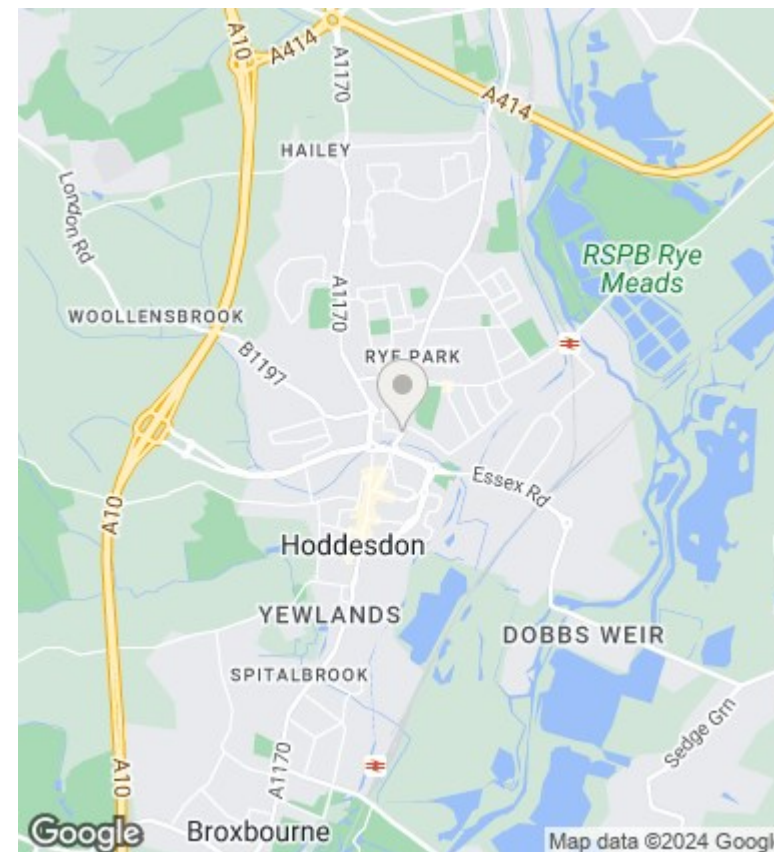

80 Burford Street, Hoddesdon, EN11 8JL

£370,000

- Link Detached Family Home
- Modern Kitchen
- Garage
- Three Good Sized Bedrooms
- Ground Floor Bathroom
- Chain Free
- Spacious Lounge and Dining Room
- Low Maintenance Rear Garden

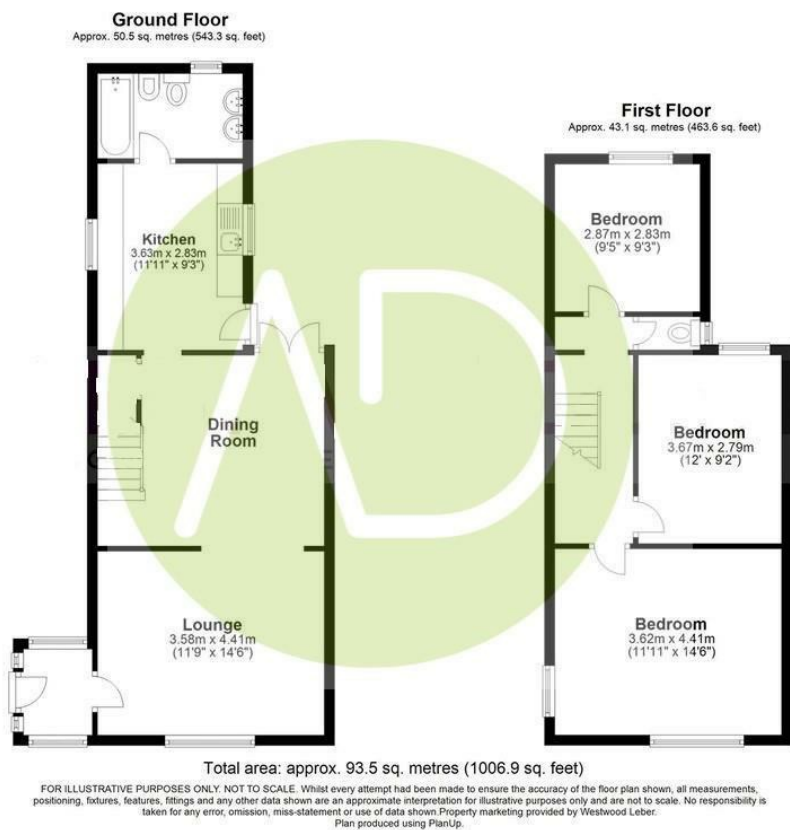

Directions

Viewings

Viewings by arrangement only. Call 01992 470335 to make an appointment.

Council Tax Band

EPC Rating:

E

Energy Efficiency Rating		Current	Potential
<i>Very energy efficient - lower running costs</i>			
(92 plus)	A		
(81-91)	B		
(69-80)	C		
(55-68)	D		
(39-54)	E	48	
(21-38)	F		
(1-20)	G		
<i>Not energy efficient - higher running costs</i>			
England & Wales		EU Directive 2002/91/EC	