

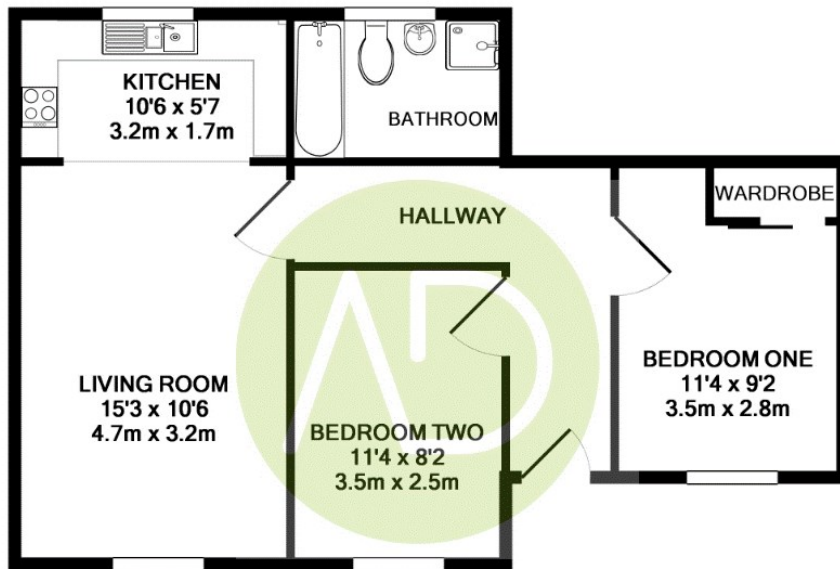

## 18 Marston Road, Hoddesdon, EN11 0AD

£290,000

- Modern Two Bedroom Apartment
- Quiet Cul de Sac
- Gas Central Heating
- Ground Floor
- Re-fitted Kitchen
- Allocated Parking
- Close to Train Station & Town Centre
- Luxury Bathroom



TOTAL APPROX. FLOOR AREA 542 SQ.FT. (50.4 SQ.M.)

Whilst every attempt has been made to ensure the accuracy of the floor plan contained here, measurements of doors, windows, rooms and any other items are approximate and no responsibility is taken for any error, omission, or mis-statement. This plan is for illustrative purposes only and should be used as such by any prospective purchaser. The services, systems and appliances shown have not been tested and no guarantee as to their operability or efficiency can be given  
 Made with Metropix ©2017

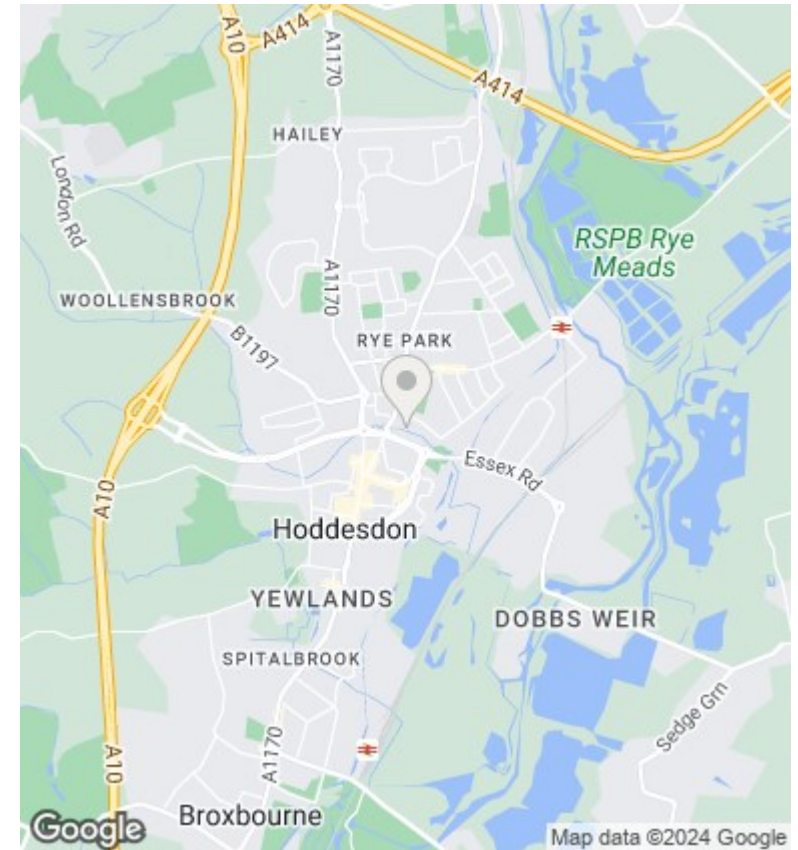

## Directions

## Viewings

Viewings by arrangement only. Call 01992 470335 to make an appointment.

## Council Tax Band

## EPC Rating:

Energy Efficiency Rating		Current	Potential
<i>Very energy efficient - lower running costs</i>			
(92 plus)	<b>A</b>		
(81-91)	<b>B</b>		
(69-80)	<b>C</b>		
(55-68)	<b>D</b>		
(39-54)	<b>E</b>		
(21-38)	<b>F</b>		
(1-20)	<b>G</b>		
<i>Not energy efficient - higher running costs</i>			
<b>England &amp; Wales</b>		EU Directive 2002/91/EC	