



# Vincent's Walk, Dorking

£1,650 Per Month





“

Cottage living at its finest. Tucked away in the centre of Dorking while still being able to access the hustle and bustle of the high street amenities with a short stroll away - it really is the best of both worlds. Although parking is not included the back garden backs onto one of Dorking's many parking areas making a resident permit an obvious choice.

”

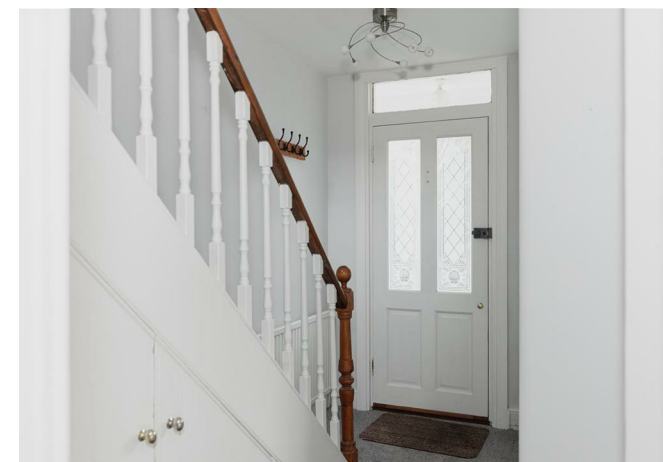

Ralph James are proud to present this beautifully presented two-bedroom cottage to the Dorking lettings market with a front and back garden.

Recently refurbished to a modern standard whilst still keeping hold of that popular cottage charm, Western Place feels fresh and new. From the moment you walk through the front gate and into the enclosed garden you are surrounded by seasonal plants and flowers with a climbing rose over the path to the finish.

From the front door you enter the welcoming hallway with understairs storage. Then into the living room filled with natural light making it a great space to wind down. To the rear of the property is a newly renovated kitchen diner with an integrated dishwasher, washing machine, and fridge,

Upstairs are the equally sized bedrooms, both with built-in storage areas and large windows. The family bathroom completes the upstairs with a modern shower and bath unit and double-glazed window for that all-important ventilation.

## Need to know

- 1800s cottage
- Sash windows
- Equal sized bedrooms
- Repainted and re-carpeted
- Refurbished kitchen with integrated white goods
- Built in storage
- Picturesque front garden
- Low maintenance back garden with storage shed to side return
- EPC: E
- Council Tax: C

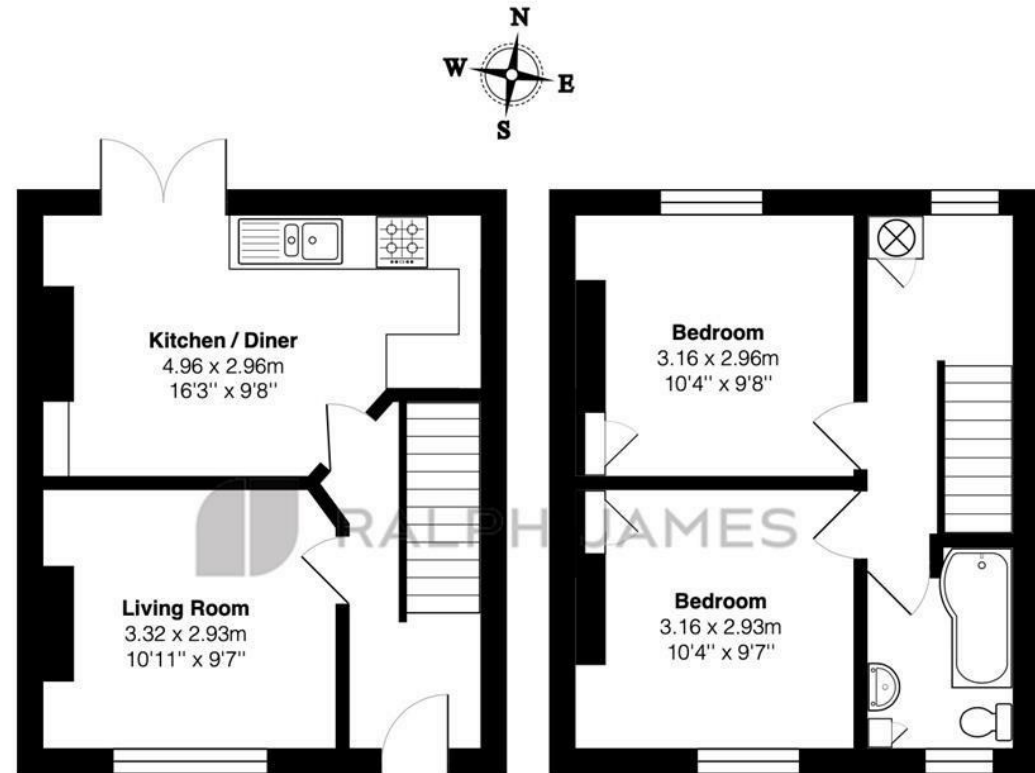

**Ground Floor**

**First Floor**

Western Place, Vincents Walk, Dorking

Total Area: 60.0 m<sup>2</sup> ... 646 ft<sup>2</sup>

FOR ILLUSTRATIVE PURPOSES ONLY.

Whilst every attempt has been made to ensure the accuracy of the floor plan shown, all measurements, positioning, fixtures, features, fittings and any other data shown are an approximate interpretation for illustrative purposes only and are not to scale.

No responsibility is taken for any error, omission, miss-statement or use of data shown.

The above statement applies to both 'Still Moving London LTD' and the Company or individual displaying this floor plan.

Unauthorised reproduction prohibited.

Â© Still Moving London LTD (www.stillmoving.london)



## Interested?

dorking@ralphjames.co.uk  
01306 284555

#

ralphjames.co.uk