



BOWDEN  
BRADLEY



7a Maple Street  
, Romford, RM7 7JX

**£1,500 Per month**





## 7a Maple Street

, Romford, RM7 7JX

AVAILABLE IMMEDIATELY. OWN GARDEN.  
Welcome to Maple Street, Romford - a charming location that could be your next home!

Rare to the market, this delightful, top floor, one DOUBLE bedroom maisonette comes with its own private rear garden, as well as own garage.

The home is in excellent condition throughout and offers a huge amount of natural light.

Romford Station is only an approx 20 minute walk away, which offers overground services, alongside the popular Elizabeth Line, which offers direct access into Tottenham Court Road in just over 30 minutes.

Don't miss out on the chance to make Maple Street your new address - book a viewing today and step into the possibilities that await you in this lovely apartment!

Front

Lounge  
13'5 x 12'6 (4.09m x 3.81m)

Bedroom  
10'8 x 9'7 (3.25m x 2.92m)

Kitchen  
12'10 x 10'8 (3.91m x 3.25m)

Bathroom  
8'3 x 5'4 (2.51m x 1.63m)

Garden







## Floor Plan

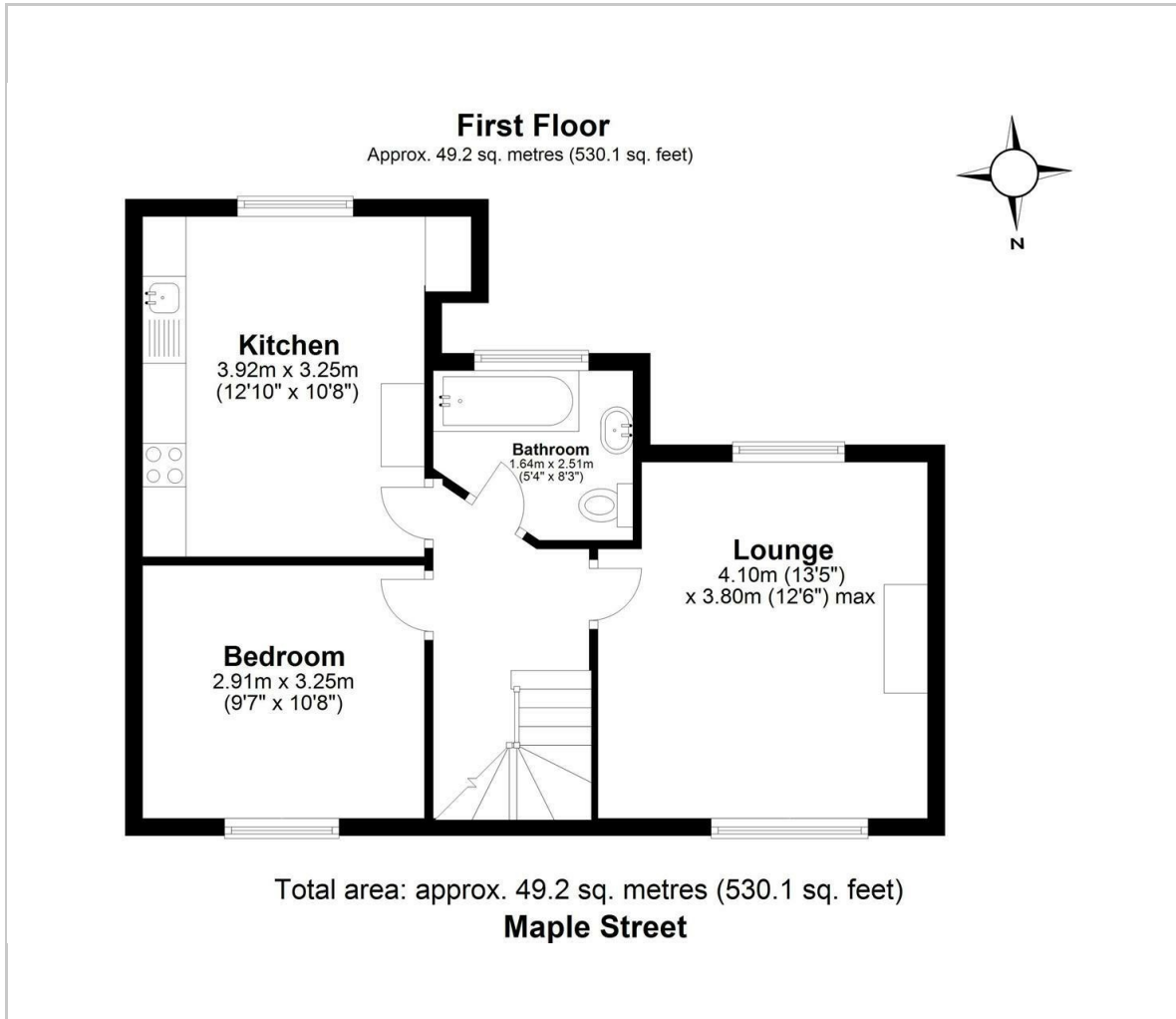

## Viewing

Please contact our Bowden Bradley Office on 0208 0593 593 if you wish to arrange a viewing appointment for this property or require further information.

## Area Map

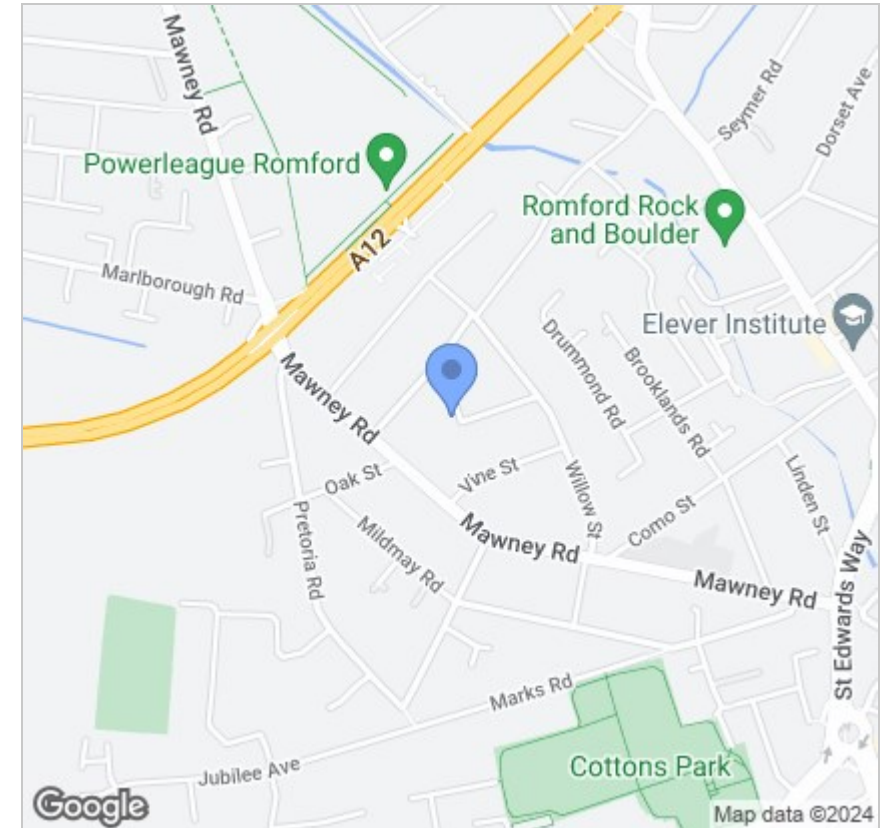

## Energy Efficiency Graph

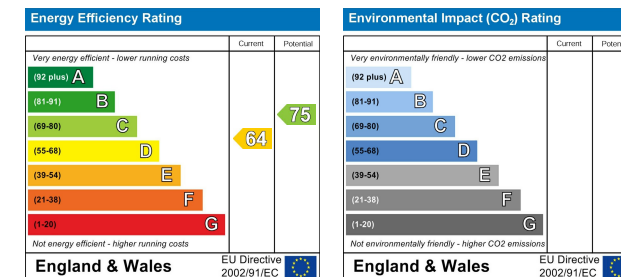

These particulars, whilst believed to be accurate are set out as a general outline only for guidance and do not constitute any part of an offer or contract. Intending purchasers should not rely on them as statements of representation of fact, but must satisfy themselves by inspection or otherwise as to their accuracy. No person in this firm's employment has the authority to make or give any representation or warranty in respect of the property.

Bansal House Bracken Industrial Estate, 185 Forest Road, Hainault, Essex, IG6 3HX  
Tel: 0208 0593 593 Email: info@bowdenbradley.co.uk