



BOWDEN  
BRADLEY



BOWDEN

177b Prospect Road, Woodford Green, IG8 7ND

Guide price £300,000

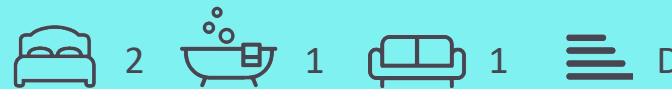

## Floor Plan

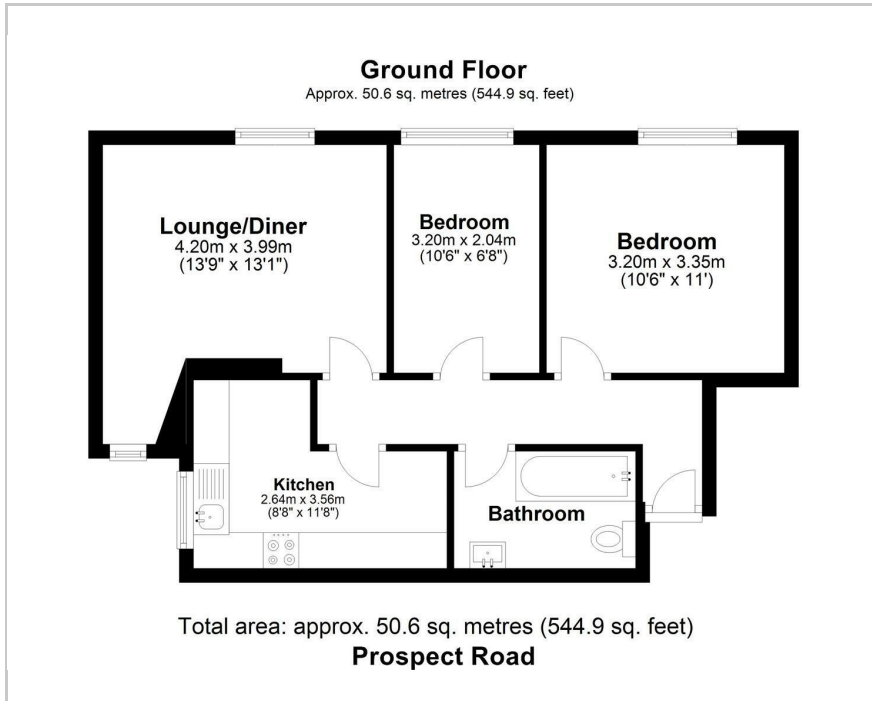

## Area Map



## Accommodation

- Guide Price £300,000 - £325,000
- 2 Bedroom Ground Floor Flat
- Garage On Block & Parking At Rear
- Immaculate Condition
- Close To Woodford Station
- Shops & Amenities Nearby
- Walkable To Parkland
- Ideal for First time buyers and Investors
- 138 Years Left On Lease
- No Service Charge

## Viewing

Please contact our Bowden Bradley Office on 0208 0593 593 if you wish to arrange a viewing appointment for this property or require further information.

## Energy Efficiency Graph

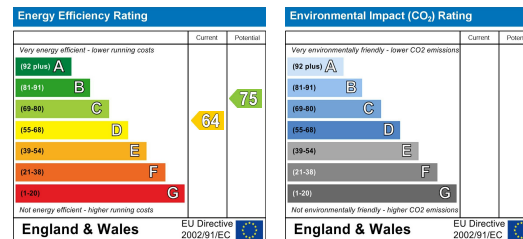

These particulars, whilst believed to be accurate are set out as a general outline only for guidance and do not constitute any part of an offer or contract. Intending purchasers should not rely on them as statements of representation of fact, but must satisfy themselves by inspection or otherwise as to their accuracy. No person in this firm's employment has the authority to make or give any representation or warranty in respect of the property.