

SECTION A

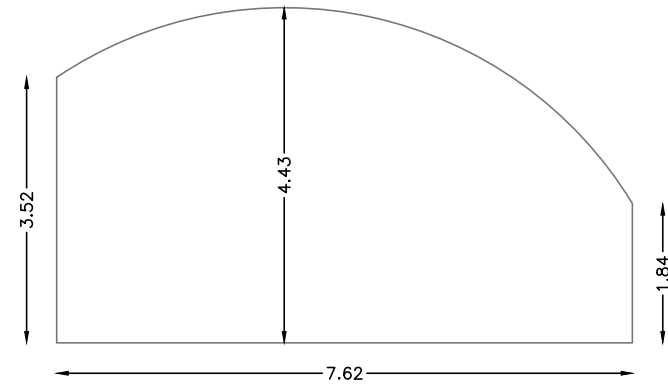

SECTION B

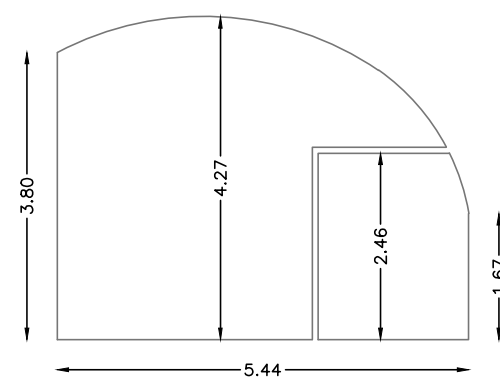

Property Ref: ZLS00400

Leman St Ld Bldgs Structures
LONDON, E1 1LX



Rental Space Ref: ZLS00407

Arch 9B, 4 Pinchin Street, LONDON, E1

Net Internal Area

NIA **76.37 sq m** **822 sq ft**

The following have been EXCLUDED from the TOTAL NIA:

INT_OTH 2.71 sq m 29 sq ft

Gross Internal Area

GIA **79.08 sq m** **851 sq ft**



CABLE STREET

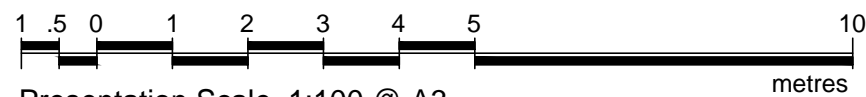
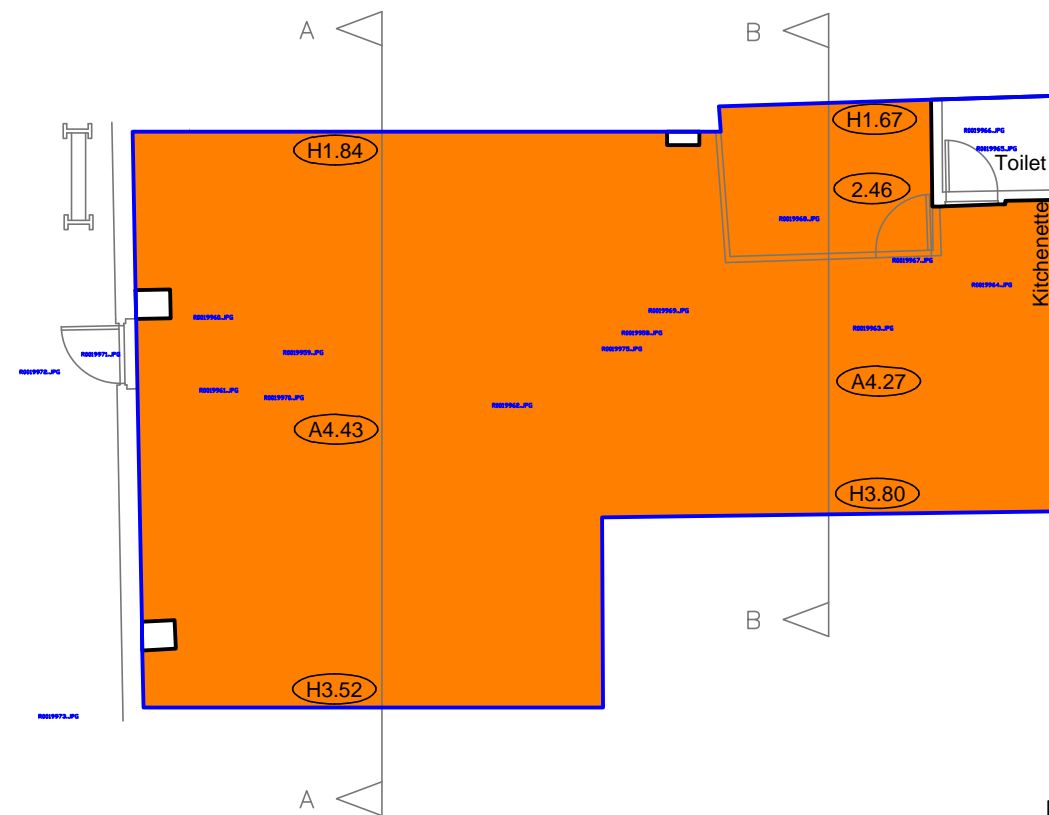

Notes:
This drawing complies with the RICS Code of Measuring Practice, 6th edition (September 2007) and the Globally applicable 6th Edition (May 2015). It indicates the extent of the areas quoted, produced to an accuracy commensurate with standard presentation scales. It is held in a scaled digital CAD format.

This drawing has been produced for area referencing purposes requested by the original commissioning agent and must not be used for any architectural or construction/engineering purposes or for any other purpose other than that for which it is originally intended. Plowman Craven Limited accepts no responsibility for details that are subsequently found to be the consequence of undisclosed facts or that were obscured from view at the time of survey or that have been altered since the date of survey.

This drawing contains Ordnance Survey data which has been reproduced with the permission of the Controller of Her Majesty's Stationery Office, Crown copyright 2020. The Ordnance Survey data has been obtained and reproduced by Plowman Craven Ltd in agreement with The Arch Company under Network Rail Licence Number 100040692.

Legend:

| | |
|---|-----------------------------|
| H0.00 | Haunch Height (m) |
| A0.00 | Arch Maximum Height (m) |
| 0.00 | Floor To Ceiling Height (m) |

Revisions:
P01 - Original Issue (February 2021)

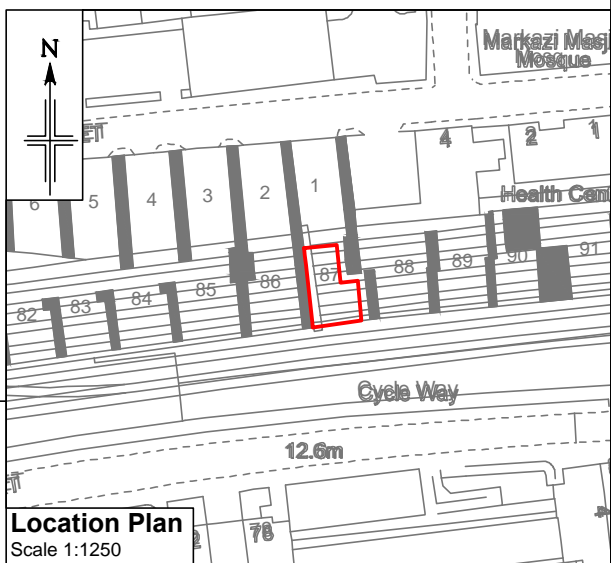

Dwg No.
43264-PCL-ZLS00407-GF-DR-G-00001_Master-S6-P01

Plowman Craven
Regulated by RICS