

SECTION A

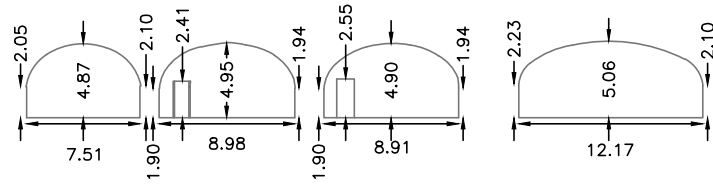

SECTION B

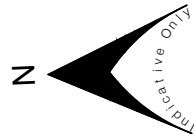
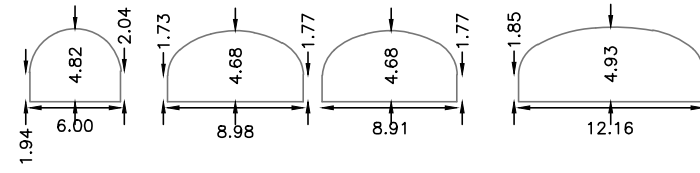

SUTTON STREET

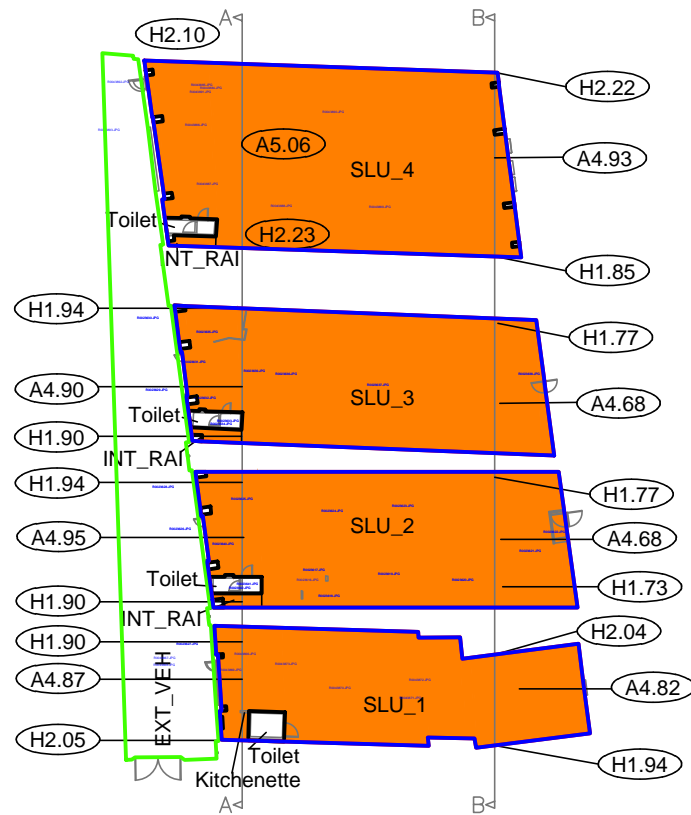

Presentation Scale 1:500 @ A3

Notes:

This drawing complies with the RICS Code of Measuring Practice, 6th edition (September 2007) and the Globally applicable 6th Edition (May 2015). It indicates the extent of the areas quoted, produced to an accuracy commensurate with standard presentation scales. It is held in a scaled digital CAD format.

This drawing has been produced for area referencing purposes requested by the original commissioning agent and must not be used for any architectural or construction/engineering purposes or for any other purpose other than that for which it is originally intended. Plowman Craven Limited accepts no responsibility for details that are subsequently found to be the consequence of undisclosed facts or that were obscured from view at the time of survey or that have been altered since the date of survey.

This drawing contains Ordnance Survey data which has been reproduced with the permission of the Controller of Her Majesty's Stationery Office, Crown copyright 2020. The Ordnance Survey data has been obtained and reproduced by Plowman Craven Ltd in agreement with The Arch Company under Network Rail Licence Number 100040692.

Legend:

- Single Lettable Unit
- H0.00 Haunch Height (m)
- A0.00 Arch Maximum Height (m)
- 0.00 Floor To Ceiling Height (m)

Revisions:

- P01 - Original Issue (February 2022)
- P02 - Site Surveyed (August 2022)
- P03 - Site Surveyed (December 2022)

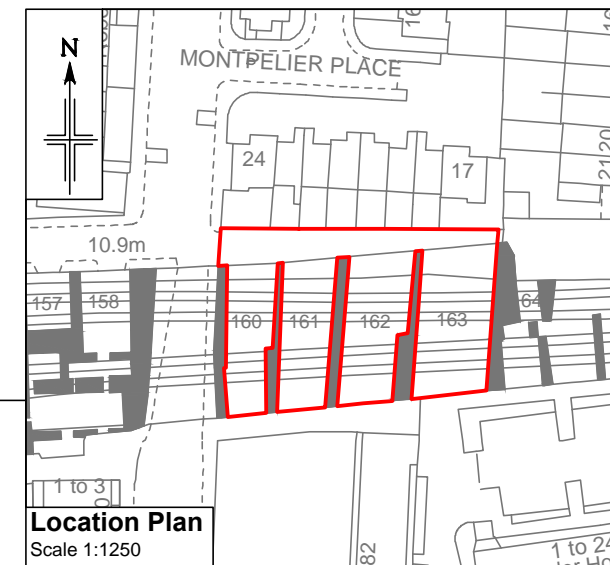

Property Ref: ZSD01500

Arches 160/169 Between Sutton
LONDON, E1 0DB



Rental Space Ref: ZSD01504

Arches 160-163 Sutton Street, LONDON, E1

Net Internal Area

NIA **858.38 sq m** **9240 sq ft**

The following have been INCLUDED in the TOTAL NIA:

INT_RA1	7.32 sq m	79 sq ft
SLU_1	161.59 sq m	1739 sq ft
SLU_2	210.79 sq m	2269 sq ft
SLU_3	207.88 sq m	2238 sq ft
SLU_4	278.12 sq m	2994 sq ft

The following have been EXCLUDED from the TOTAL NIA:

INT_OTH	20.42 sq m	218 sq ft
---------	------------	-----------

Gross Internal Area

GIA **878.80 sq m** **9458 sq ft**

The following have been INCLUDED in the TOTAL GIA:

SLU_1	166.51 sq m	1792 sq ft
SLU_2	215.83 sq m	2323 sq ft
SLU_3	212.97 sq m	2292 sq ft
SLU_4	283.49 sq m	3051 sq ft

Land Area

LAND **209.59 sq m** **2256 sq ft**

The following have been INCLUDED in the TOTAL Land Area:

EXT_VEH	209.59 sq m	2256 sq ft
---------	-------------	------------

Dwg No.

43264-PCL-ZSD01504-GF-DR-G-00001_Master-S6-P03

Plowman Craven

Regulated by RICS

