

SECTION A

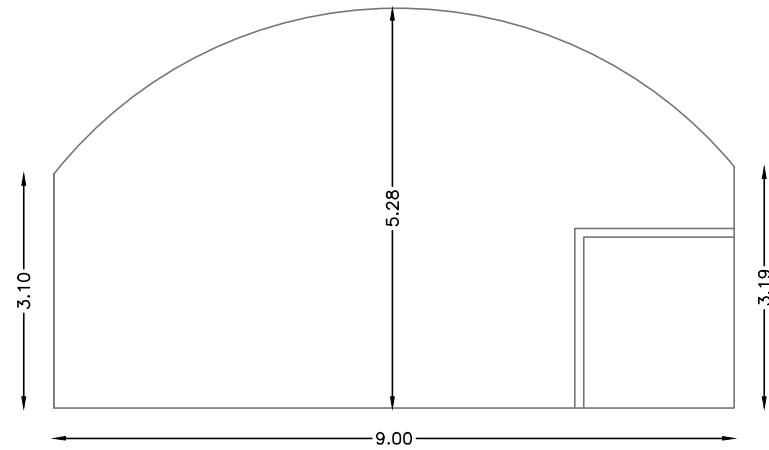

SECTION B

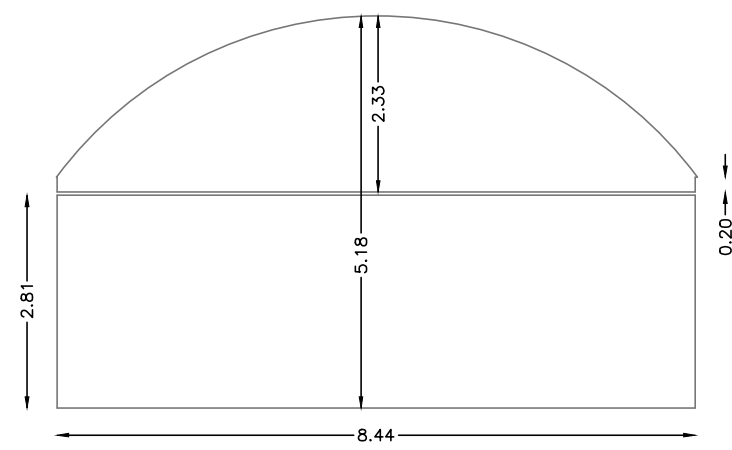

Property Ref: BET05100

Arches Poyser St 263-279
LONDON, E2 9RF



Rental Space Ref: BET05117

Arch 263 Poyser Street, LONDON, E2

Net Internal Area

NIA 150.83 sq m 1624 sq ft

The following have been INCLUDED in the TOTAL NIA:

INT_RAI 4.30 sq m 46 sq ft

The following have been EXCLUDED from the TOTAL NIA:

INT_LOW 16.12 sq m 174 sq ft

INT_OTH 11.18 sq m 120 sq ft

Gross Internal Area

GIA 178.13 sq m 1918 sq ft

Land Area

LAND 32.04 sq m 345 sq ft

The following have been INCLUDED in the TOTAL Land Area:

EXT_VEH 32.04 sq m 345 sq ft

Ground Floor GIA
130.06 sq m
1400 sq ft

Ground Floor NIA
118.52 sq m
1276 sq ft

Mezzanine GIA
48.07 sq m
518 sq ft

Mezzanine NIA
32.31 sq m
348 sq ft



POYSER STREET

CAMBRIDGE HEATH ROAD

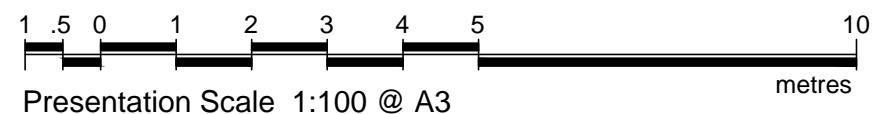
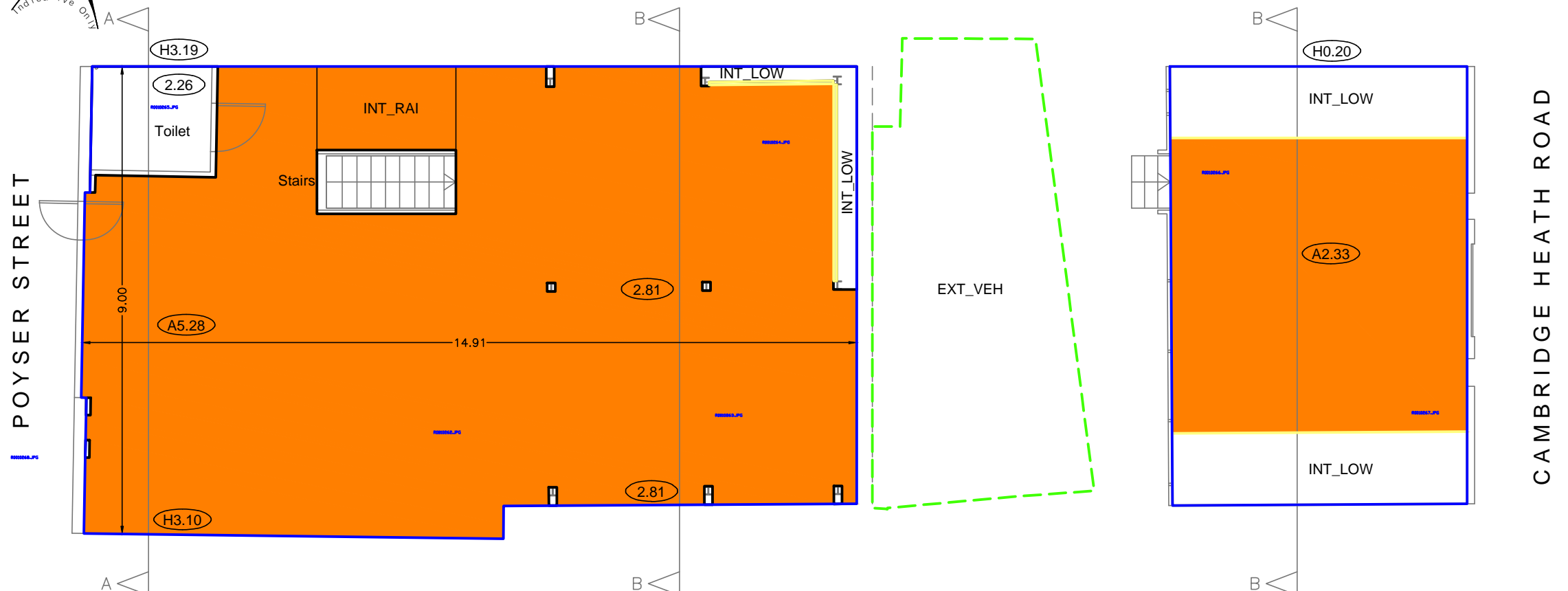

Notes:
This drawing complies with the RICS Code of Measuring Practice, 6th edition (September 2007) and the Globally applicable 6th Edition (May 2015). It indicates the extent of the areas quoted, produced to an accuracy commensurate with standard presentation scales. It is held in a scaled digital CAD format.
This drawing has been produced for area referencing purposes requested by the original commissioning agent and must not be used for any architectural or construction/engineering purposes or for any other purpose other than that for which it is originally intended. Plowman Craven Limited accepts no responsibility for details that are subsequently found to be the consequence of undisclosed facts or that were obscured from view at the time of survey or that have been altered since the date of survey.
This drawing contains Ordnance Survey data which has been reproduced with the permission of the Controller of Her Majesty's Stationery Office, Crown copyright 2020. The Ordnance Survey data has been obtained and reproduced by Plowman Craven Ltd in agreement with The Arch Company under Network Rail Licence Number 100040692.

Legend:
 Restricted Headroom
 Haunch Height (m)
 Arch Maximum Height (m)
 Floor To Ceiling Height (m)

Revisions:
 P01 - Original Issue (December 2020)
 P02 - Drawing Updated (March 2022)
 P03 - Site Revisit (April 2023)

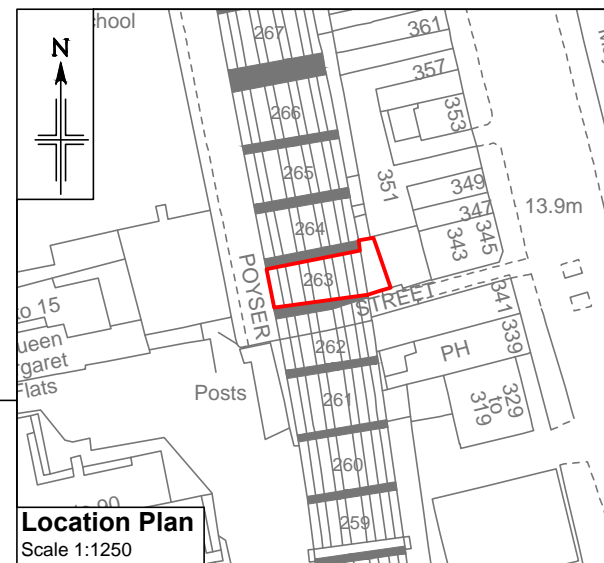

Dwg No. 43264-PCL-BET05117-ZZ-G-00001_Master-S6-P03

