

SECTION A

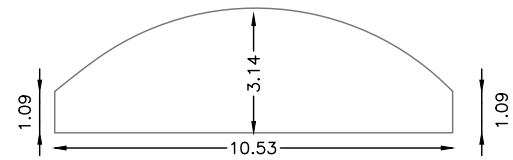

SECTION B

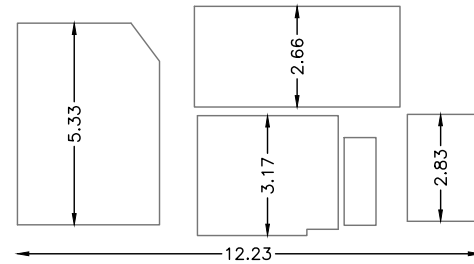

Property Ref: HAC02600

Prem btm Macron Place & LONDON, E8 1LA



Rental Space Ref: HAC02609

Arch 441 Institute Place, Hackney Downs, LONDON E8

Net Internal Area

<span style="background-color: orange; width: 15px; height: 10px; display: inline-block;"></span> NIA	<b>423.97 sq m</b>	<b>4564 sq ft</b>
---	--------------------	-------------------

The following have been INCLUDED in the TOTAL NIA:

INT_RAI	6.77 sq m	73 sq ft
INT_PAA	73.88 sq m	795 sq ft

The following have been EXCLUDED from the TOTAL NIA:

INT_LOW	14.08 sq m	151 sq ft
INT_OTH	7.09 sq m	76 sq ft

Gross Internal Area

<span style="border: 1px solid blue; width: 15px; height: 10px; display: inline-block;"></span> GIA	<b>445.14 sq m</b>	<b>4791 sq ft</b>
---	--------------------	-------------------

Land Area

<span style="border: 2px solid green; width: 15px; height: 10px; display: inline-block;"></span> LAND	<b>188.64 sq m</b>	<b>2031 sq ft</b>
---	--------------------	-------------------

The following have been INCLUDED in the TOTAL Land Area:

EXT_VEH	188.64 sq m	2031 sq ft
---------	-------------	------------

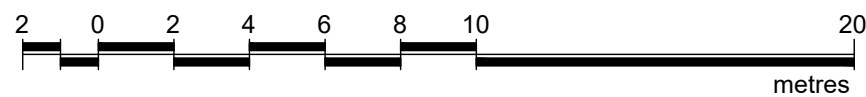
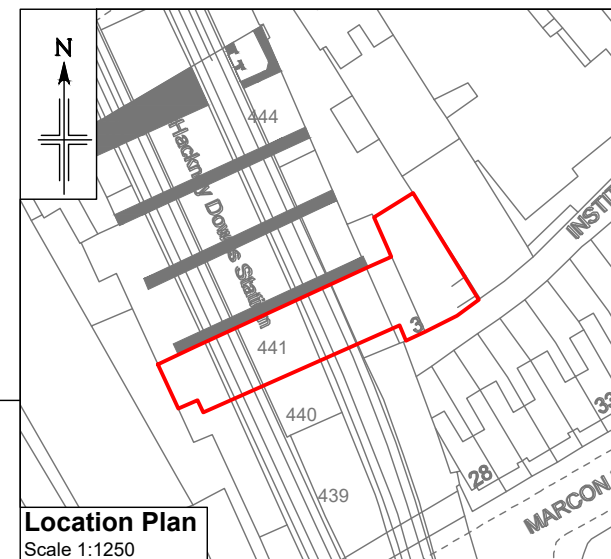
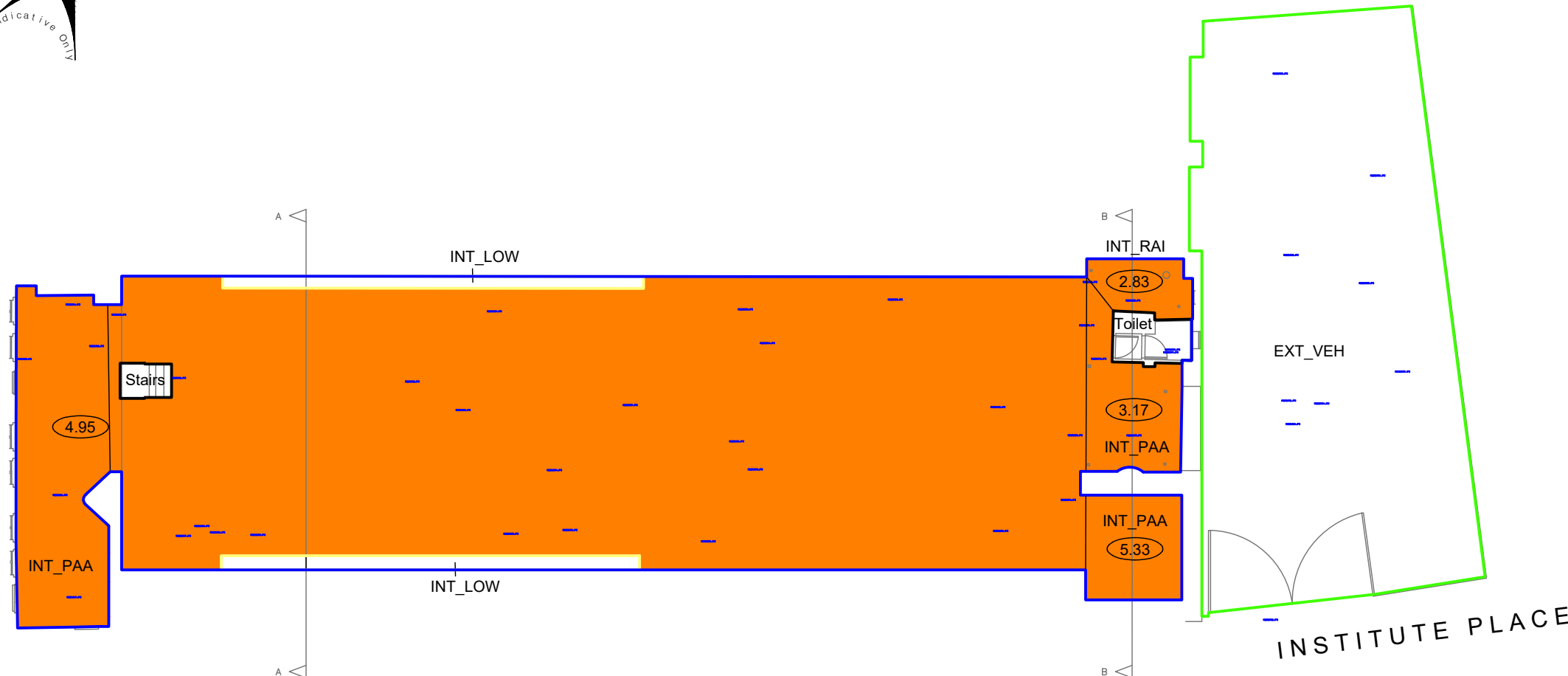
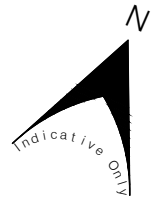

Presentation Scale 1:200 @ A3

Notes:

This drawing complies with the RICS Code of Measuring Practice, 6th edition (September 2007) and the Globally applicable 6th Edition (May 2015). It indicates the extent of the areas quoted, produced to an accuracy commensurate with standard presentation scales. It is held in a scaled digital CAD format.

This drawing has been produced for area referencing purposes requested by the original commissioning agent and must not be used for any architectural or construction/engineering purposes or for any other purpose other than that for which it is originally intended. Plowman Craven Limited accepts no responsibility for details that are subsequently found to be the consequence of undisclosed facts or that were obscured from view at the time of survey or that have been altered since the date of survey.

This drawing contains Ordnance Survey data which has been reproduced with the permission of the Controller of Her Majesty's Stationery Office. Crown copyright 2020. The Ordnance Survey data has been obtained and reproduced by Plowman Craven Ltd in agreement with The Arch Company under Network Rail Licence Number 100040692.

Legend:

- Restricted Headroom
- H0.00 Haunch Height (m)
- A0.00 Arch Maximum Height (m)
- 0.00 Floor To Ceiling Height (m)

Revisions:

- P01 - Original Issue (April 2021)
- P02 - Updated Sections (February 2022)

Location Plan  
Scale 1:1250

Dwg No.

43264-PCL-HAC02609-GF-DR-G-00001\_Master-S6-P02



Regulated by RICS

