

Drawing Frame A1 - Do not scale

- Notes:
1. Copyright: The contents of this drawing may not be reproduced in whole or in part without the written consent of Robinson Kenning & Gallagher.
 2. No dimensions to be scaled from this drawing.
 3. All dimensions to be checked on site by Contractor.
 4. Where discrepancy occurs between specification and drawings then Robinson Kenning & Gallagher must be notified immediately.

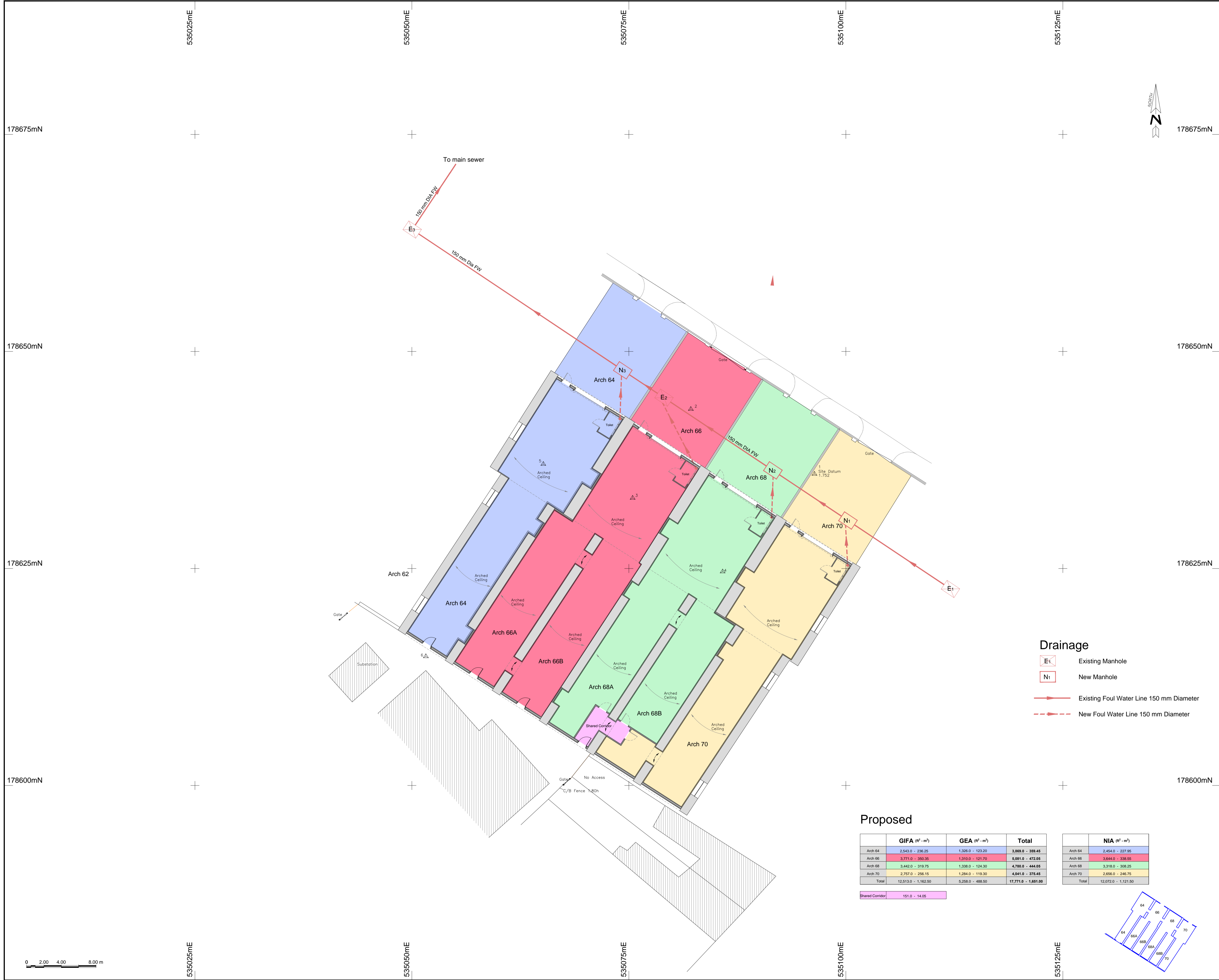

Drainage

- E1 Existing Manhole
- N1 New Manhole
- Existing Foul Water Line 150 mm Diameter
- New Foul Water Line 150 mm Diameter

Proposed

	GIFA (m ² - m ²)	GEA (m ² - m ²)	Total
Arch 64	2,843.0 - 236.25	1,328.0 - 123.20	3,889.0 - 359.45
Arch 66	3,771.0 - 350.35	1,310.0 - 121.70	5,081.0 - 472.05
Arch 68	3,442.0 - 319.75	1,338.0 - 124.30	4,780.0 - 444.05
Arch 70	2,757.0 - 256.15	1,264.0 - 119.30	4,041.0 - 375.45
Total	12,813.0 - 1,162.50	5,258.0 - 488.50	17,771.0 - 1,681.00

	NIA (m ² - m ²)
Arch 64	2,454.0 - 227.95
Arch 66	3,644.0 - 336.55
Arch 68	3,316.0 - 306.25
Arch 70	2,656.0 - 246.75
Total	12,070.0 - 1,121.50

Shared Corridor 151.0 - 14.05

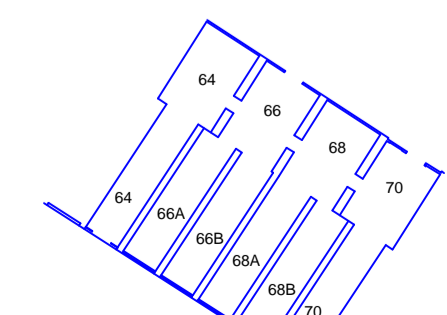

REV	DATE	BY	CDM	First issued	KWS	CHK	ATRD
P01	23.09.2021	CDM	First issued	KWS	-		
P02	30.09.2021	CDM	Drawing amended	KWS	-		
P03	02.11.2021	RL	Drawing amended	KWS	-		
C01	02.03.2022	RL	For Construction	KWS	-		

DRAWING STATUS: CONSTRUCTION

architecture
building surveying
project management
Principal Designers

Robinson Kenning & Gallagher

Airport House
Purley Way Croydon Surrey CR0 0XZ.
T: 020 8684 8125
E: info@rkpartnership.co.uk
W: www.rkpartnership.co.uk



PROJECT: Raymouth Road, London SE16 2DA
Southwark Park

TITLE: Proposed Ground Floor Plan

SCALE @ A1: 1:200	CHECKED: KS	APPROVED: ---
CAD FILE: 20-4333-A-T-010	DESIGN/DRAWN: CDM	DATE: 21.09.2021
PROJECT NO: 4333	DRAWING NO: 20-4333-A-T-010	REV: C01

