

SECTION A

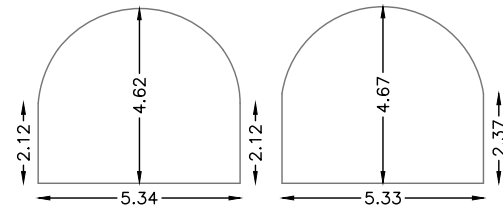

SECTION B

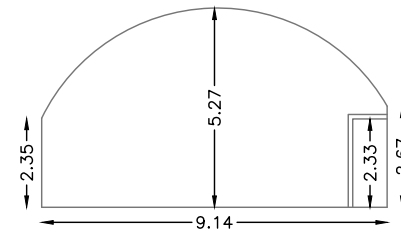

Property Ref: DEP02500

Arches Bet Trundleys Rd And E
LONDON, SE8 5JE



Rental Space Ref: DEP02503

Unit 4 Apollo Business Estate, LONDON, SE8

Net Internal Area

NIA **258.26 sq m** **2780 sq ft**

The following have been INCLUDED in the TOTAL NIA:

INT_PAA 18.63 sq m 201 sq ft

The following have been EXCLUDED from the TOTAL NIA:

INT_OTH 4.62 sq m 50 sq ft

Gross Internal Area

GIA **262.88 sq m** **2830 sq ft**

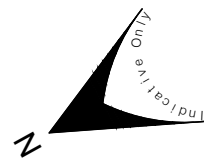

ACCESS ROAD

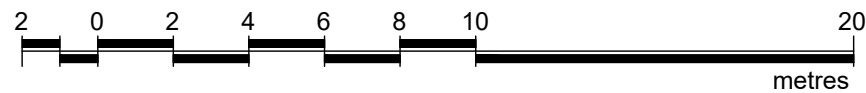
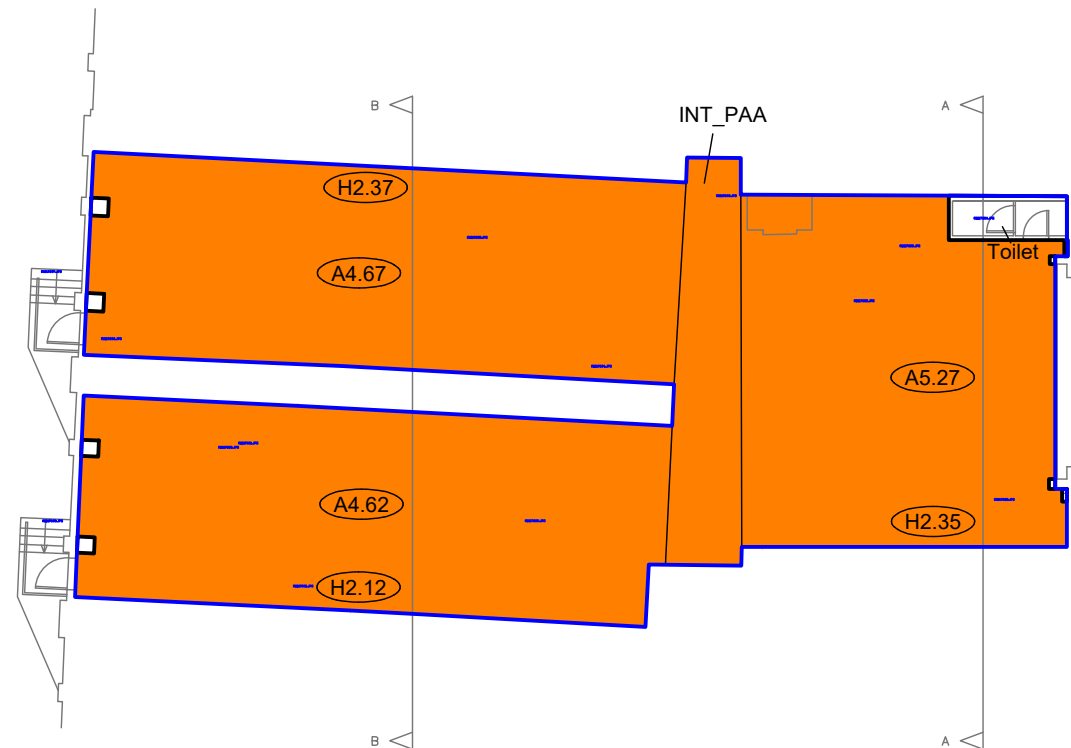

Presentation Scale 1:200 @ A3

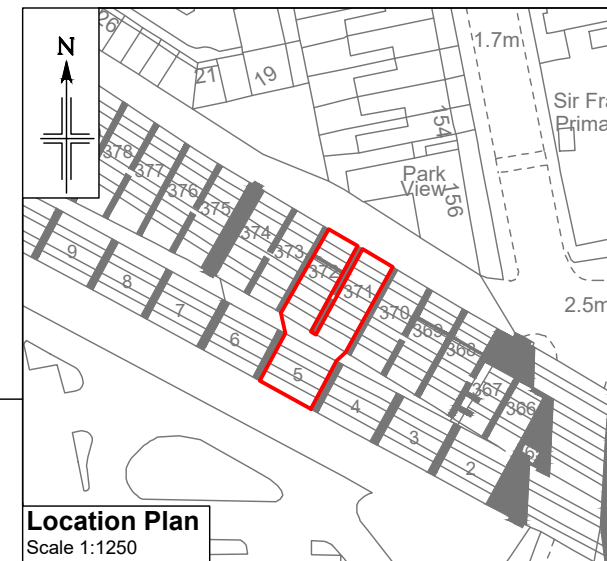

Location Plan
Scale 1:1250

Notes:
This drawing complies with the RICS Code of Measuring Practice, 6th edition (September 2007) and the Globally applicable 6th Edition (May 2015). It indicates the extent of the areas quoted, produced to an accuracy commensurate with standard presentation scales. It is held in a scaled digital CAD format.

This drawing has been produced for area referencing purposes requested by the original commissioning agent and must not be used for any architectural or construction/engineering purposes or for any other purpose other than that for which it is originally intended. Plowman Craven Limited accepts no responsibility for details that are subsequently found to be the consequence of undisclosed facts or that were obscured from view at the time of survey or that have been altered since the date of survey.

This drawing contains Ordnance Survey data which has been reproduced with the permission of the Controller of Her Majesty's Stationery Office, Crown copyright 2020. The Ordnance Survey data has been obtained and reproduced by Plowman Craven Ltd in agreement with The Arch Company under Network Rail Licence Number 100040692.

Legend:

- H0.00 Haunch Height (m)
- A0.00 Arch Maximum Height (m)
- 0.00 Floor To Ceiling Height (m)

Revisions:

P01 - Original Issue (April 2021)

Dwg No.
43264-PCL-DEP02503-GF-DR-G-00001_Master-S6-P01

Plowman Craven

Regulated by RICS

