

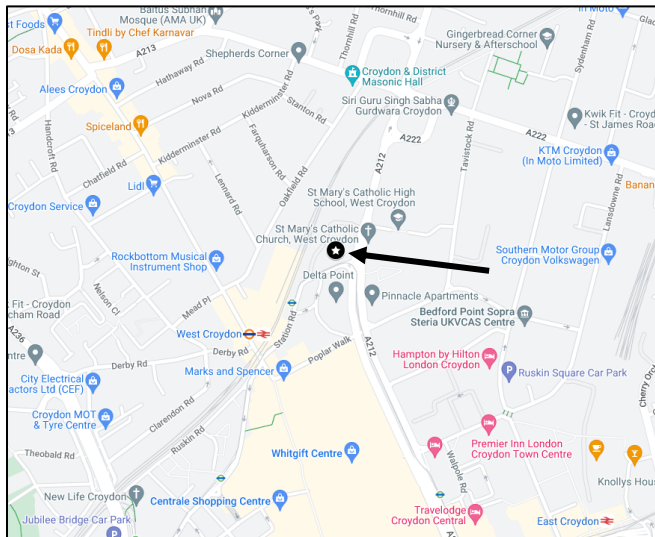

INTERCHANGE
81-85 STATION ROAD, CROYDON, CR0 2AJ

FROM C. 7,500 SQ FT, UP TO 43,264 SQ FT: FULLY-FITTED OFFICE SPACE AVAILABLE NOW

geraldeve.com

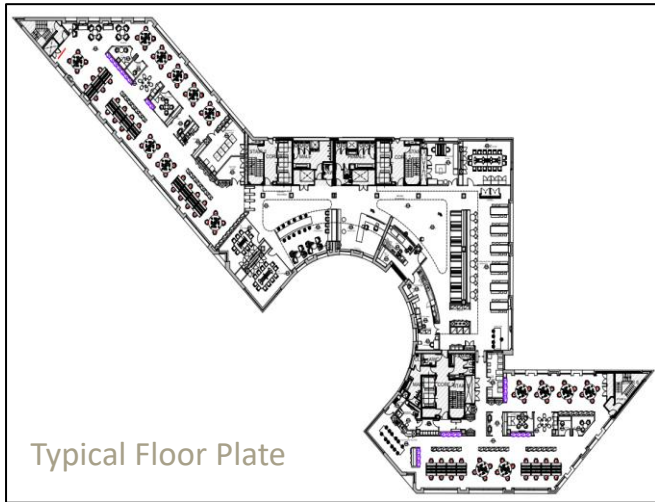

Location

Interchange is located adjacent to West Croydon National Rail and Overground station (direct services to Highbury & Islington). East Croydon station is a short (approx.) 10-minute walk away, providing direct services to London Bridge, London Victoria, Gatwick Airport and Brighton.

Description

The accommodation is fitted out to a high standard incorporating a mixture of open plan office space, break-out areas, kitchenettes, meeting rooms, and some cellular offices. The 7th floor benefits from a fully fitted cafeteria, including food preparation area, serving area and bench seating.

The space benefits from lots of natural light and is **fully fitted and furnished**.

Other features include:

- Triple height building entrance reception
- Private garden area
- Secure cycle storage
- Communal, and private, shower facilities
- Private, secure car parking, at a ratio of approx. 1:650 sq ft
- Suspended ceilings
- Raised floors
- 8 x 13-person passenger lifts

The accommodation is **available for immediate occupation** (Subject to Contract).

Schedule of accommodation (approx. floor areas)

Floor	Area (sq m)	Area (sq ft)
7 th	1,672	18,002
6 th	1,651	17,768
Part 5 th	696	7,494
Total NIA	4,019	43,264

Business Rates

Business rates are estimated at £10.85 psf (2023). Interested parties are advised to make their own enquiries with the Valuation Office.

Service Charge

The service charge is estimated at £11.60 psf for the year to December 2023.

EPC

The current EPC rating is 'C'. See link below for more information.

[Energy performance certificate \(EPC\) – Find an energy certificate – GOV.UK \(find-energy-certificate.service.gov.uk\)](#)

Rent

On Application

Terms

Requirements from approximately 7,500 sq ft + can be accommodated, for a term of years to be agreed.

Viewing

By appointment through the sole agents, Gerald Eve LLP.

Greg Carter

Tel. +44 (0)7881 252 528

GCarter@geraldeve.com

Max Johnson

Tel. +44 (0)7826 354 266

MJohnson@geraldeve.com

Gerald Eve LLP is a limited liability partnership registered in England and Wales (registered number OC339470 and registered office at One Fitzroy 6 Mortimer Street London W1T 3JJ). The term partner is used to refer to a member of Gerald Eve LLP, Newmark GE Services LLP or an employee or consultant with equivalent standing and qualifications.

The particulars are issued pursuant to the following conditions:

1. No Offer: These particulars do not, and shall not constitute, in whole or in part, an offer or a contract or part thereof. Gerald Eve LLP, nor any Gerald Eve Person has authority to make or enter into any such offer or contract;
2. No Reliance: All statements contained in these particulars are made without acceptance any liability in negligence or otherwise by Gerald Eve LLP and/or any Gerald Eve Person, for themselves or for the Vendors/Lessors. None of the statements contained in these particulars is to be relied on as a statement or representation of fact or warranty on any matter whatsoever, and intending purchasers must satisfy themselves by whatever means as to the correctness of any statements made within these particulars and/or the fitness of the property for any purpose whatsoever. In particular, and without prejudice to the foregoing: (a) all images, photographs, videos etc. may show only certain parts of the property and only at it appeared at the time they were created; (b) any statement concerning price or value is provided purely as guidance, it does not constitute a formal valuation and should not be relied upon; and (c) any reference to alterations to, or use of, any part of the property does not mean that any necessary planning, building regulations or other consent has been obtained.
3. Crime Prevention: In accordance with our legal obligations pursuant to the Money Laundering, Terrorist Financing and Transfer of Funds (Information on the Payer) Regulations 2017, the Proceeds of Crime Act 2002 and other regulations, Gerald Eve LLP may be required to establish the identity and source of funds of all parties to property transactions (including both Vendors/Lessors and Purchasers/Lesseees). Failure to procure this information where needed may delay or cancel any potential transaction or prevent Gerald Eve LLP from acting altogether.
4. Privacy: For further information concerning how we use personal data please see our privacy statement: www.geraldeve.com/privacy-statement/
Particulars issued **May 2023**



GERALDEVE
A NEWMARK COMPANY





GERALDEVE
A NEWMARK COMPANY

