



Aston Close, Solihull, West Midlands

Shared Ownership £78,750

 2  2  1



- Modern 2-bedroom end-of-terrace home built by Bloor Homes in 2019
- Ideal for first-time buyers, small families, or those looking to downsize
- Stylish kitchen with integrated oven
- Fitted blinds throughout for privacy and modern aesthetic
- Peaceful area with access to local amenities
- 25% Shared Ownership purchase - (Minimum 25% share available to staircase to 100%)
- Spacious living/dining area with ample natural light
- Master bedroom with fitted wardrobes for added storage
- Ground floor includes a convenient downstairs toilet
- Excellent transport links, close to Solihull train station and major motorways (M42, M40)

GROUND FLOOR

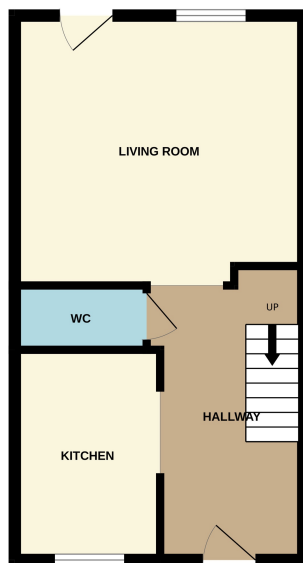

1ST FLOOR

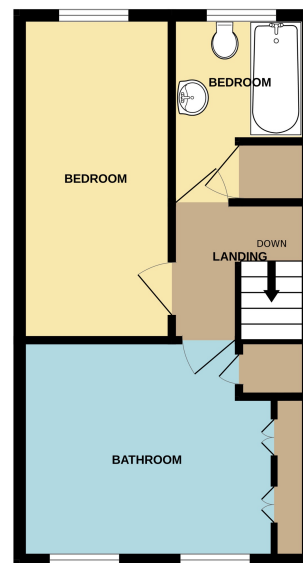

Whilst every attempt has been made to ensure the accuracy of the floorplan contained here, measurements of doors, windows, rooms and any other items are approximate and no responsibility is taken for any error, omission or mis-statement. This plan is for illustrative purposes only and should be used as such by any prospective purchaser. The services, systems and appliances shown here are not been tested and no guarantee as to their operability or efficiency can be given.
Made with Metropix 10/2024

(25% SHARED OWNERSHIP) Charming 2-Bedroom End-of-Terrace Home in Blythe Valley, Solihull

Welcome to this beautifully presented end-of-terrace property, built by renowned developers Bloor Homes in 2019. Situated in the desirable Blythe Valley area of Solihull, this modern 2-bedroom home offers a blend of contemporary style and comfortable living.