



Springthorpe Road, Erdington, Birmingham

£315,000

 4  2  1



- Viewing highly recommended to fully appreciate the size and features offered by this property
- First floor comprises four bedrooms (master with en-suite) and family bathroom
- Conveniently located close to amenities, parks, schools, and transport links
- Finished to a superb contemporary standard with expansive, flexible accommodation
-
- Off-road parking available for convenience
- Ground floor includes living room, dining room, kitchen, utility room, WC, and integral garage
- Well-presented and spacious throughout, ideal for families
- Stunning 4 bedroom detached family home in a popular residential location
-

GROUND FLOOR
661 sq.ft. (61.4 sq.m.) approx.

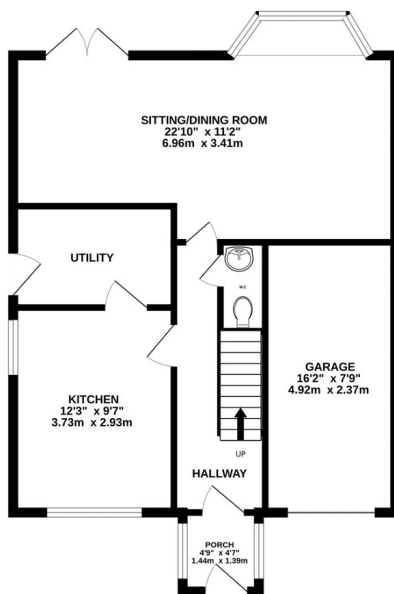

1ST FLOOR
532 sq.ft. (49.4 sq.m.) approx.

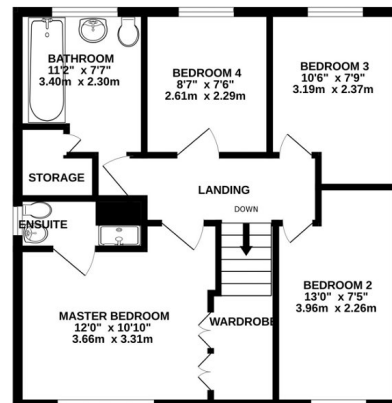

TOTAL FLOOR AREA : 1193 sq.ft. (110.9 sq.m.) approx.

Whilst every attempt has been made to ensure the accuracy of the floorplan contained here, measurements of doors, windows, rooms and any other items are approximate and no responsibility is taken for any error, omission or mis-statement. This plan is for illustrative purposes only and should be used as such by any prospective purchaser. The services, systems and appliances shown have not been tested and no guarantee as to their operability or efficiency can be given.
Made with Metropix ©2024

Nestled in the desirable Springthorpe Road, this stunning 4 bedroom detached family home exudes modern elegance and offers spacious living areas perfect for families. Its prime location provides easy access to an array of amenities, parks, schools, transportation options, and motorways, ensuring both comfort and convenience for its residents.