



6 Heol Tapscott

£230,000

 2  2  1



- Modern home in the prestigious Barry Waterfront Development
- Ideal commuter belt location for Cardiff and the M4 corridor
- Double parking bay and a fully boarded loft with shelves for extra storage
- Spacious living/dining room with patio doors to the rear garden
- Close proximity to local shops, schools and Barry's attractions
- Convenient location with easy access to Barry Centre, Penarth and Culverhouse Cross
- Two double bedrooms, two bathrooms, and a WC
- Well-appointed kitchen with modern appliances
- Enclosed rear garden with patio, lawn, pergola, and garden shed
- Perfect opportunity to own a beautifully decorated home in a prime location

Ground Floor
Approx. 31.1 sq. metres (334.7 sq. feet)

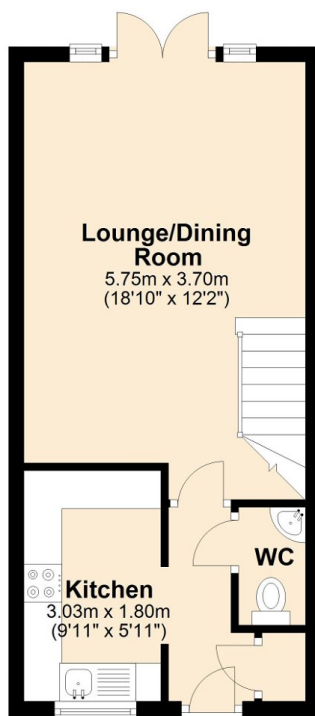

First Floor
Approx. 31.2 sq. metres (336.1 sq. feet)

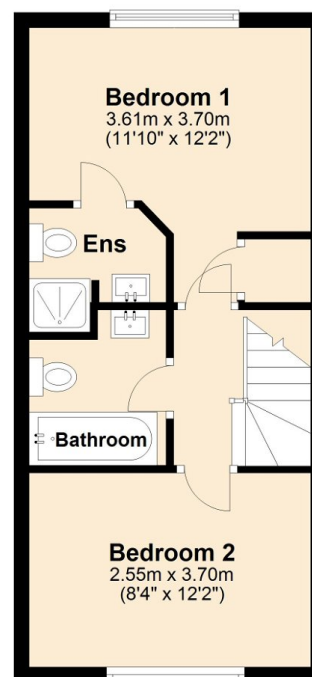

Total area: approx. 62.3 sq. metres (670.8 sq. feet)

Introducing this stunningly decorated 2-Bedroom property situated in the desirable Barry Waterfront Development. Boasting a prime location with easy access to Barry Centre, Penarth, and Culverhouse Cross, this property is ideally situated in the commuter belt for Cardiff and the M4 corridor.