

Tile Grove, Kingshurst, Birmingham

Guide Price £130,000

 3  1  1



Located in the heart of Kingshurst, Birmingham, this inviting 3-bedroom flat on the 2nd floor offers a perfect blend of comfort and convenience. With one allocated parking space in the private rear carpark and expansive communal gardens, this property is situated in an excellent spot with amenities, schools and transport links near by.

Key Features

- Well-appointed 3-bedroom flat in Kingshurst, Birmingham, situated on the 2nd floor
- Features a balcony accessible from the living room, offering a delightful outdoor space
- Newley extended lease (currently 994 years)
- Tile Grove benefits from proximity to Marston Green Railway Station, located just a short distance away
- Comes with one allocated parking space in the private rear carpark and expansive communal gardens
- Modern family bathroom with a refreshing ambiance, overlooking the rear of the property
- Tile Grove benefits from excellent transport links, ensuring easy connectivity to major road networks and destinations
- Please see description for details on Service Charge and Ground Rent

GROUND FLOOR

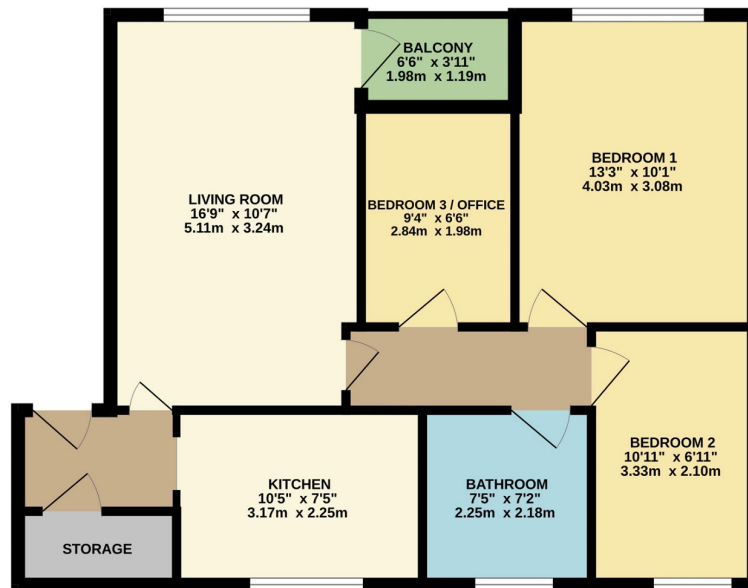

Whilst every attempt has been made to ensure the accuracy of the floorplan contained here, measurements of doors, windows, rooms and any other items are approximate and no responsibility is taken for any error, omission or mis-statement. This plan is for illustrative purposes only and should be used as such by any prospective purchaser. The services, systems and appliances shown have not been tested and no guarantee as to their operability or efficiency can be given.
Made with Metroplan ©2024