

LAWRENCE
THREE
BEDROOM
HOME

BLOOR HOMES



A three bedroom detached home with a substantial lounge and an impressive open plan kitchen / dining area with French doors leading to the rear garden. Upstairs boasts three generous bedrooms with the master benefitting from an en suite shower room.

LAWRENCE

A STYLISH THREE BEDROOM
DETACHED HOME

**LAWRENCE
THREE
BEDROOM
HOME**

FIRST FLOOR:

BEDROOM 1
3.21m x 3.48m
10'6" x 11'5"

EN SUITE

BEDROOM 2
3.28m x 2.45m
10'9" x 8'0"

BEDROOM 3
3.30m x 2.43m
10'10" x 7'11"

BATHROOM

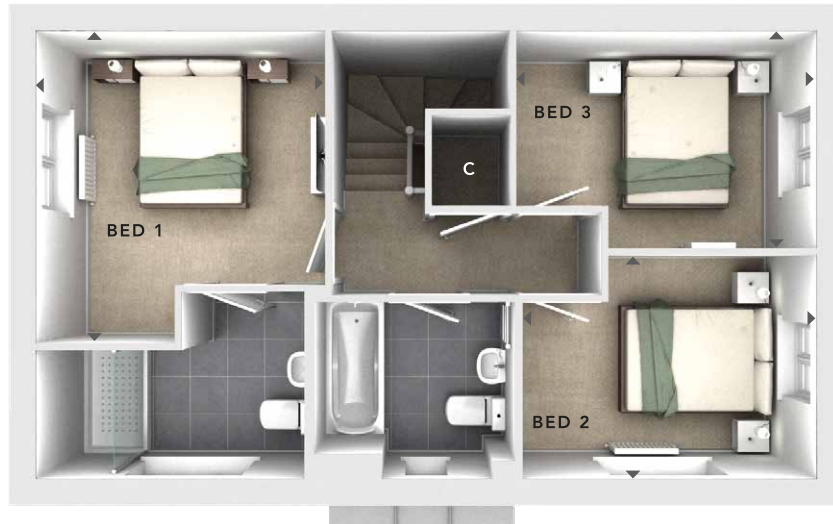

**FIRST
FLOOR**

GROUND FLOOR:

LOUNGE
3.26m x 4.95m
10'8" x 16'3"

KITCHEN / DINING
3.21m x 4.95m
10'6" x 16'3"

CLOAKS



**GROUND
FLOOR**

C	- Storage
△	- External Access
◄►	- Measurement Points
© Bloor Homes • 301R 4.7	