



**02 Parliament House 81 Black Prince Road, London, SE1 7ET**

 2 
  1 
  1 
  B



Large and spacious two-bedroom apartment is now available to rent. This bright apartment further benefits from its own private balcony, a concierge, private residents' gymnasium, cycle storage and communal roof terrace. The property comprises an open plan reception with modern integrated kitchen, double bedrooms and luxury bathroom.

Located in central London and within walking distance of the South bank with a variety of lovely restaurants, Borough Market, and unique shopping experiences. Parliament House is also well connected with Waterloo, Westminster and Vauxhall and Nine Elms underground stations.  
\*\*The beds have been digitally dressed for marketing purposes.

Council Tax Band: Lambeth- E  
Minimum contract: 12 months  
Change of contract fee: £50 including VAT  
Lift access / EWS1: Ask Agent  
Holding Deposit - £640 (1 weeks rent, subject to agreed offer)

To check broadband and mobile phone coverage please visit Ofcom.  
To check planning permission please visit Lambeth Council Website, Planning & Building Control

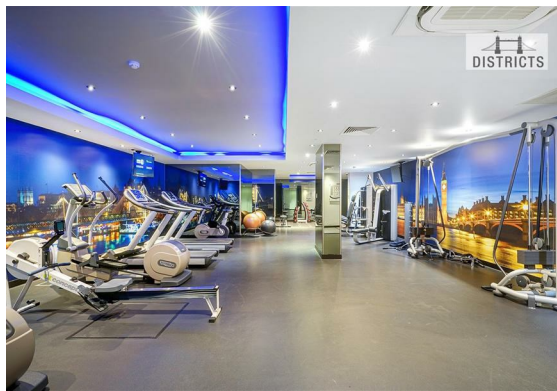





Energy Efficiency Rating		
	Current	Potential
Very energy efficient - lower running costs		
(92 plus) A		
(81-91) B	81	81
(69-80) C		
(55-68) D		
(39-54) E		
(21-38) F		
(1-20) G		
Not energy efficient - higher running costs		
England & Wales		EU Directive 2002/91/EC

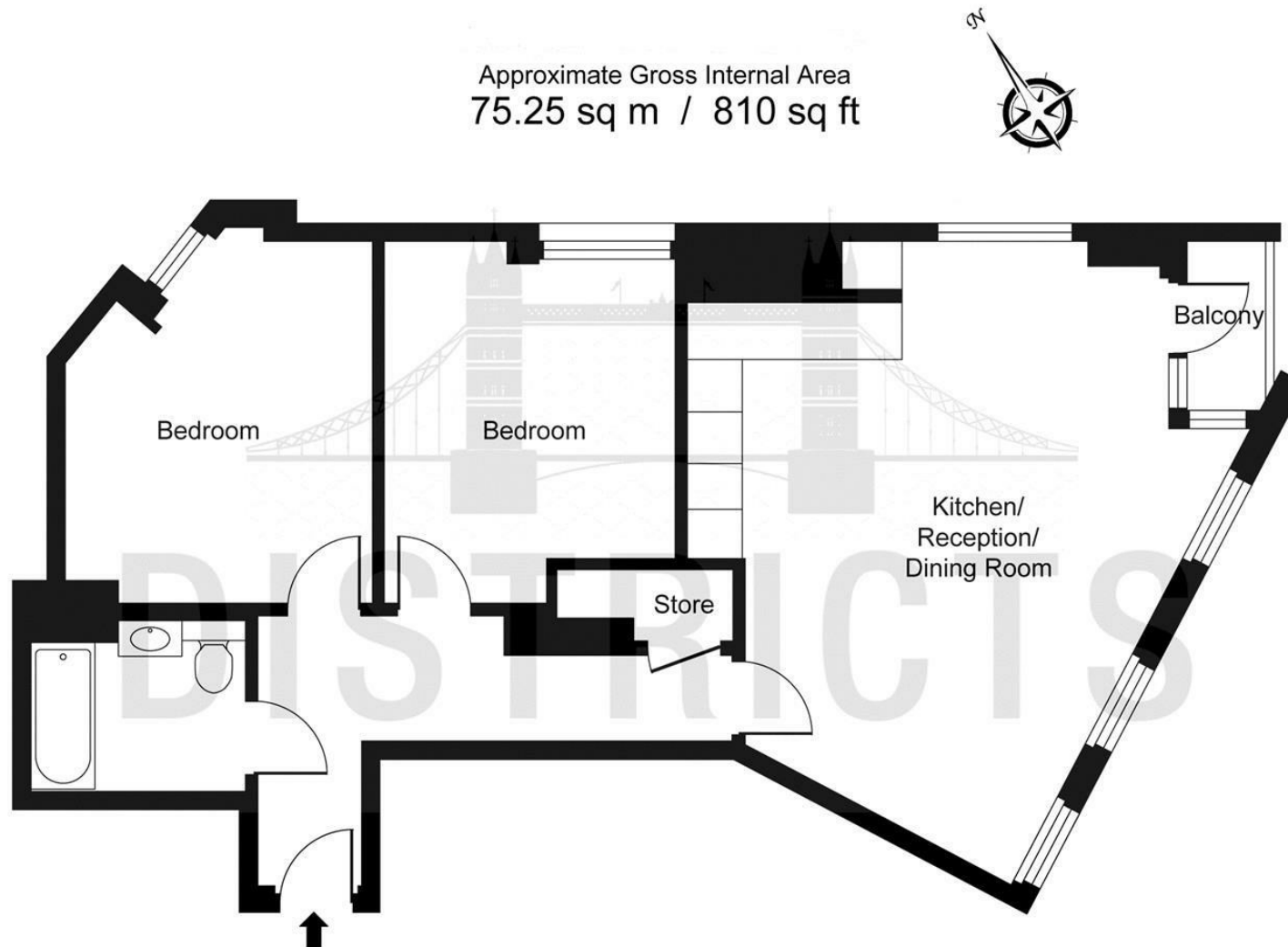

Approximate Gross Internal Area  
75.25 sq m / 810 sq ft

ILLUSTRATION FOR IDENTIFICATION PURPOSES ONLY  
ALL MEASUREMENTS AND AREA FIGURES SUPPLIED BY OTHERS, ACCURACY IS NOT GUARANTEED.  
THIS PLAN MUST NOT BE REPRODUCED BY ANY OTHER PERSON WITHOUT PERMISSION

These particulars, whilst believed to be accurate are set out as a general outline only for guidance and do not constitute any part of an offer or contract. Intending purchasers should not rely on them as statements of representation of fact, but must satisfy themselves by inspection or otherwise as to their accuracy. No person in this firms employment has the authority to make or give any representation or warranty in respect of the property.