

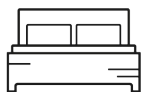

46 Botanic Square

3



2



1

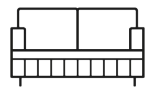

Asking price £750,000

Apartment - null

Size - 966.00 sq ft

Deposit -

null -

Council Tax Band - G

46 Botanic Square, London, E14 0NJ

Asking price £750,000

966 sq.ft | Exclusive Development | 3 Double Bedrooms & 2 Luxury Bathrooms (1 En-Suite) | Secure Underground Parking | Large Private Terrace | Spectacular Views | Residents' Lounge Gymnasium, Swimming Pool, Spa & Treatment rooms, Jacuzzi, Sauna, Clubhouse, On-Site Grocers, Screening Room, Gardens | 24-hour concierge

Leasehold: 999 years Approx
 Service Charge: Approx £3,854 pa
 Ground Rent: Approx £600 pa
 Council Tax - Tower Hamlets, Band G

Floorplan

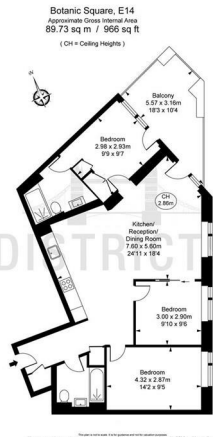

Key Information

- 3 Beautiful Bedrooms with 2 luxurious Bathrooms (1 En-Suite)
- 966 sq. ft
- Secure Underground Parking
- Transport links include the DLR, Jubilee Line and local bus routes all within easy reach.
- High Specification Integrated Kitchen
- Open plan reception with Private Terrace
- 24-hour concierge
- 2 Pools including outdoor heated pool, sauna and hydro pool
- Gymnasium, Spa & Treatment rooms, On-Site Grocers and Gardens.
- Access to Clubhouse, Residents Lounge and Private Cinema

EPC CERTIFICATE

