

COUNTRYSIDE AT



TATTENHOE PARK

MILTON KEYNES



Computer generated image of The Sparrow, plots 249 & 250

THE SPARROW 2 bedroom, 2 storey house

Plots 77, 78, 125, 126, 130, 131, 133, 237, 238,
240, 241, 247, 249, 250, 267, 268 & 271

The Sparrow is a striking two bedroom home you'll be proud to call your own. Downstairs, the open plan living space flows from the front of the house to the garden beyond. On the first floor, the two good-sized bedrooms both feature large windows to offer a bright and airy ambience.



COUNTRYSIDE

Places People Love



THE SPARROW

Total internal area 61 sq.m 662 sq.ft

Plots 77, 78, 125, 126, 130*, 131*, 133*, 237*, 238,
240*, 241, 247, 249, 250, 267, 268, & 271*

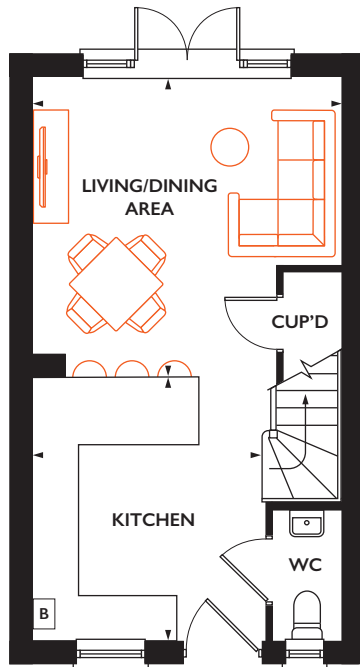

Ground floor

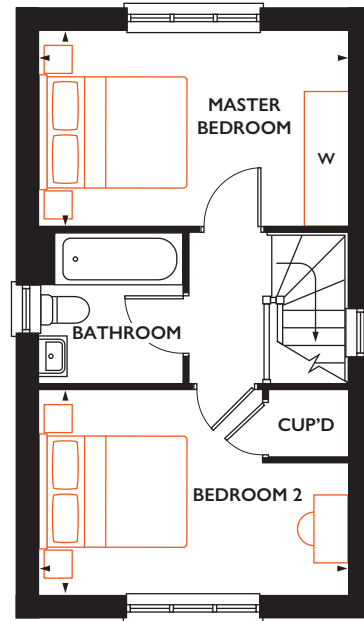

First floor

Ground floor

LIVING/DINING AREA

4.07m x 3.97m 13' 5" x 11' 6"

KITCHEN

3.50m x 3.07m 11' 6" x 10' 1"

First floor

MASTER BEDROOM

4.07m x 2.57m 13' 5" x 8' 5"

BEDROOM 2

4.07m x 2.70m 13' 5" x 8' 10"

* Handed plot B = Boiler (location is indicative) W = Space for a wardrobe

All room sizes are approximate with maximum dimensions which have been taken into the kitchen units and are not intended for carpet sizes or items of furniture. All dimensions and areas listed are to finished measurements. Countryside operates a policy of continuous product development and all room layouts may be subject to minor modifications. Kitchen, bathroom and furniture layouts shown are indicative only. Computer generated images are indicative only and can be subject to change. Images are often shown from an imaginary open space area and variations to the external design and landscaping may occur. Please ask Sales Consultants for detailed information regarding specific properties. January 2022.



countrysidetattenhoe.com

