



Homedove House Blundellsands Road East

, Liverpool, L23 8XB

£77,000



Homedove House Blundellsands Road East

, Liverpool, L23 8XB

£77,000



Hallway

Intercom and emergency pull chord system. Storage cupboard housing hot water boiler and electric fusebox.

Communal Entrance, Residents' Lift & Facilities

Pleasant communal entrance hall with resident's lift. Light and airy communal lounge areas, laundrette.

Living Dining Room

Kitchen Area

Range of wall, base and drawer units. Space for oven, Plumbing for washing machine, space for Fridge/Freezer

Bedroom

Modern Wet Room

Property History

Homedove House was constructed by McCarthy & Stone (Developments) Ltd and comprises 41 properties arranged over 3 floors each served by lift. The Visiting Development Manager can be contacted from various points within each property in the case of an emergency. For periods when the Development Manager is off duty there is a 24 hour emergency Appello call system. Each property comprises an entrance hall, lounge, kitchen, one or two bedrooms and bathroom. It is a condition of purchase that residents be over the age of 60 years, or in the event of a couple, one must be over the age of 60 years and the other over 55 years.



Road Map

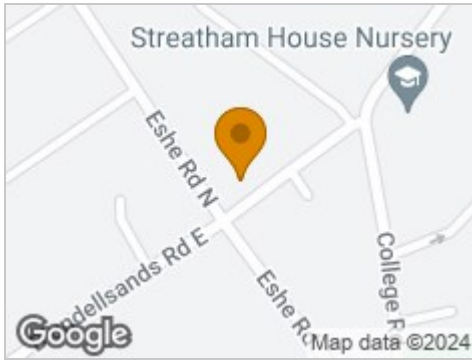

Hybrid Map



Terrain Map



Floor Plan

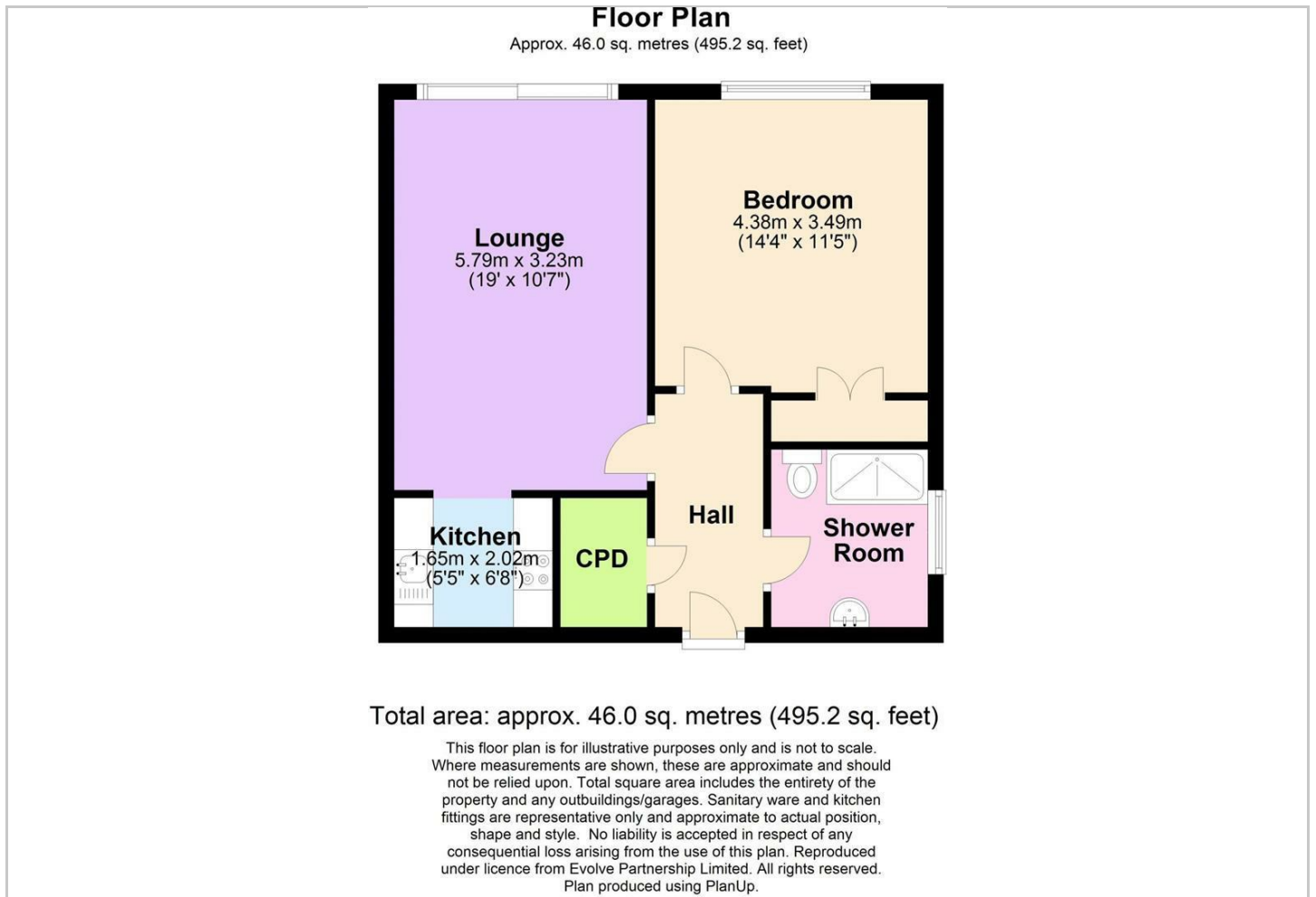

Viewing

Please contact our Michael Moon Office on 0151 924 1000 if you wish to arrange a viewing appointment for this property or require further information.

Energy Efficiency Graph



These particulars, whilst believed to be accurate are set out as a general outline only for guidance and do not constitute any part of an offer or contract. Intending purchasers should not rely on them as statements of representation of fact, but must satisfy themselves by inspection or otherwise as to their accuracy. No person in this firm's employment has the authority to make or give any representation or warranty in respect of the property.