



3 The Serpentine North

, Liverpool, L23 6UT

£145,000

This First floor apartment is nestled within a quiet and sought after location. A stones throw is Crosby beach with the award winning 'Antony Gormley' statues and Hall Road Train station with excellent links to both Liverpool and Southport. Beautiful local parks, golf courses are all on hand whilst Crosby village and local shops are a short walk away. The neutrally decorated apartment is ideal for any buyer wanting bright and airy spaces and good sized rooms.

- Available With No Onward Chain
- Two Double Bedrooms
- Close To Local Amenities And Transport Links

The property briefly comprises of communal entrance hallway, private entrance with cloaks area, open plan lounge with modern kitchen/breakfast room off. Two good sized bedrooms and modern bathroom. Communal gardens. The property has been installed with UPVC double glazing and a gas fired central heating system has been installed. garage and parking.

Viewing

Please contact our Michael Moon Office on 0151 924 1000 if you wish to arrange a viewing appointment for this property or require further information.



2



1



1



C

Floor Plan

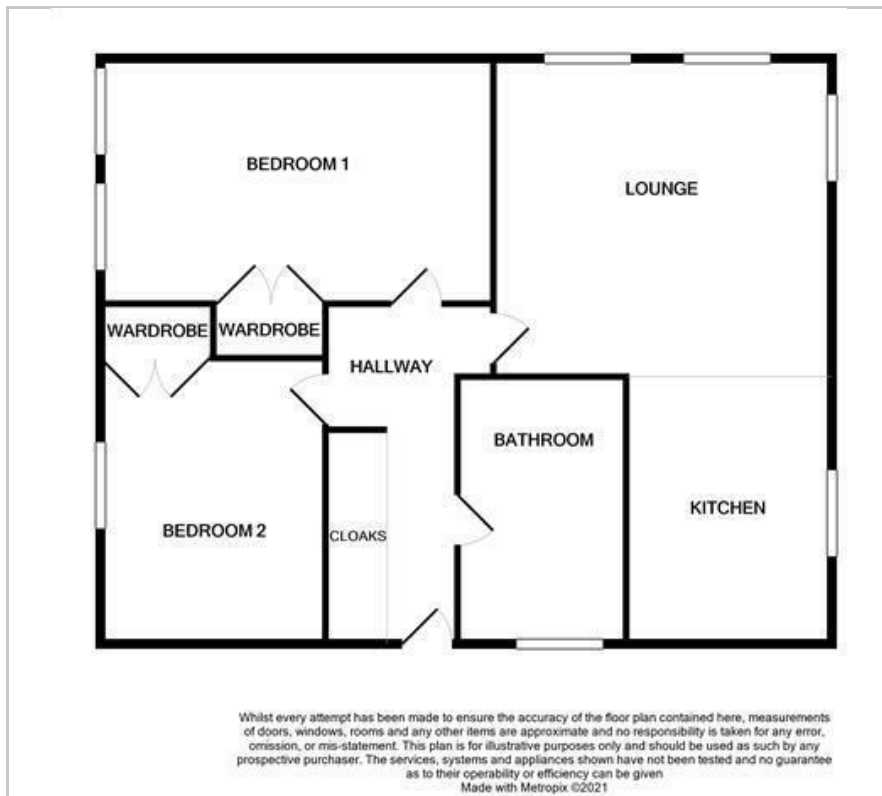

Area Map



Energy Efficiency Graph

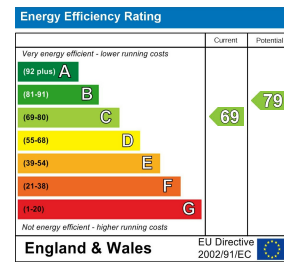

These particulars, whilst believed to be accurate are set out as a general outline only for guidance and do not constitute any part of an offer or contract. Intending purchasers should not rely on them as statements of representation of fact, but must satisfy themselves by inspection or otherwise as to their accuracy. No person in this firm's employment has the authority to make or give any representation or warranty in respect of the property.