

PULLEN

ESTATE AGENTS



Kyrle House Orpington Road

, Chislehurst, BR7 6RA

£1,600,000

An opportunity to acquire a substantial five/six bedroom detached residence, located on the highly sought-after Orpington Road.

The property now requires comprehensive modernisation but offers significant potential for refurbishment, reconfiguration or redevelopment (subject to the usual consents). Set on an impressive plot extending to over 230ft in length (as per original documentation), the house provides generous proportions and scope to create a bespoke family home.

Due to the current condition, internal viewings are limited and further information is available on request. Interested parties are encouraged to contact us directly to discuss the potential and viewing arrangements.

- In need of modernisation
- Approx. overall area over 2600 sq ft
- Plot measuring 232ft long according to land registry.
- Huge potential
- Envious plot on the ever popular Orpington Road

Viewing

Please contact our Chislehurst Office on 02034899589 if you wish to arrange a viewing appointment for this property or require further information.



6



2



null



F

Floor Plan

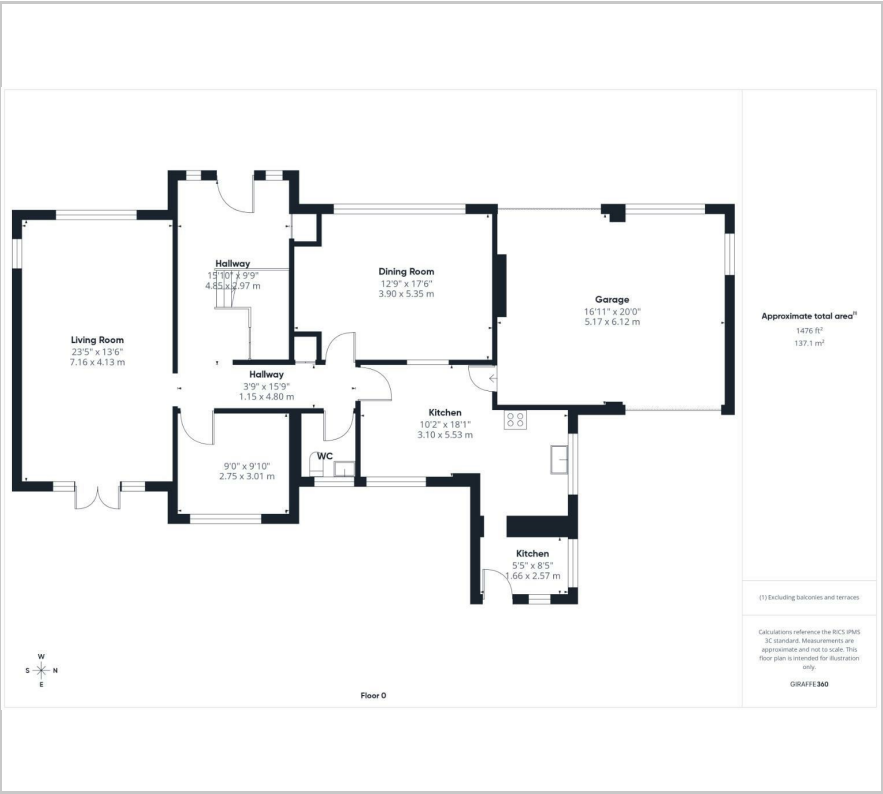

Area Map



Energy Efficiency Graph

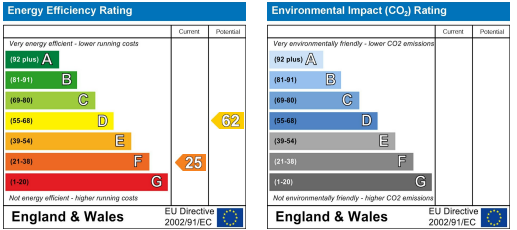

These particulars, whilst believed to be accurate are set out as a general outline only for guidance and do not constitute any part of an offer or contract. Intending purchasers should not rely on them as statements of representation of fact, but must satisfy themselves by inspection or otherwise as to their accuracy. No person in this firms employment has the authority to make or give any representation or warranty in respect of the property.