

# PULLEN

ESTATE AGENTS



## 11 Broadcroft Road

Petts Wood, Orpington, BR5 1ET

**Guide price £650,000**

GUIDE PRICE £650,000 to £675,000

This well presented, 1930s built semi-detached house is perfectly situated for Crofton & Darrick Wood schools, with two mainline stations (Petts Wood & Orpington) serving an array of London termini. The property also offers potential to extend further, STPP, and by converting the current loft space.

- Southerly facing garden
- Ideally located for Crofton & Darrick Wood schools
- Access to Petts Wood & Orpington mainline stations
- Extended
- Off street parking
- Recently renovated
- Sparrow Woods close by
- Open plan reception rooms
- Beautifully presented throughout

### Viewing

Please contact our Chislehurst Office on 02034899589 if you wish to arrange a viewing appointment for this property or require further information.



3



1



2



D



Floor Plan

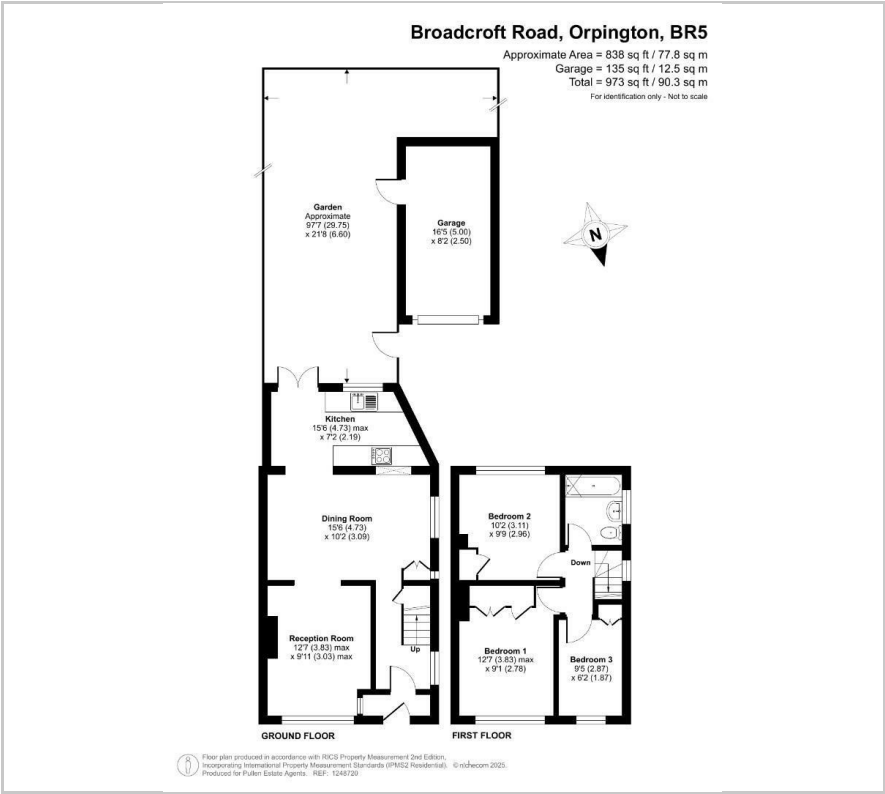

Area Map



Energy Efficiency Graph

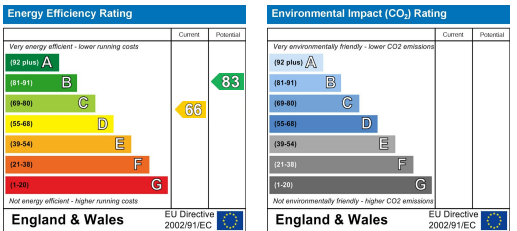

These particulars, whilst believed to be accurate are set out as a general outline only for guidance and do not constitute any part of an offer or contract. Intending purchasers should not rely on them as statements of representation of fact, but must satisfy themselves by inspection or otherwise as to their accuracy. No person in this firms employment has the authority to make or give any representation or warranty in respect of the property.