

PULLEN

ESTATE AGENTS



18 Postmill Close

Croydon, CR0 5DY

Guide price £775,000

GUIDE PRICE £775,000 to £800,000

Nestled within the prestigious and highly sought-after Postmill Close, a tranquil cul-de-sac renowned for housing the iconic Shirley Windmill, is this exceptional four bedroom, double-fronted detached house. The property boasts off street parking, a double garage and a generous, mainly laid to lawn garden which backs onto Shirley Park Golf Club. Further highlights include the ensuite shower room and utility room.

- Four bedroom, two bathroom detached house
- Cul-de-sac
- Double garage
- Off street parking
- Garden backing onto Shirley Park Golf Club
- Master bedroom with ensuite shower room
- Utility room

Viewing

Please contact our Chislehurst Office on 02034899589 if you wish to arrange a viewing appointment for this property or require further information.



Floor Plan

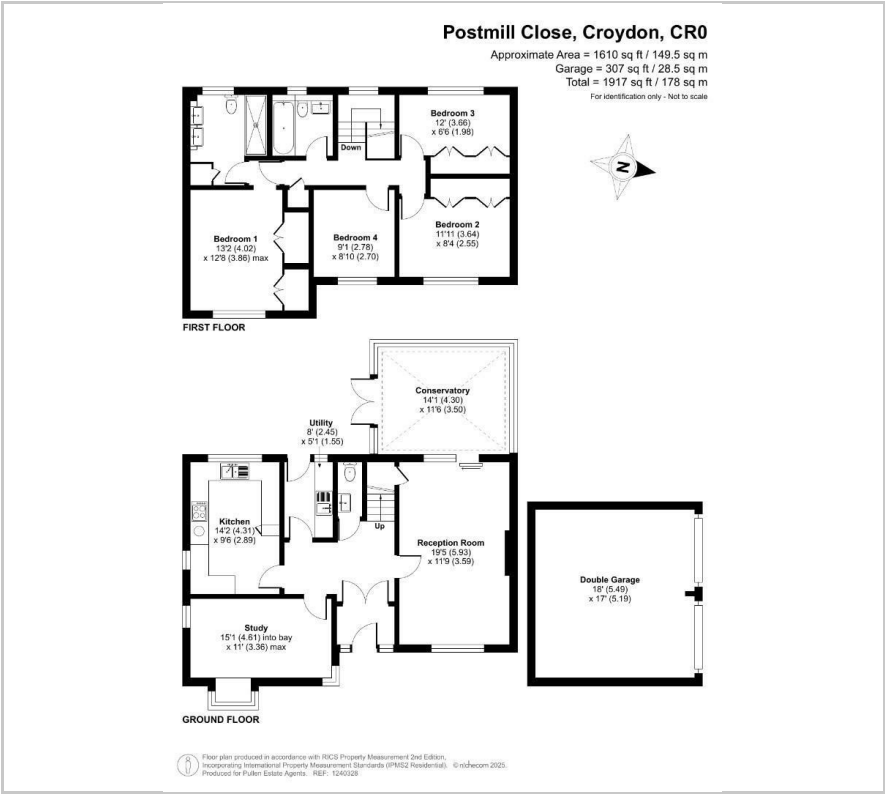

Area Map



Energy Efficiency Graph

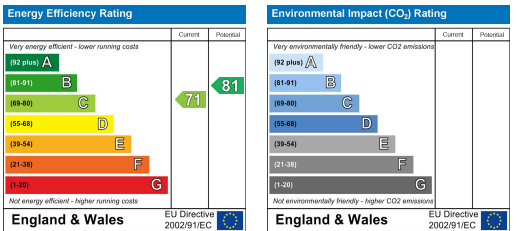

These particulars, whilst believed to be accurate are set out as a general outline only for guidance and do not constitute any part of an offer or contract. Intending purchasers should not rely on them as statements of representation of fact, but must satisfy themselves by inspection or otherwise as to their accuracy. No person in this firms employment has the authority to make or give any representation or warranty in respect of the property.