

PULLEN

ESTATE AGENTS



Flat 18, Hornbeam House Manor Road

, Sidcup, DA15 7JA

Guide price £325,000

GUIDE PRICE £325,000 to £335,000

Situated in the ever-popular Manor Road is this extremely well presented, split level, two bedroom apartment. The property boasts a private balcony, underground parking and a lease length in excess of 900 years.

- Private balcony
- Owner occupier only
- 0.3 miles from Sidcup mainline station
- Allocated, underground parking
- Lease length in excess of 900 years

Viewing

Please contact our Chislehurst Office on 02034899559 if you wish to arrange a viewing appointment for this property or require further information.



Floor Plan

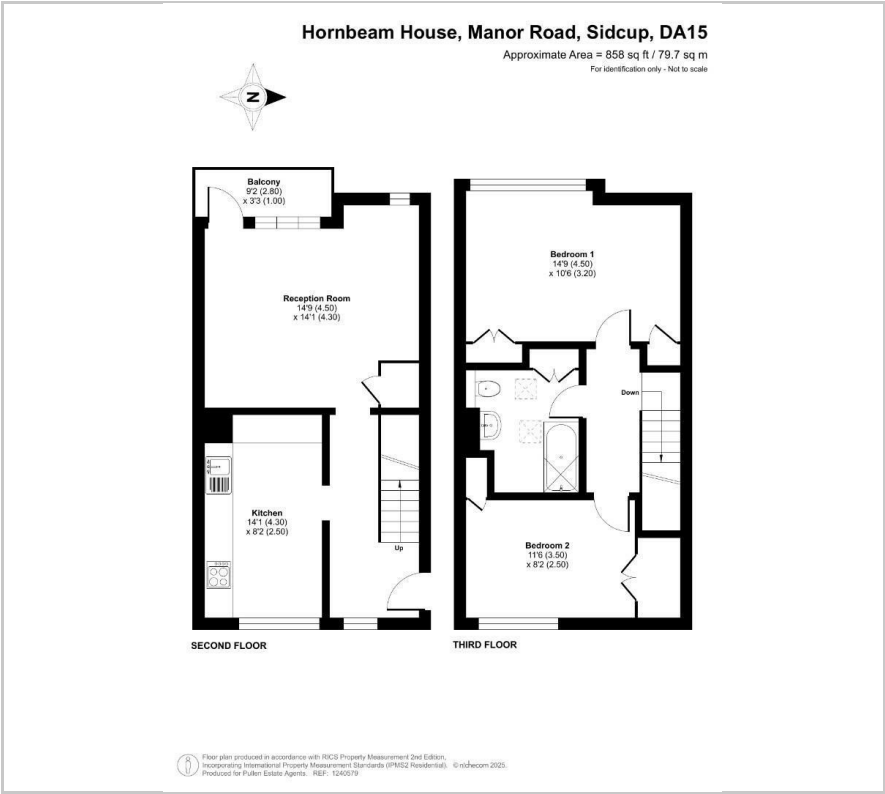

Area Map



Energy Efficiency Graph

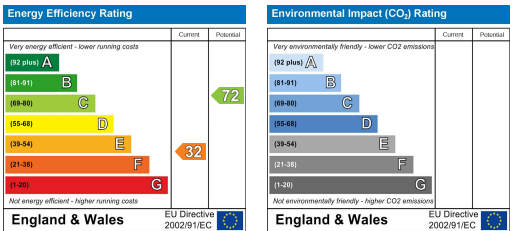

These particulars, whilst believed to be accurate are set out as a general outline only for guidance and do not constitute any part of an offer or contract. Intending purchasers should not rely on them as statements of representation of fact, but must satisfy themselves by inspection or otherwise as to their accuracy. No person in this firm's employment has the authority to make or give any representation or warranty in respect of the property.