

# PULLEN

ESTATE AGENTS



## 2 St. Matthews Drive

, Bromley, BR1 2LH

£825,000

In need of modernisation is this three bedroom detached bungalow, situated on the ever popular St Matthews Drive. This spacious property offers fantastic potential to improve and it's enviable location offers access to both Bickley & Chislehurst stations, serving an array of London termini. A number of highly regarded schools, including Bullers Wood Girls & Boys, Bickley and Bromley High.

- Detached
- Prime road
- Access to Stations & schools
- Two garages
- Lawned garden & Court yard area
- Off street parking

### Viewing

Please contact our Chislehurst Office on 02034899589 if you wish to arrange a viewing appointment for this property or require further information.





Floor Plan

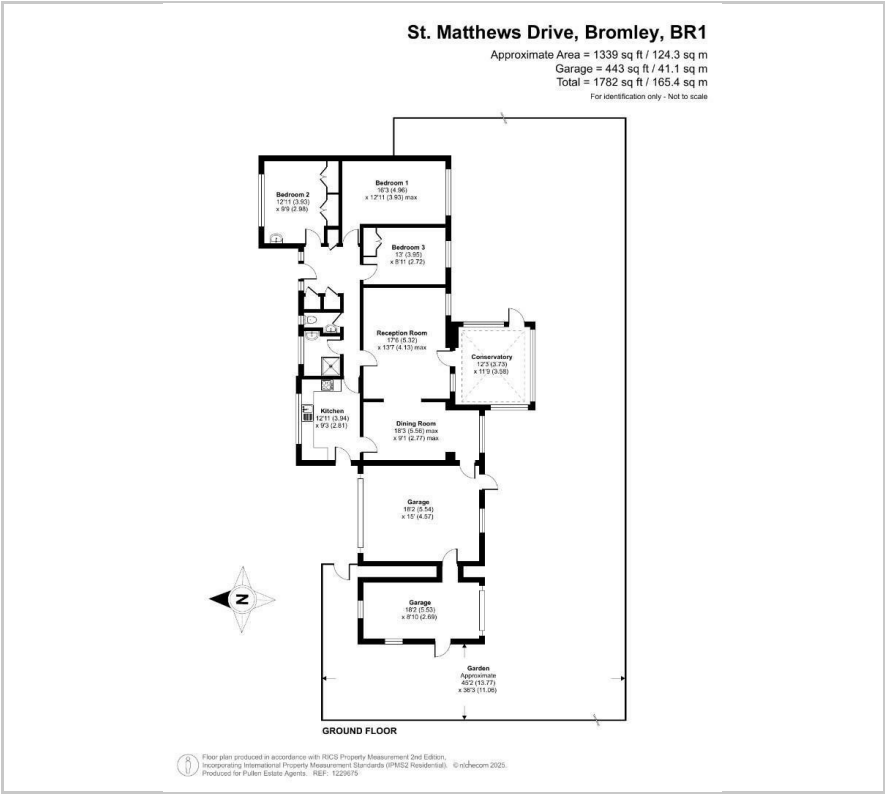

Area Map

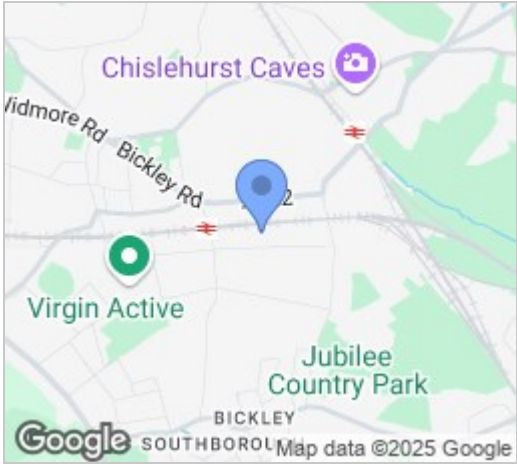

Energy Efficiency Graph

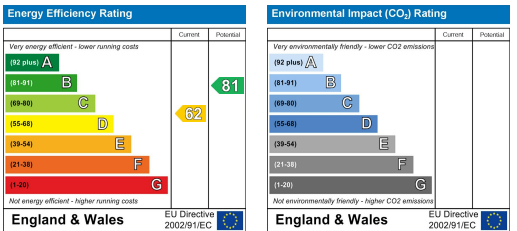

These particulars, whilst believed to be accurate are set out as a general outline only for guidance and do not constitute any part of an offer or contract. Intending purchasers should not rely on them as statements of representation of fact, but must satisfy themselves by inspection or otherwise as to their accuracy. No person in this firms employment has the authority to make or give any representation or warranty in respect of the property.