

PULLEN

ESTATE AGENTS



120* Leeson's Hill

, Orpington, BR5 2NH

£750,000

Nestled in the desirable area of Leeson's Hill, Orpington, this impressive five-bedroom detached house offers a spacious and comfortable living environment, measuring over 2300 square feet. I

The location is particularly advantageous, being in close proximity to St Mary Cray mainline station, which provides excellent transport links for commuters. Additionally, the area is served by a number of highly regarded local schools, making it an excellent choice for families with children.

For those who enjoy shopping and leisure activities, the Nugent Shopping Centre is easily accessible, offering a variety of retail options and amenities. Furthermore, the property benefits from quick access to the M25, facilitating travel to London and beyond.

The property also boasts planning permission for the property to be split into two semi detached houses.

- Five bedroom detached house
- Planning permission to convert the current property into two semi detached houses
- Ideal family home to improve with a bonus investment opportunity
- Access to stations and schools

Viewing

Please contact our Chislehurst Office on 02034899589 if you wish to arrange a viewing appointment for this property or require further information.



5



2



null



F

Floor Plan

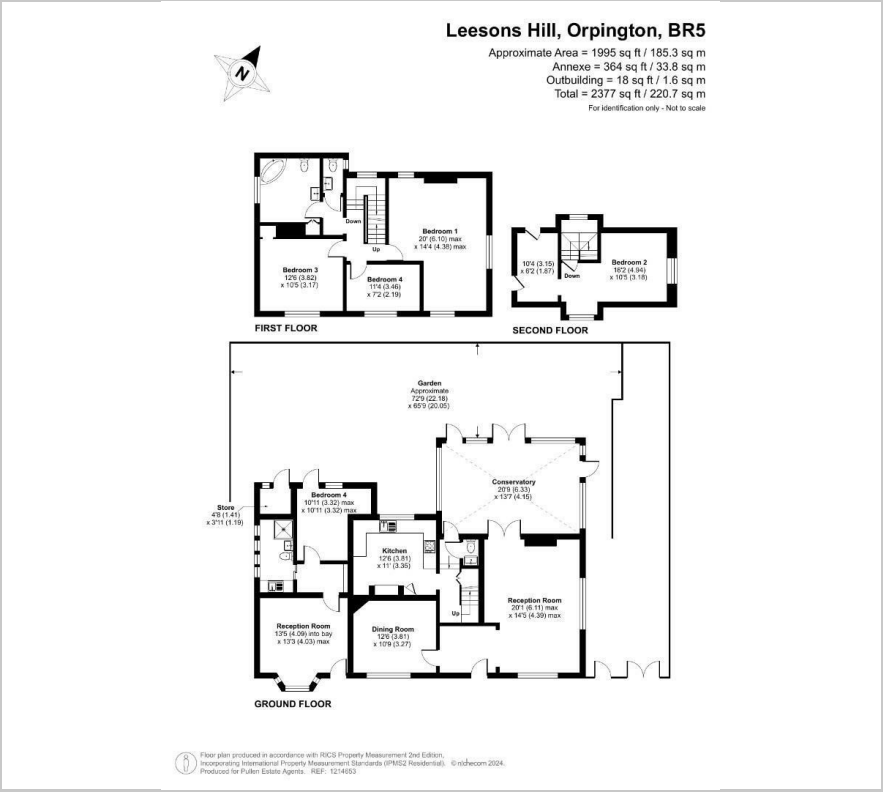

Area Map



Energy Efficiency Graph

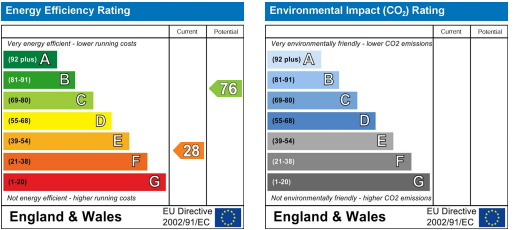

These particulars, whilst believed to be accurate are set out as a general outline only for guidance and do not constitute any part of an offer or contract. Intending purchasers should not rely on them as statements of representation of fact, but must satisfy themselves by inspection or otherwise as to their accuracy. No person in this firms employment has the authority to make or give any representation or warranty in respect of the property.