

## 41 Marlings Park Avenue

, Chislehurst, BR7 6RD

£1,500,000

CHAIN FREE

Situated on a popular residential road is this five bedroom, three bathroom detached house which is situated behind gates and boasts an impressive, mainly laid to lawn garden. Marlings Park Avenue remains ever popular with its access to National Trust Woodlands, mainline stations serving several London termini, a number of highly regarded schools and access to Petts Wood and Chislehurst High Streets.

- Chain free
- Impressive garden
- Gated carriage driveway
- Stoneham kitchen

### Viewing

Please contact our Chislehurst Office on 02034899589 if you wish to arrange a viewing appointment for this property or require further information.



null



D

# Floor Plan

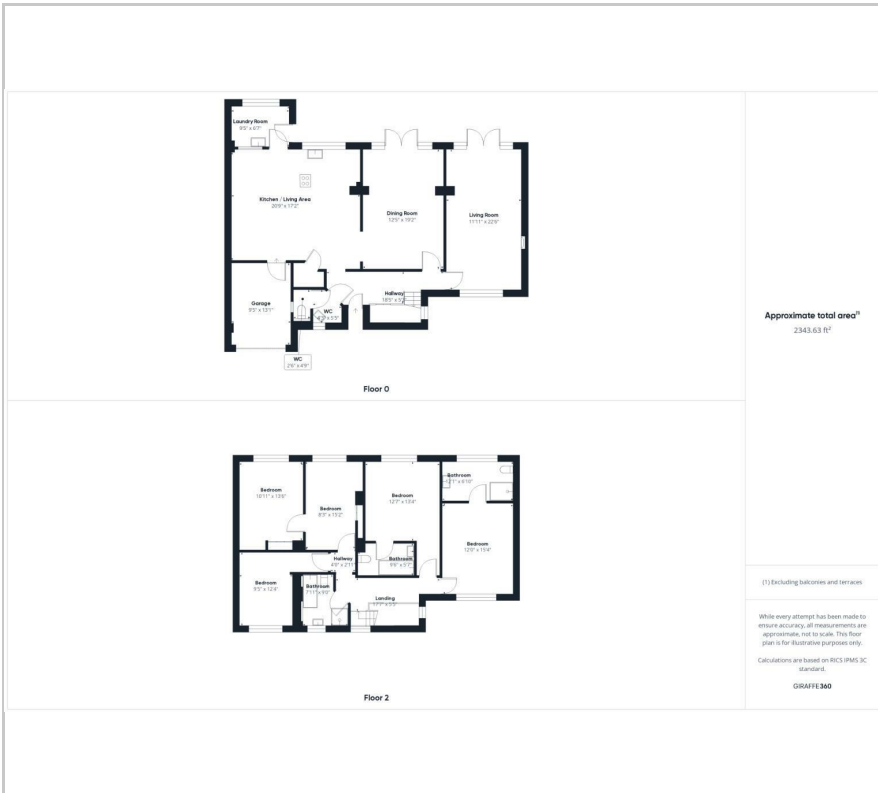

# Area Map



# Energy Efficiency Graph

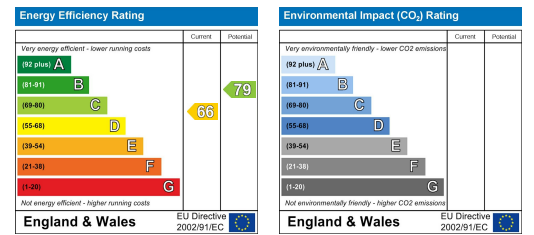

These particulars, whilst believed to be accurate are set out as a general outline only for guidance and do not constitute any part of an offer or contract. Intending purchasers should not rely on them as statements of representation of fact, but must satisfy themselves by inspection or otherwise as to their accuracy. No person in this firm's employment has the authority to make or give any representation or warranty in respect of the property.