

PULLEN

ESTATE AGENTS



55 Holburne Road

London, SE3 8HH

Offers in excess of £425,000

COMPLETE ONWARD CHAIN

Pullen Estate Agents are delighted to offer to the market this extremely well presented, two bedroom terrace house. The property is conveniently located for Kidbrooke mainline station, offering fast services into London Bridge in 16 minutes. A number of popular local schools can also be found locally along with the prestigious Kidbrooke Village, Blackheath Village and green open space, including Hornfair Park, Charlton House, Oxleas Woods, Shrewsbury Park, Blackheath Common and Greenwich Park.

Viewing

Please contact our Chislehurst Office on 02034899589 if you wish to arrange a viewing appointment for this property or require further information.

- Rear garden measuring over 80ft long
- Complete onward chain
- Envious location
- Convenient for Kidbrooke mainline station
- Two double bedrooms

 2  1  null  D

Floor Plan

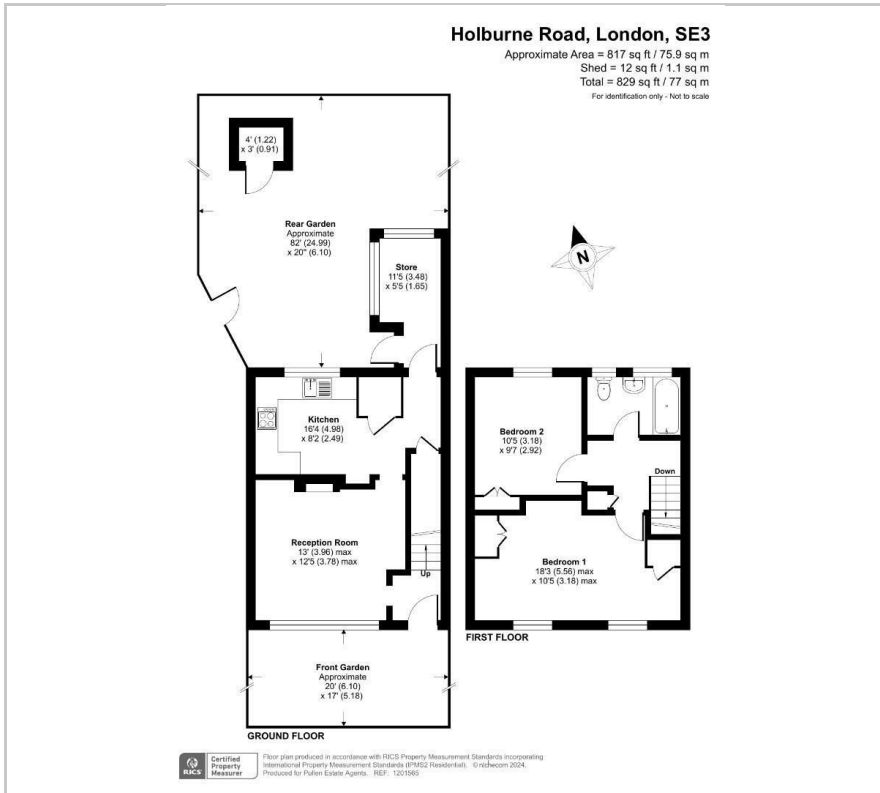

Area Map



Energy Efficiency Graph

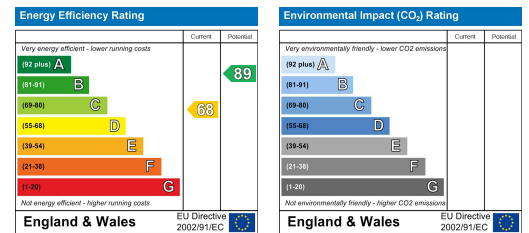

These particulars, whilst believed to be accurate are set out as a general outline only for guidance and do not constitute any part of an offer or contract. Intending purchasers should not rely on them as statements of representation of fact, but must satisfy themselves by inspection or otherwise as to their accuracy. No person in this firm's employment has the authority to make or give any representation or warranty in respect of the property.