

# PULLEN

ESTATE AGENTS



## 52 Great Thrift

Petts Wood, Orpington, BR5 1NG

£995,000

CHAIN FREE

Pullen Estate agents are delighted to offer to the market this well presented, five bedroom semi detached house in the sought after Great Thrift, Petts Wood East. The enviable location remains ever popular with its access to Petts Wood mainline station, a number of highly regarded local schools and National Trust Woodlands

- Petts Wood East
- Extended
- Five bedrooms
- 111ft long garden (approx.)
- Southerly facing garden
- Garage and off street parking
- Potential to extend, STPP

### Viewing

Please contact our Chislehurst Office on 02034899589 if you wish to arrange a viewing appointment for this property or require further information.



null



E

## Floor Plan

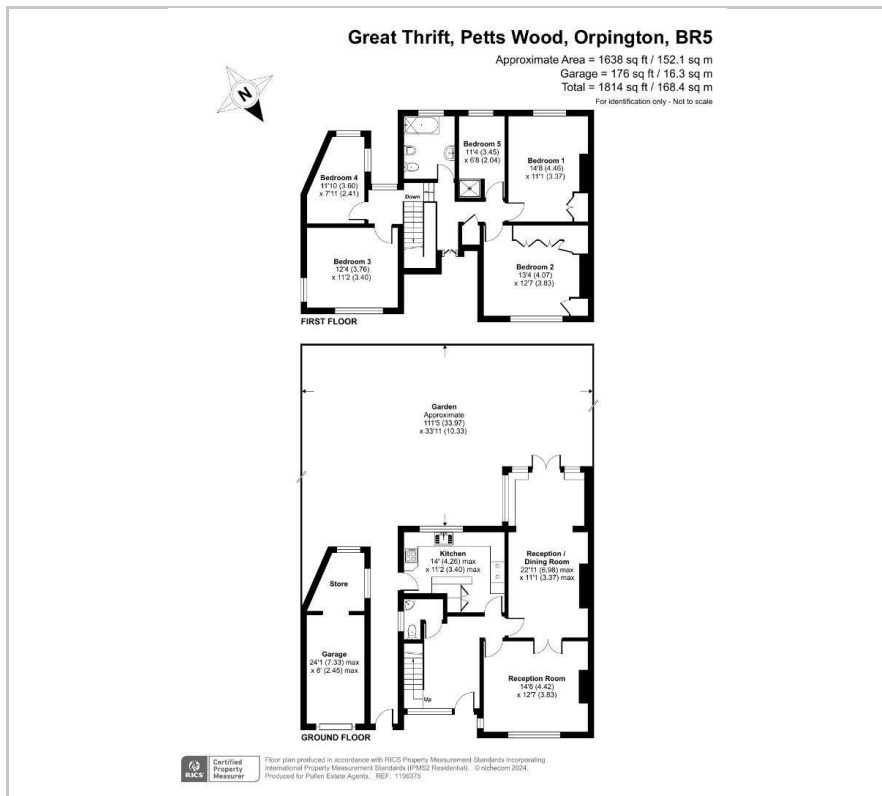

## Area Map



## Energy Efficiency Graph

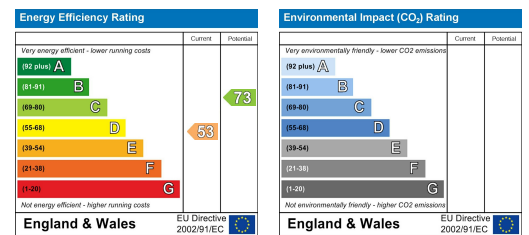

These particulars, whilst believed to be accurate are set out as a general outline only for guidance and do not constitute any part of an offer or contract. Intending purchasers should not rely on them as statements of representation of fact, but must satisfy themselves by inspection or otherwise as to their accuracy. No person in this firm's employment has the authority to make or give any representation or warranty in respect of the property.