

PULLEN

ESTATE AGENTS



43 - 45 Oakley Road

Bromley, BR2 8HD

Guide price £600,000

GUIDE PRICE £600,000 to £625,000

Pullen Estate Agents are delighted to present this Charming three double bedroom period cottage to the market. The property boasts bags of character with its double fronted exterior, cast iron fireplaces and beams throughout all maintained in excellent condition.

- Three Double Bedrooms
- Two bathrooms
- Period features throughout
- Large easterly facing garden
- Close proximity to Ravenswood School

Viewing

Please contact our Chislehurst Office on 02034899589 if you wish to arrange a viewing appointment for this property or require further information.



null



E

Floor Plan

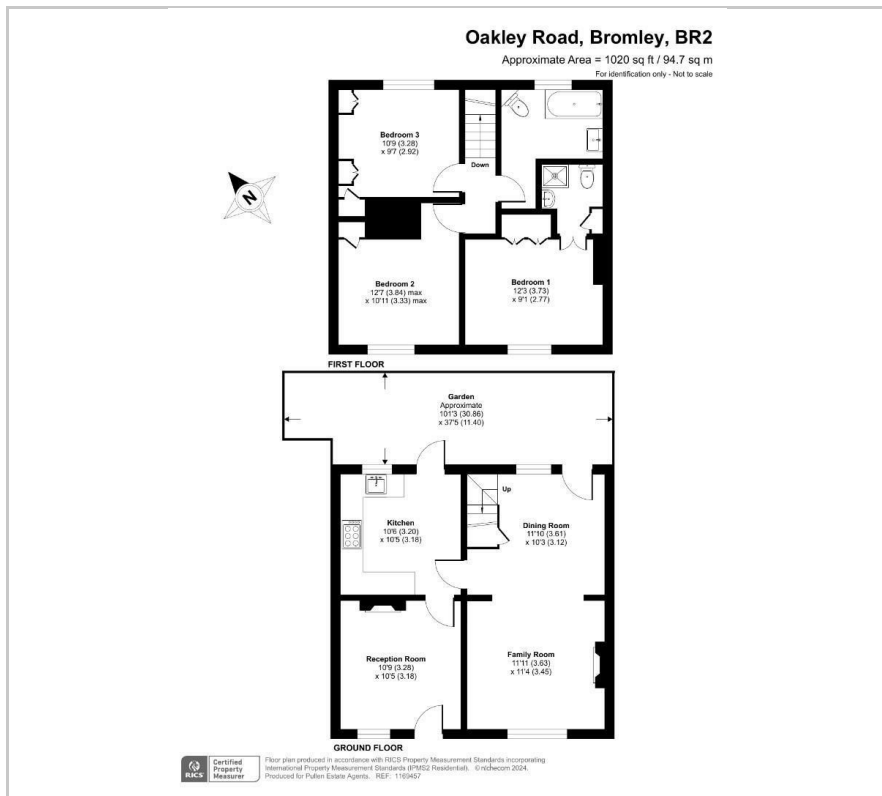

Area Map

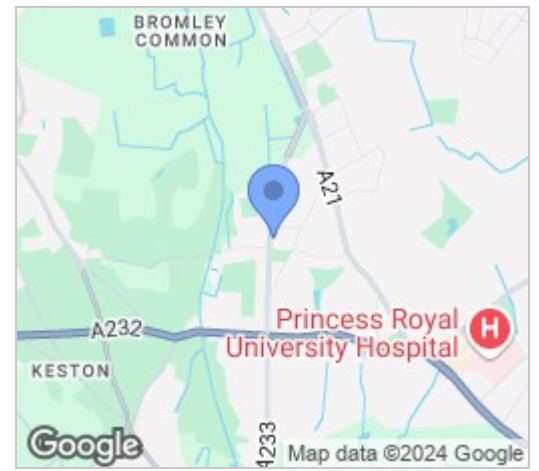

Energy Efficiency Graph

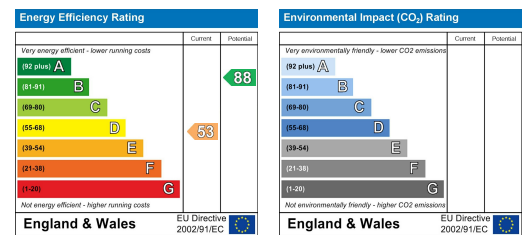

These particulars, whilst believed to be accurate are set out as a general outline only for guidance and do not constitute any part of an offer or contract. Intending purchasers should not rely on them as statements of representation of fact, but must satisfy themselves by inspection or otherwise as to their accuracy. No person in this firm's employment has the authority to make or give any representation or warranty in respect of the property.