



## Flat 1 The Chilterns Murray Avenue

, Bromley, BR1 3DT

£525,000

Having undergone an extensive programme of refurbishment is this rarely available three bedroom, two bathroom ground floor apartment set within a private development of only 15 flats in the heart of Bromley. The enviable location is ideal for both Bromley North and South stations, a number of highly regarded local schools as well as the popular Glades Shopping Centre.

- Chain Free
- Stunning open plan kitchen with integrated appliances
- Off Street Parking
- Private Garage
- Balcony
- Ground floor
- Two bathrooms
- Share of freehold

### Viewing

Please contact our Chislehurst Office on 02034899589 if you wish to arrange a viewing appointment for this property or require further information.



3



2



null



C

# Floor Plan

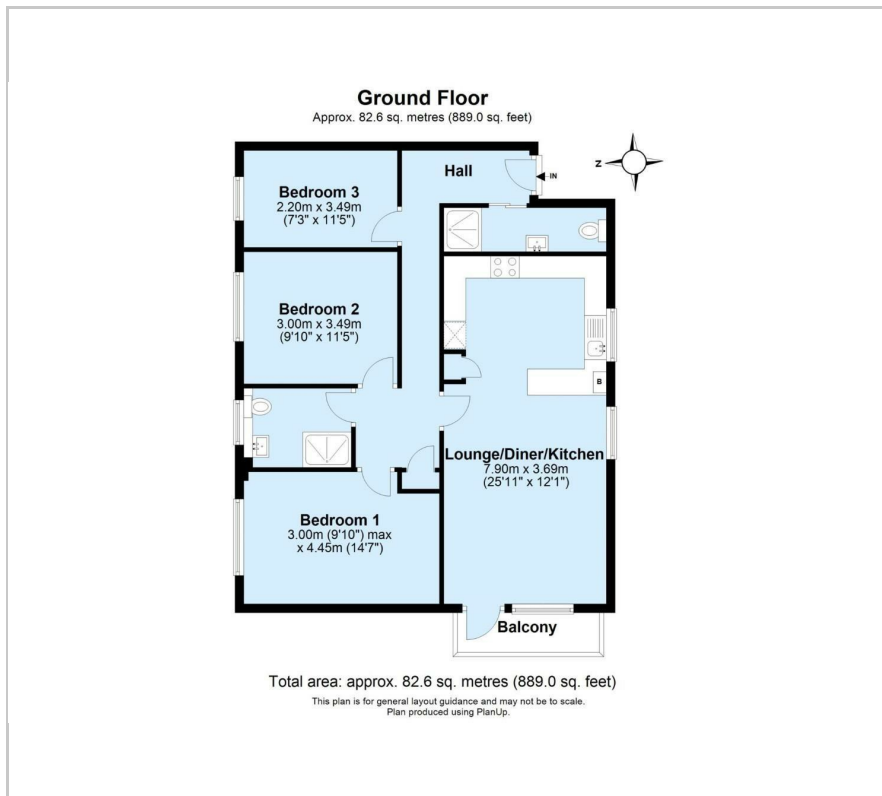

# Area Map



# Energy Efficiency Graph

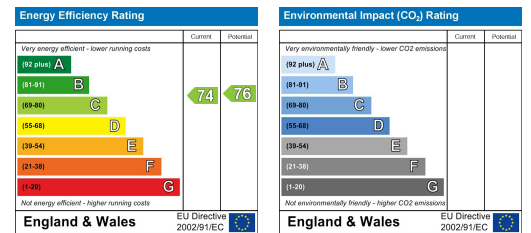

These particulars, whilst believed to be accurate are set out as a general outline only for guidance and do not constitute any part of an offer or contract. Intending purchasers should not rely on them as statements of representation of fact, but must satisfy themselves by inspection or otherwise as to their accuracy. No person in this firm's employment has the authority to make or give any representation or warranty in respect of the property.