



Flat 3, Cubitt House, 18 Waterman Way

Wouldham, Rochester, ME1 3FY

Guide price £290,000

GUIDE PRICE £290,000 to £300,000

Situated in the picturesque St Peters Village is this impressive, two double bedroom, two bathroom apartment boasting an abundance of natural light and viewings over The River Medway.

The enviable location offers access to Snodland and Halling stations, as well as several popular local schools. St Peters Village is under a 5-minute walk (according to Google Maps) and has an array of local shops, Village Hall and doctors' surgery which is under construction.

Viewing

Please contact our Chislehurst Office on 02034899589 if you wish to arrange a viewing appointment for this property or require further information.

- Built in 2019
- Ensuite to master bedroom
- Modern interior throughout
- Stunning viewings of the River Medway
- Allocated parking
- EPC - B



Floor Plan

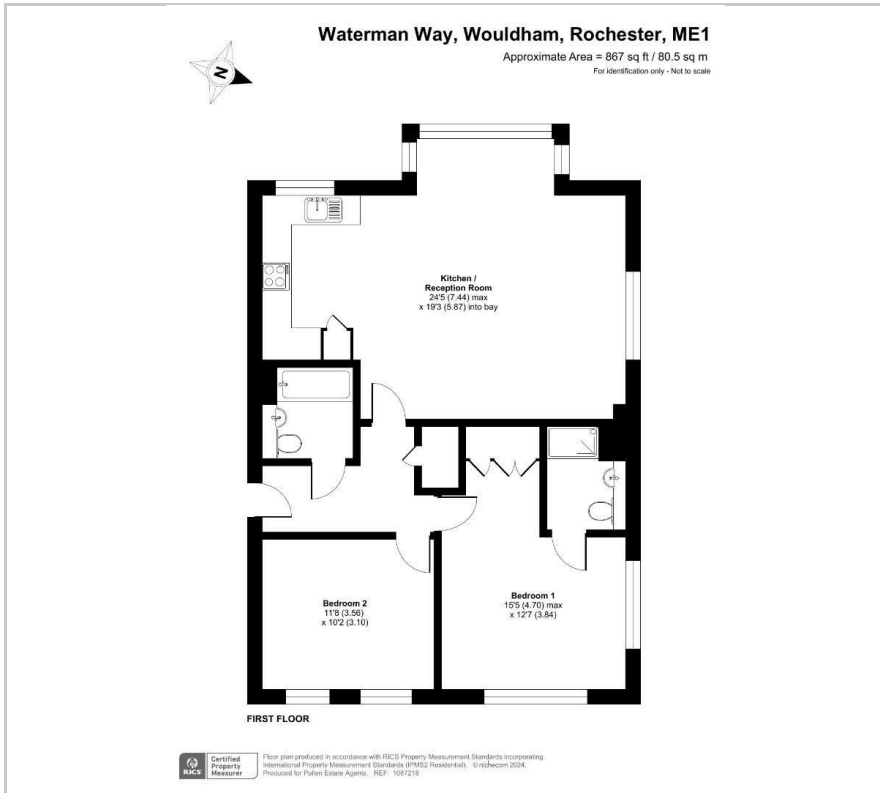

Area Map



Energy Efficiency Graph

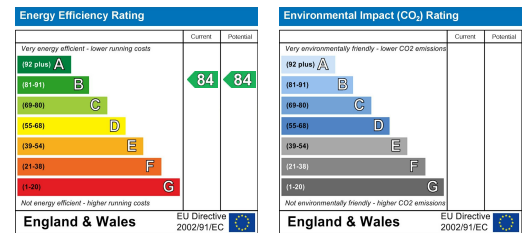

These particulars, whilst believed to be accurate are set out as a general outline only for guidance and do not constitute any part of an offer or contract. Intending purchasers should not rely on them as statements of representation of fact, but must satisfy themselves by inspection or otherwise as to their accuracy. No person in this firm's employment has the authority to make or give any representation or warranty in respect of the property.