



11 Dawson Close
Newborough PE6 7SJ
£215,000

11 Dawson Close Newborough PE6 7SJ

Ideal first purchase property, semi detached house on Dawsons Close, a popular road in Newborough.

This property comprises of;

Ground Floor- entrance hall, lounge with understairs cupboard, kitchen/diner with double doors to the garden.

First Floor- landing, three bedrooms and a family bathroom.

Outside- lawned front garden, covered drive with side access. To the rear, an enclosed rear garden, mainly laid to lawn.

This property is tenanted and will need 48 hours notice for viewings.

This property is within easy reach of all Newborough has to offer and a short drive to Peterborough.

Tenure: Freehold
Council Tax Band: B



Ground Floor

Entrance Hall

Lounge

13'1" x 10'4" (4.0m x 3.15m)

Kitchen/Diner

16'5" x 8'7" (5.01m x 2.64m)

First Floor

Landing

Bedroom One

11'0" x 9'5" (3.36m x 2.88m)

Bedroom Two

9'5" x 8'2" (2.89m x 2.51m)

Bedroom Three

7'11" x 7'1" (2.42m x 2.16m)

Family Bathroom



Floor Plan

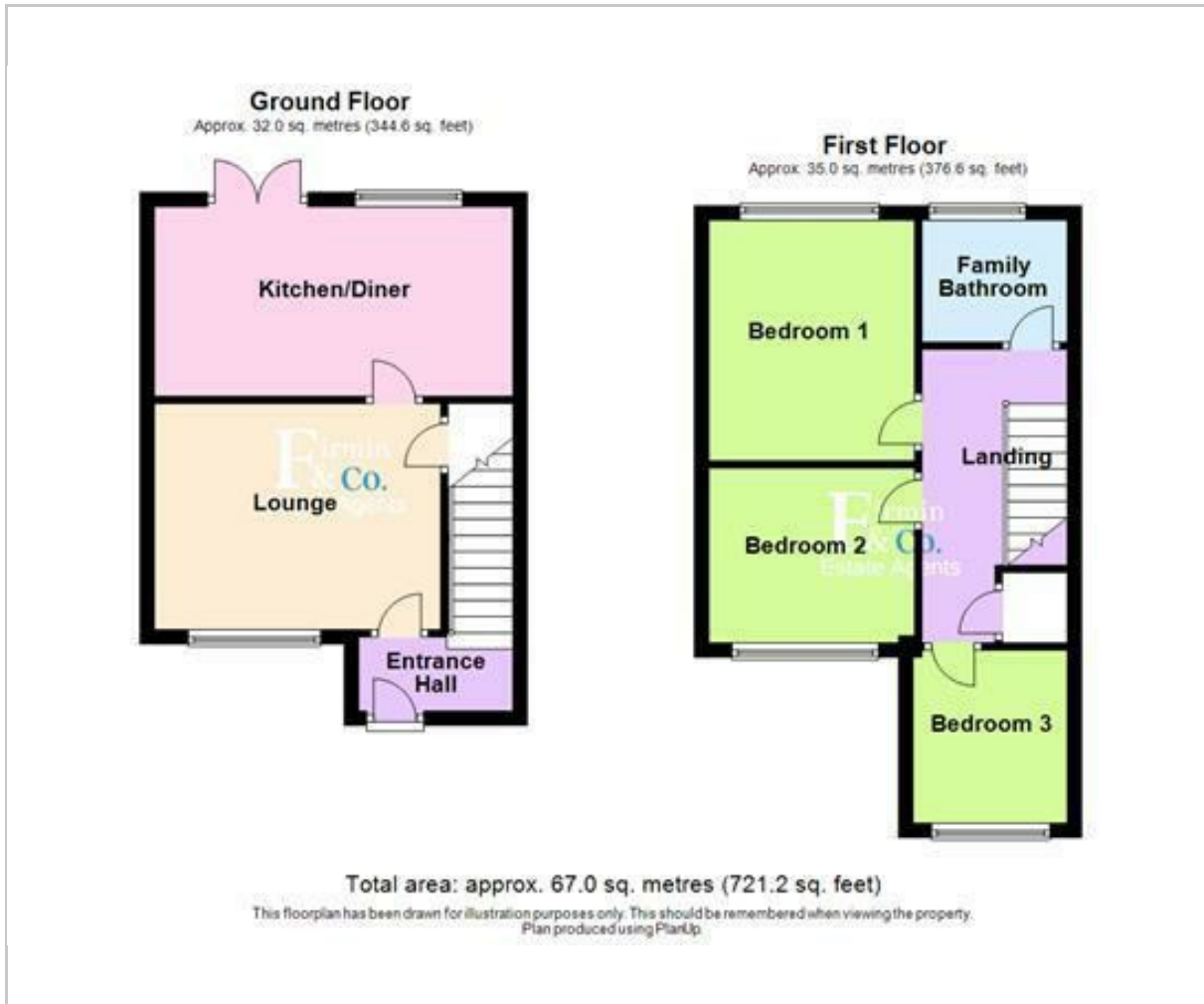

Viewing

Please contact our Crowland Office on 01733 259995 if you wish to arrange a viewing appointment for this property or require further information.

These particulars, whilst believed to be accurate are set out as a general outline only for guidance and do not constitute any part of an offer or contract. Intending purchasers should not rely on them as statements of representation of fact, but must satisfy themselves by inspection or otherwise as to their accuracy. No person in this firm's employment has the authority to make or give any representation or warranty in respect of the property.



9 North Street,
Crowland, PE6 0EG
T: 01733 259995
E: crowland@firminandco.co.uk

Area Map

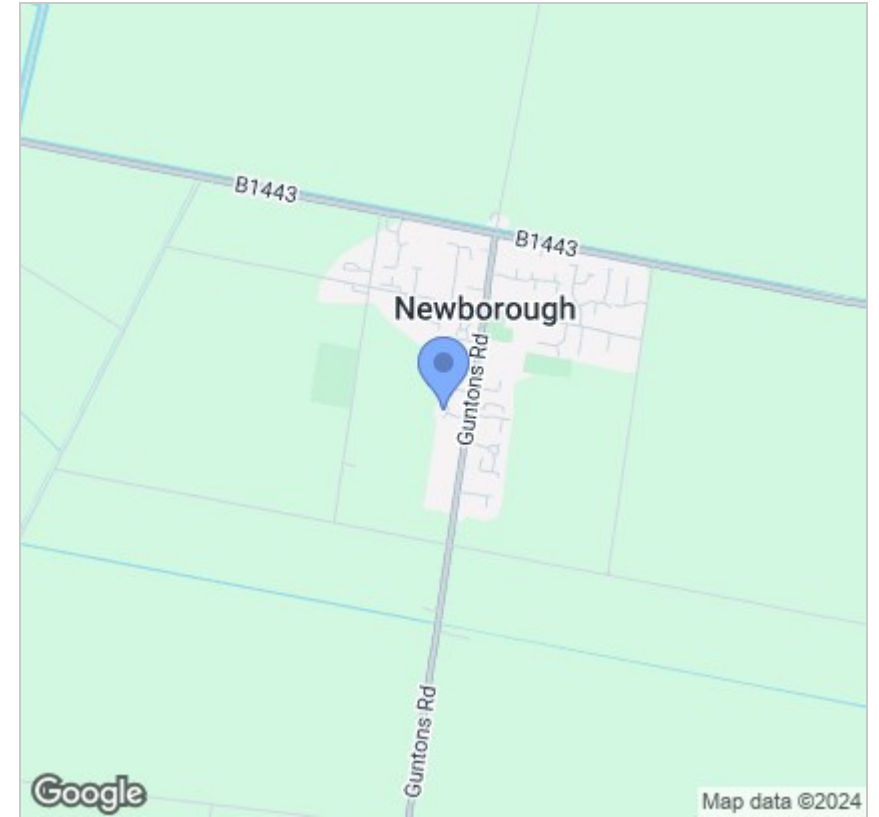

Energy Efficiency Graph

