



158 Shearwater Road, Stockport, SK2 5XA

Harratts Property Services is delighted to present a great opportunity to acquire this three-bedroom end-of-terrace home, prominently situated on Shearwater Road in the highly sought-after area of Offerton, nestled within the esteemed Beanleach Estate. This area is particularly desirable as it falls within the catchment zone for the well-regarded Warren Wood Primary School, making it an ideal choice for families seeking quality education for their children.

Upon entering the residence, you are welcomed into the entrance hallway leading into a spacious living room providing ample space for family gatherings and cosy evenings. Adjacent to the living room is a separate kitchen/diner located at the rear of the property. This space is thoughtfully designed and offers a view of the patio garden.

Moving to the second floor, you will discover three well-appointed bedrooms. Two of these bedrooms are generously sized doubles, offering plenty of room for furnishings and personal touches, while the third bedroom is also a good size. Completing the upper level is a family bathroom, thoughtfully designed to cater to the needs of the household.

This property boasts practical features that enhance its appeal. Off-road parking is available, providing convenience

- Three Bedroom End Of Terrace House
- Three Good Sized Bedrooms
- Offroad Parking
- Detached Garage
- Catchment Zone For Warren Wood Primary School
- Highly Sough After Location

£240,000

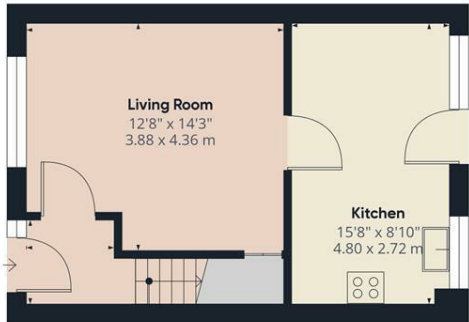

Hallway
4'9" x 4'10"
1.46 x 1.49 m

Floor 0 Building 1

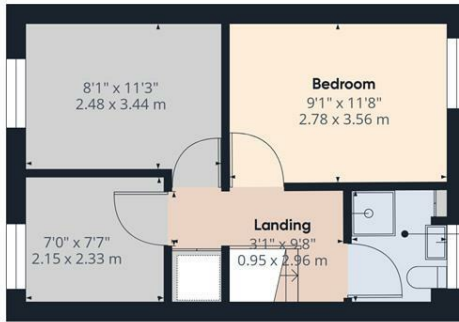

Bathroom
6'8" x 5'5"
2.04 x 1.66 m

Floor 1 Building 1



Floor 0 Building 2

Approximate total area⁽¹⁾
828.5 ft²
76.97 m²

(1) Excluding balconies and terraces

While every attempt has been made to ensure accuracy, all measurements are approximate, not to scale. This floor plan is for illustrative purposes only.

Calculations are based on RICS IPMS 3C standard.

GIRAFFE360

