



## 26 Park Lane, Stockport, SK1 4JS

Harratts Property Services is pleased to introduce to the open market this exceptional two-bedroom terraced property, conveniently located within walking distance of Woodbank Park and local amenities.

Upon entering, you are greeted by an entrance porch that leads into a spacious lounge/dining area. At the rear of the property, you will find an additional reception room, which offers versatility for your personal use, along with a staircase leading to the first floor. The kitchen features a variety of eye-level and base units, providing a functional and inviting space for cooking and entertaining.

On the first floor, the property boasts two generously sized double bedrooms. Completing this level is a family bathroom suite equipped with a low-level WC, hand wash basin, bath, and a walk-in shower cubicle.

Internally, the home is enhanced by gas central heating and PVC double glazing, ensuring comfort throughout. Externally, the front of the property includes a garden, while the rear offers a stone-paved gated garden with convenient access to the back, the property also benefits from resident permit street parking.

To schedule a viewing please contact our office at 0161 791 1350.

- Two Double Bedroom Mid Terrace
- Two Reception Rooms
- Basement Provides Extra Storage
- Front And Rear Gardens
- Popular Location
- Close To Great Local Schools

**£220,000**

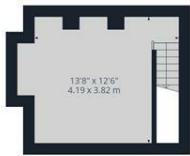

Floor -1



Floor 0

Approximate total area<sup>®</sup>  
889.96 ft<sup>2</sup>  
82.68 m<sup>2</sup>

(1) Excluding balconies and terraces

While every attempt has been made to ensure accuracy, all measurements are approximate, not to scale. This floor plan is for illustrative purposes only.

GIRAFFE360



Floor 1

