



## 11 Heathcote Gardens, Romiley, Stockport, SK6 4HG

Harratts Property Services Introduce this charming Home for Sale. Nestled in a peaceful walkway in Romiley, this home offers a tranquil retreat away from the hustle and bustle of passing traffic.

Step inside to discover the impressive features of this residence, including TWO spacious double bedrooms. The living room is thoughtfully designed to provide versatile space, allowing for both lounge and dining areas. Open the double doors and be greeted by a magnificent wooden decking, perfect for outdoor entertaining. Beyond lies a sprawling, well-maintained lawn, offering ample room for relaxation and recreation.

The kitchen is a room of grand proportions, providing an inviting space for culinary endeavors. As you ascend the turning stairs, you'll find yourself on the galleried landing, adding a touch of elegance to the property.

Outside, the property boasts beautifully tended gardens at both the front and rear. Additionally, the generous side space offers potential for future expansion, should additional accommodation be desired.

Don't miss the opportunity to view this exceptional property. Immediate viewing is essential please call us on 0161 7911350

- Two Double Bedrooms
- Front And Rear Garden (Not Overlooked)
- Popular Location
- Catchment Area For Great Local Schools
- Close To Local Amenities

**£215,000**



Floor 0

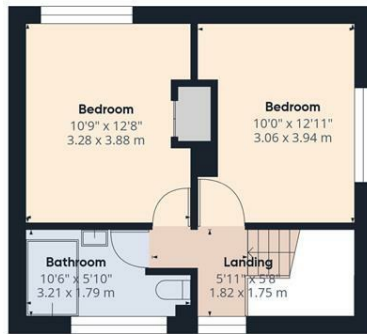

Floor 1

Approximate total area<sup>(1)</sup>  
729.53 ft<sup>2</sup>  
67.78 m<sup>2</sup>

Reduced headroom  
23.85 ft<sup>2</sup>  
2.22 m<sup>2</sup>

(1) Excluding balconies and terraces

☐ Reduced headroom  
(below 1.5m/4.92ft)

While every attempt has been made to ensure accuracy, all measurements are approximate, not to scale. This floor plan is for illustrative purposes only.

GIRAFFE 360

