



21 Crossfield Grove, Stockport, SK2 7EQ

Introducing an exceptional opportunity, Harratts Property Services presents this charming three-bedroom semi-detached family home nestled in a tranquil cul-de-sac. What sets this property apart is the absence of any vendor chain, allowing for a seamless purchase.

Upon entering the house you are greeted with a fair size hallway, then you have a spacious bay-fronted living room that exudes warmth and comfort. Adjacent to the living room is the inviting dining room, offering a delightful view of the rear garden through its patio doors. While the kitchen and bathroom require modernization, they present the perfect canvas for creating your dream spaces.

Situated in a highly regarded and convenient location, this home is in close proximity to esteemed educational institutions such as Stockport Grammar School and Great Moor Primary School. Additionally, Woodsmoor train station and local amenities are within walking distance, ensuring convenience and accessibility.

Spanning across two floors, this property provides ample living accommodation. The ground floor comprises an entrance hallway with a staircase leading to the first floor, a generously sized bay-fronted lounge, and a dining room with patio doors opening to the rear garden. Moving upstairs, the landing grants access to three well-proportioned

- *****NO CHAIN*****
- **Three Bedroom Semi Detached Home**
- **Close To Useful Transport Links, Popular Schools, Davenport, Bramhall Park and Local Amenities**
- **Set Within An Exclusive Cul-de-sac Within The Sought-after 'Woodsmoor'**
- **Front and Ample Rear Size Garden**
- **Driveway For Multiple Cars**

£300,000

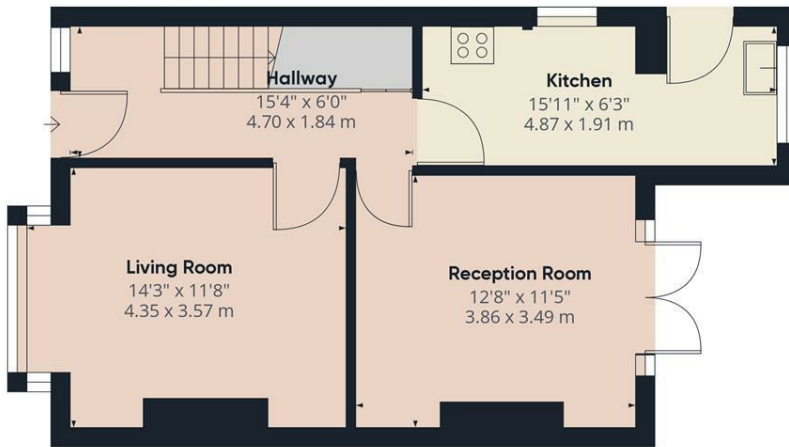

Floor 0

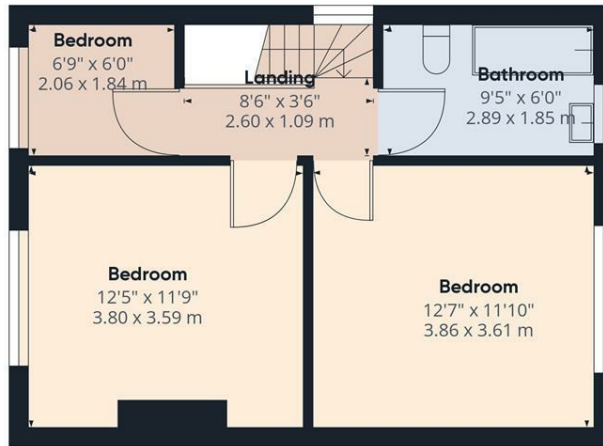

Floor 1

Approximate total area⁽¹⁾
929.02 ft²
86.31 m²

(1) Excluding balconies and terraces

While every attempt has been made to ensure accuracy, all measurements are approximate, not to scale. This floor plan is for illustrative purposes only.

GIRAFFE 360

