

GROUND FLOOR

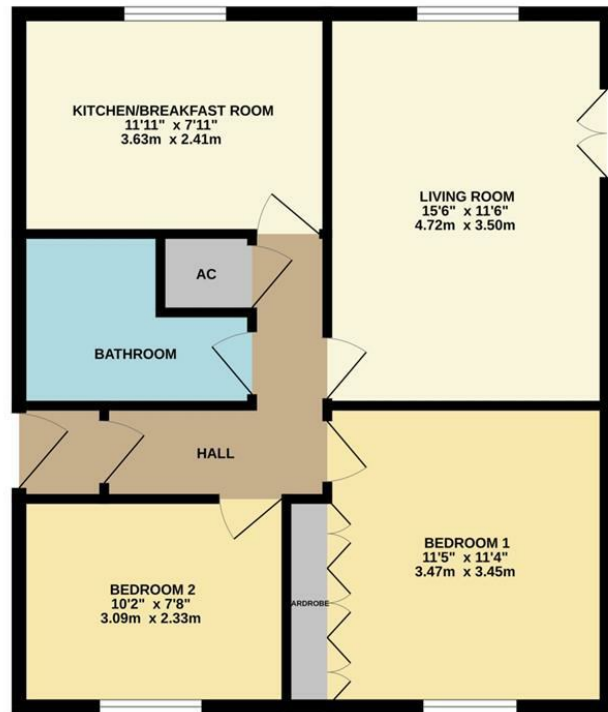

MALTINGS COURT, BREWERY ST, STRATFORD-UPON-AVON, CV37 0TJ

TOTAL FLOOR AREA: 646sq.ft. (60.0 sq.m.) approx.
While every attempt has been made to ensure the accuracy of the floorplans contained herein, measurements of doors, windows, rooms and any other items are approximate and no responsibility is taken for any error, omission or mis-statement. This plan is for illustrative purposes only and should be used as such by any prospective purchaser. The services, systems and appliances shown have not been tested and no guarantee as to their operability or efficiency can be given.
Made with Metropix ©2023

Maltings Court Brewery
£975 Per Month

charlesrose.



Nestled in the charming town of Stratford-Upon-Avon, this delightful first-floor flat on Brewery Street offers a perfect blend of comfort and convenience. Situated within the esteemed Maltings Court, this private development is just a short stroll from the vibrant town centre, allowing residents to enjoy the rich cultural heritage and amenities that Stratford has to offer.

Upon entering the property, you are welcomed by a spacious entrance hall that leads to a bright and airy lounge. The well-appointed kitchen breakfast room provides a lovely space for culinary pursuits, making it easy to enjoy meals with family and friends. The flat features two generously sized double bedrooms and a bathroom.

One of the standout features of this property is the good-sized garage parking, providing secure and convenient storage for your vehicle. This is a rare find in such a central location, making it an attractive option for those who value both accessibility and peace of mind.

With its prime location, this flat is perfect for anyone looking to immerse themselves in the lively atmosphere of Stratford-Upon-Avon while enjoying the comforts of home.

Available now!
Council Tax - Band D
Sorry no students, no professional sharers
No pets

charlesrose.

- 01926 832411
- hello@charlesrose.co.uk
- charlesrose.co.uk

