

Flat H, 59 Lillington Road, Leamington  
£200,000

charlesrose.

GROUND FLOOR  
555 sq.ft. (51.6 sq.m.) approx.

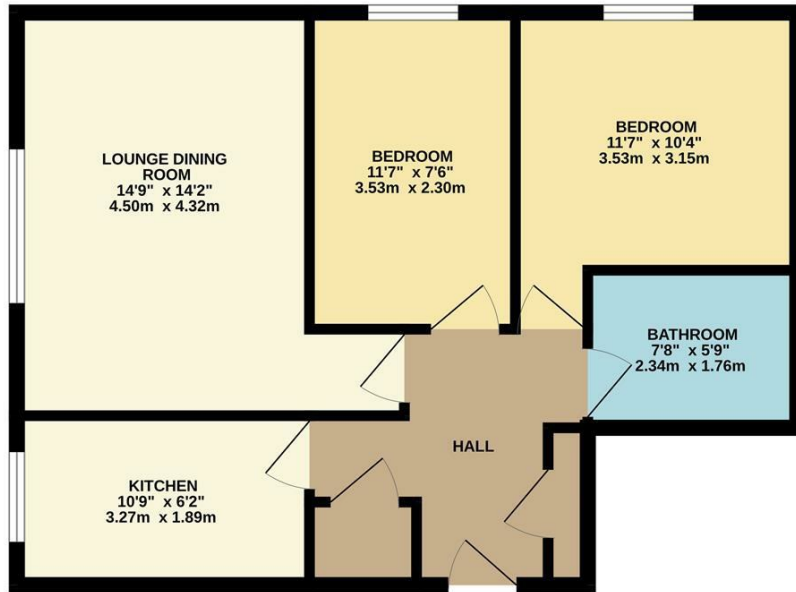

TOTAL FLOOR AREA: 555 sq.ft. (51.6 sq.m.) approx.  
Whilst every attempt has been made to ensure the accuracy of the floorplan contained here, measurements of doors, windows, rooms and any other items are approximate and no responsibility is taken for any error, omission or mis-statement. This plan is for illustrative purposes only and should be used as such by any prospective purchaser. The services, systems and appliances shown have not been tested and no guarantee as to their operability or efficiency can be given.  
Made with Metropix ©2024



A purpose built first floor apartment situated in sought after North Leamington Spa. The accommodation is well presented throughout and comprises of an entrance hall, lounge dining room, kitchen, two bedrooms and a bathroom. The property further benefits from having a garage and is offered for sale with no onward chain.

charlesrose.

- 01926 832411
- info@charlesroseproperties.co.uk
- www.charlesroseproperties.co.uk



